

# KURNOOL MUNICIPAL CORPORATION



---

**DETAILED PROJECT REPORT FOR PROVIDING HOUSING AND  
INFRASTRUCTURE TO CLUSTER OF JOHARAPURAM HARIJANWADA  
C,JOHARAPURAM HARIJANWADA C1 ,JOHARAPURAM HARIJANWADA  
C2-SLUMS IN KURNOOL MUNICIPAL CORPORATION UNDER  
- RAJIV AWAS YOJANA (RAY)**

---

# LOCATION OF ULB - Kurnool Municipal Corporation(KMC)

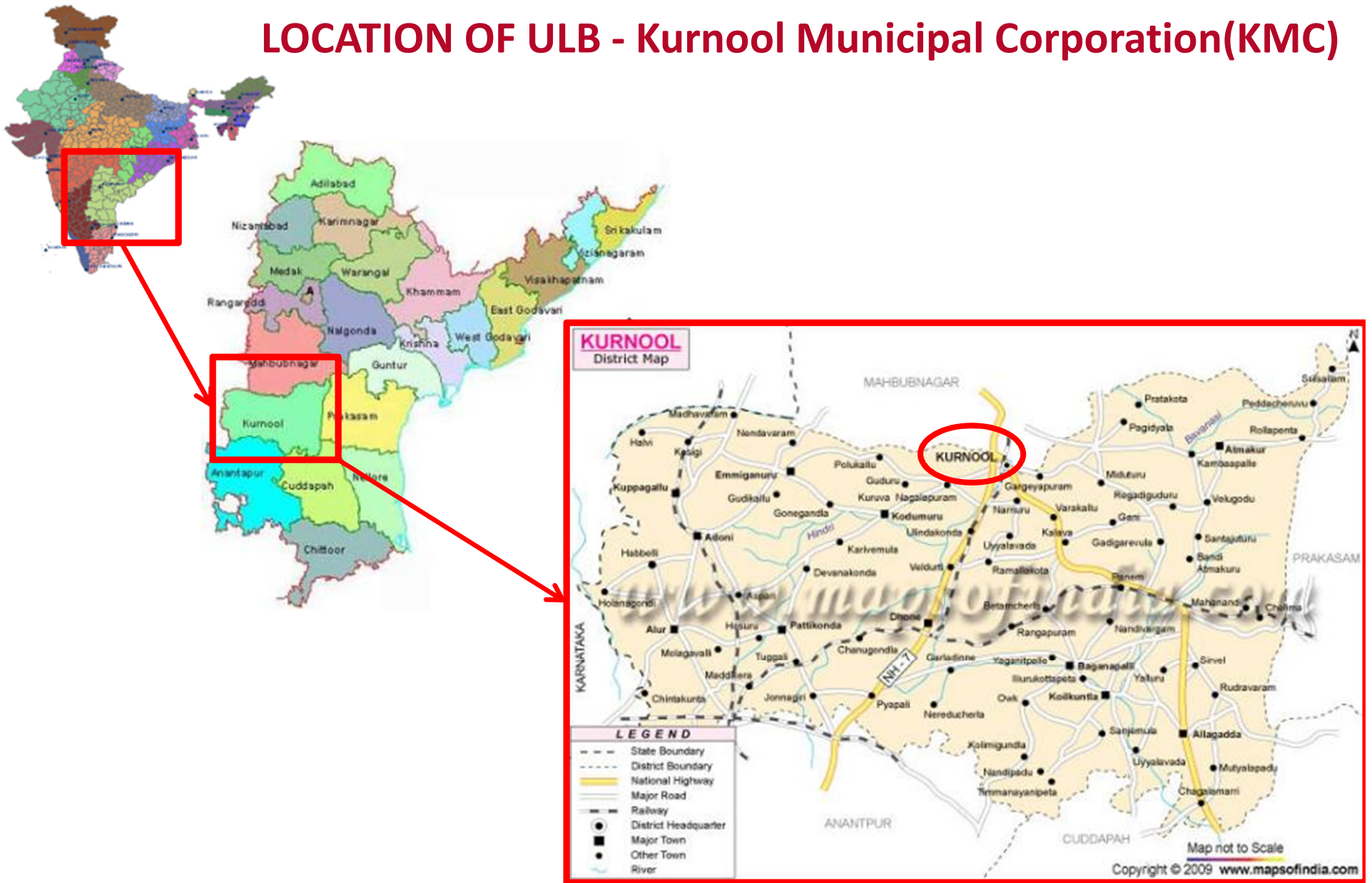

# A Glance of Kurnool Municipal Corporation

| S.No | Name of the Municipal Corporation                                   | Kurnool Municipal Corporation         |
|------|---|---------------------------------------|
| 1    | Year of establishment   | (Upgrade) 1994 & 2002 (Merged Kallur) |
| 2    | Extent (in sq. kms.)  | 49.73 Sq.Kms                          |
| 3    | Population as per 2001 census                                       | 3,42,973                              |
| 4    | Population as per 2011 census                                       | 4,33,829                              |
| 5    | Slum Population as per 2011 census                                  | 1,62,718                              |
| 6    | Projected population as on date (2013)                              | ~ 4,60,000                            |
| 7    | Total Income per annum during 2010-2011<br>(rupees in crores)       | 62.23 Cr                              |
| 8    | Total Expenditure per annum during 2010-<br>2011 (rupees in crores) | 33.60 Cr                              |

# Base Map of Kurnool Municipal Corporation

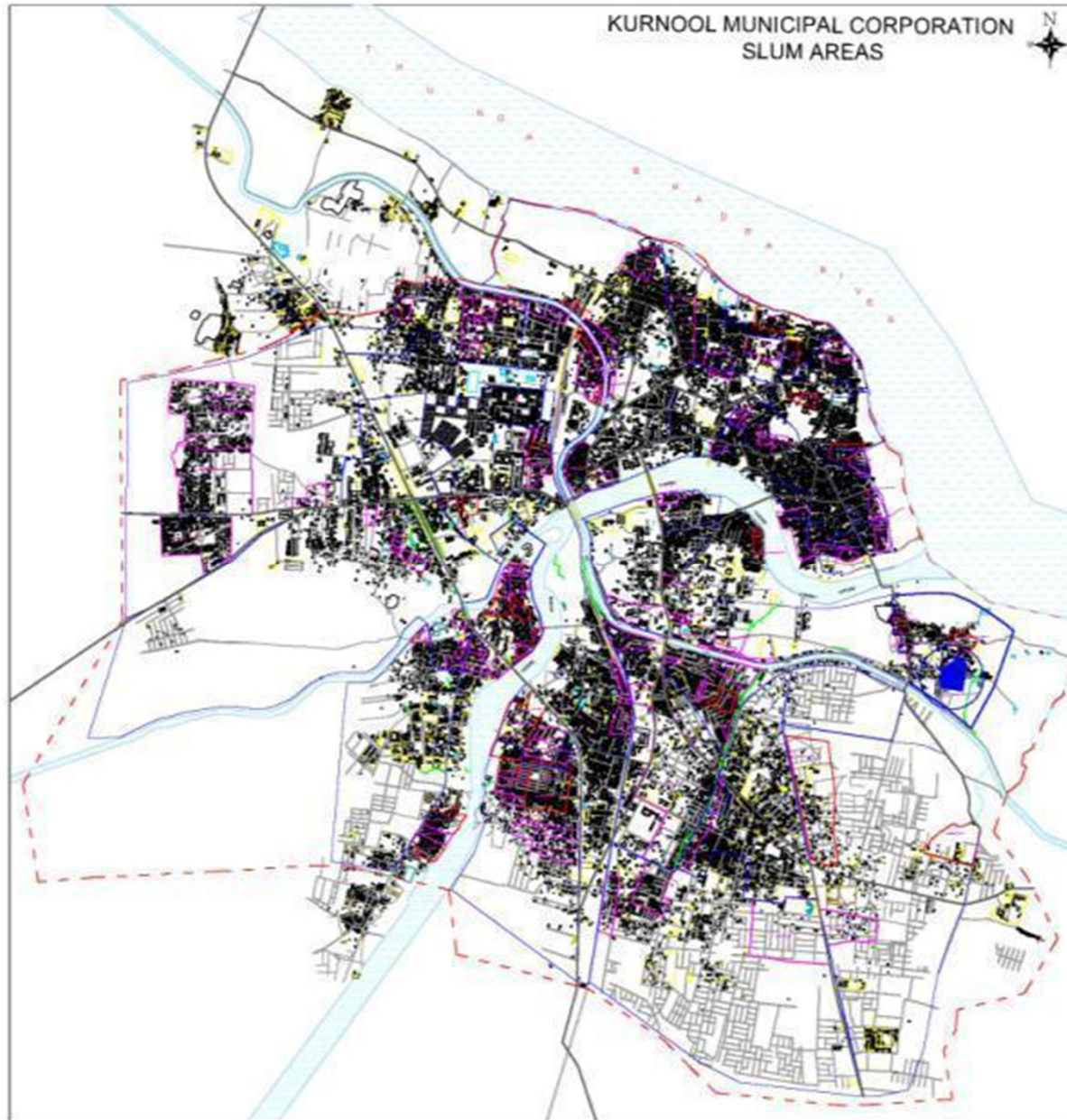

# KMC – Slum Information

|   |                 |
|---|-----------------|
| <b>Total No. of Households in Slums</b>   | <b>41492</b>    |
| <b>Slum Population as per 2011 Census</b> | <b>1,62,718</b> |
| <b>Total No. of Slums</b>                 | <b>106</b>      |
| <b>No. of Notified Slums</b>              | <b>55</b>       |
| <b>No. of Non-Notified Slums</b>          | <b>51</b>       |

# DPR – Pilot Slums

| <b>S.No</b>                             | <b>Slum Name</b>                   | <b>No. of HH</b> | <b>Notified/Non-Notified</b> |
|---|------------------------------------|------------------|------------------------------|
| <b>Joharapuram_Harijanawada Cluster</b> |                                    |                  |                              |
| <b>1</b>                                | <b>Joharapuram_Harijanawada-C</b>  | <b>481</b>       | <b>Notified</b>              |
| <b>2</b>                                | <b>Joharapuram_Harijanawada-C1</b> | <b>68</b>        | <b>Non-Notified</b>          |
| <b>3</b>                                | <b>Joharapuram_Harijanawada-C2</b> | <b>184</b>       | <b>Non-Notified</b>          |
| <b>Total</b>                            |                                    | <b>733</b>       |                              |

# Particulars of Johrapuram Harijanwada - Cluster Slums

|                           |                                |
|---------------------------|--------------------------------|
| <b>Area of slum</b>       | <b>141640 Sq.m or 35 Acres</b> |
| <b>No of Households</b>   | <b>733</b>                     |
| <b>Population</b>         | <b>3151</b>                    |
| <b>Type of structures</b> |                                |
| <b>Semi-pucca</b>         | <b>115</b>                     |
| <b>Kutchha</b>            | <b>63</b>                      |
| <b>Pucca</b>              | <b>555</b>                     |
| <b>Total</b>              | <b>733</b>                     |
| <b>Land use</b>           | <b>Residential</b>             |





# Existing Site Plan - Johrapuram Harijanwada - Cluster Slums

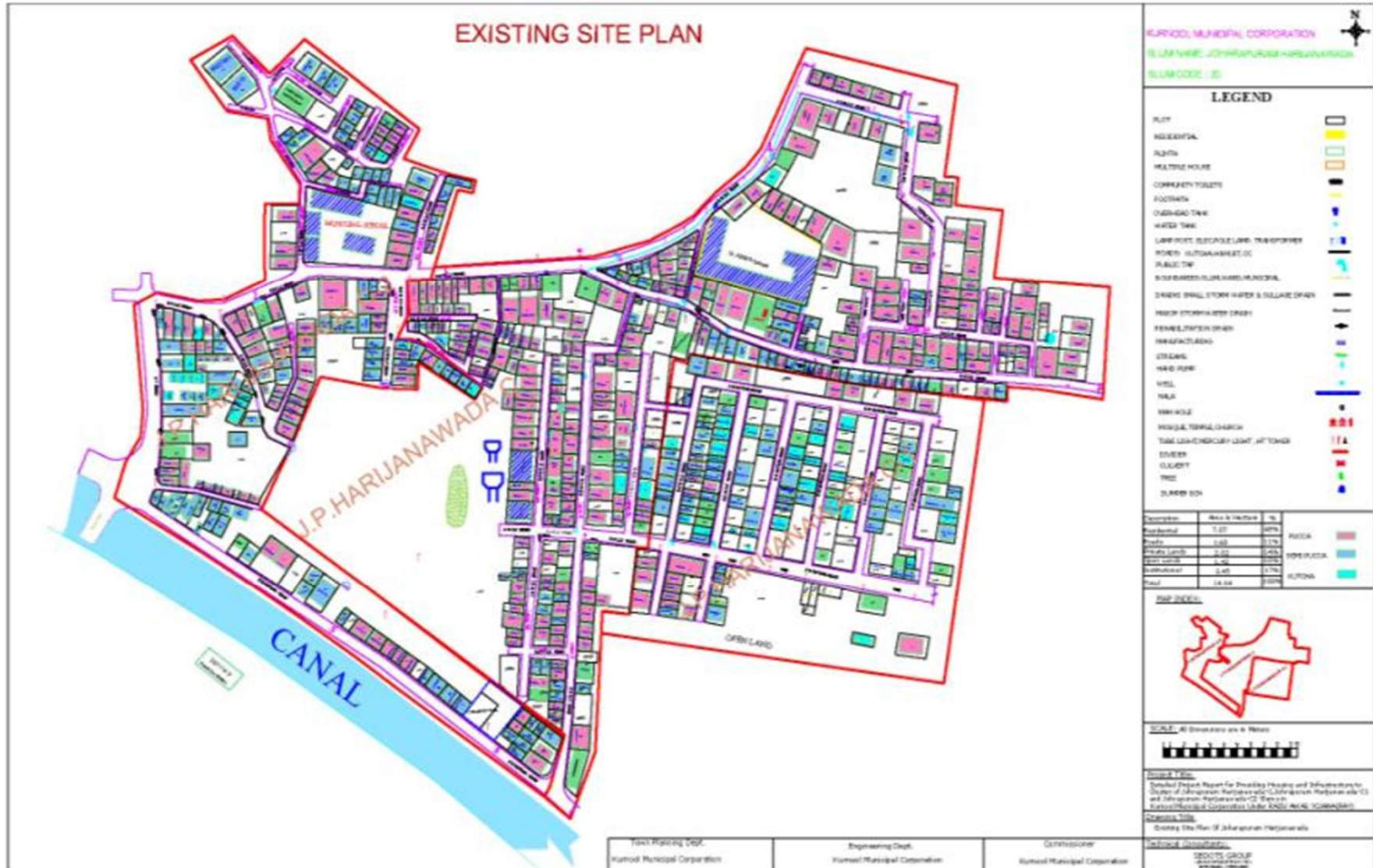

# Johrapuram Harijanwada – Slums Profile - I

| Caste              | J.P.H C    | J.P.H C-1 | J.P.H C-2  | Total      |
|--------------------|------------|-----------|------------|------------|
| General            | 117        | 44        | 61         | 222        |
| OBC                | 48         | 2         | 15         | 65         |
| SC                 | 296        | 20        | 106        | 422        |
| ST                 | 20         | 2         | 2          | 24         |
| <b>Grand Total</b> | <b>481</b> | <b>68</b> | <b>184</b> | <b>733</b> |

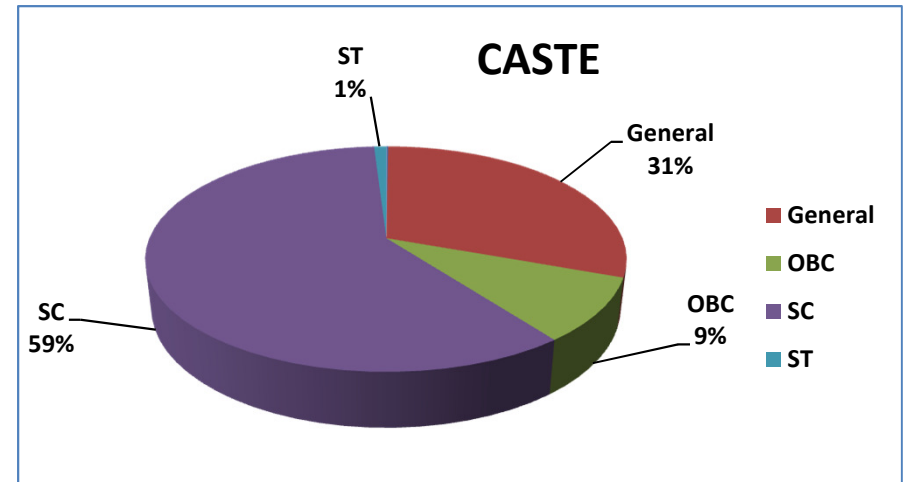

| Type of House      | J.P.H C    | J.P.H C-1 | J.P.H C-2  | Total      |
|--------------------|------------|-----------|------------|------------|
| Katcha             | 10         | 29        | 24         | 63         |
| Pucca              | 456        | 19        | 80         | 555        |
| Semi-pucca         | 25         | 20        | 80         | 115        |
| <b>Grand Total</b> | <b>481</b> | <b>68</b> | <b>184</b> | <b>733</b> |

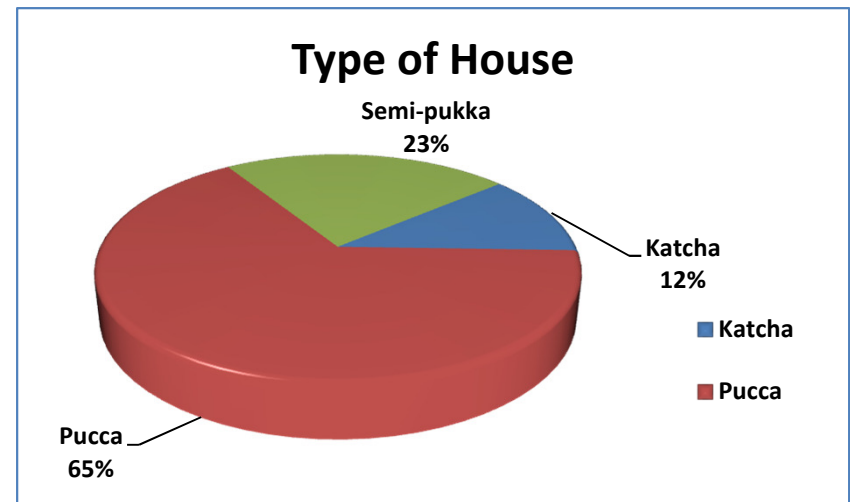

# Johrapuram Harijanwada – Slums Profile - II

| Survey of Drinking Water | HH  | %    |
|--------------------------|-----|------|
| Open well                | 1   | 0%   |
| Tubewell/handpamp        | 491 | 69%  |
| Water Tanker             | 2   | 0%   |
| Within Premises-Tap      | 239 | 31%  |
| Grand Total              | 733 | 100% |

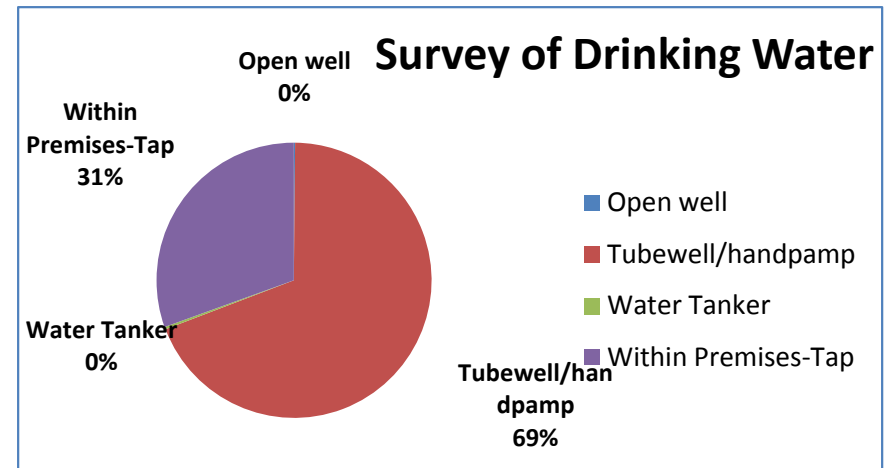

| Land Tenure                            | No.of HH |
|--|----------|
| Private                                | 351      |
| Patta                                  | 277      |
| Possession Certificate/Occupancy Right | 12       |
| Private Land Encroached                | 2        |
| Public Land Enchroched                 | 7        |
| Rented                                 | 84       |
| Grand Total                            | 733      |

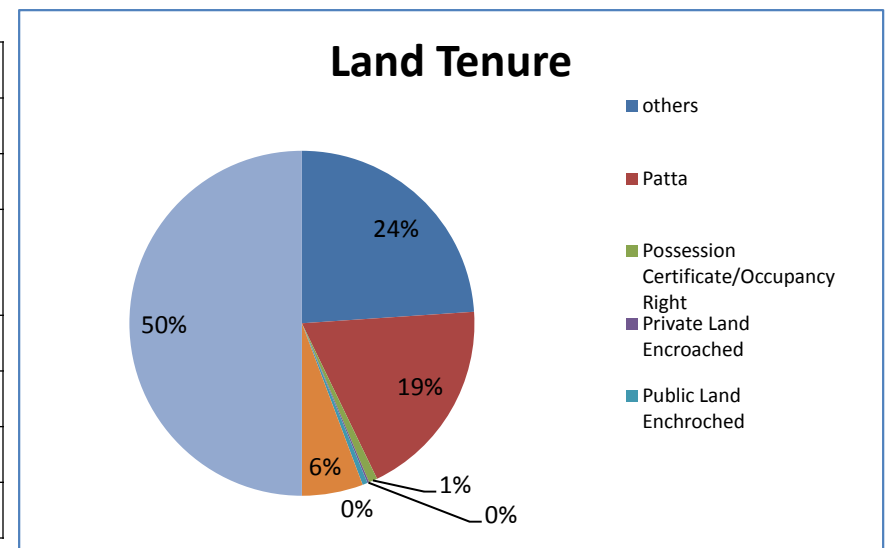

# Photographs Showing Existing Slum Conditions- Johrapuram Harijanwada - Cluster Slums



# COMMUNITY PARTICIPATION- Johrapuram Harijanwada - Cluster Slums

## First level Slum Sabha was Conducted on 12-07-2012

- Introduction of Rajiv Awas Yojana Scheme & its Benefits
- To find out the current status of Physical and social infrastructure, Housing and livelihood needs.



# COMMUNITY PARTICIPATION- Johrapuram Harijanwada

## First level Slum Sabha was Conducted on 23rd May 2013

- Exhibiting the proposed house models and Layouts
- Taking the slum people concerns



# SLUM PLANNING & PROPOSALS - Johrapuram Harijanwada - Cluster Slums

## SLUM DEVELOPMENT STRATEGY ADOPTED :

### - *In situ Development of slums*

- **Provision of Housing**

Provision of Individual dwelling units with in their own plots

- **Provision of Infrastructure**

Provision of Roads, Drainage, Watersupply and Street lighting





# PROPOSED HOUSE MODELS-I

## MODEL-I

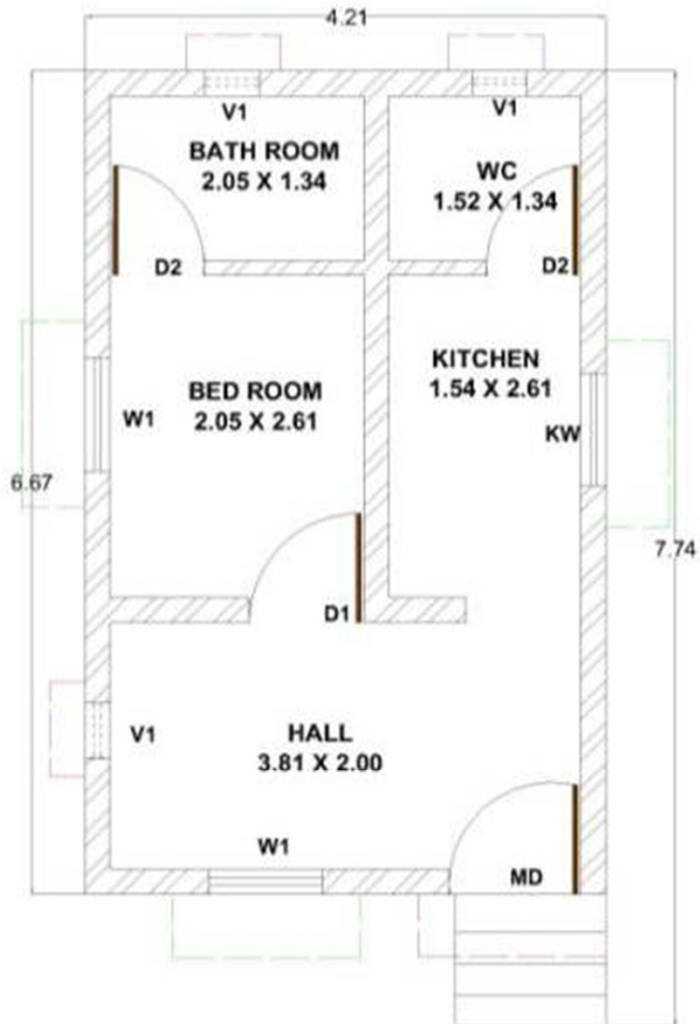

ELEVATION

Plinth Area : 28.08 Sq.m  
Carpet Area : 21.75 Sq.m

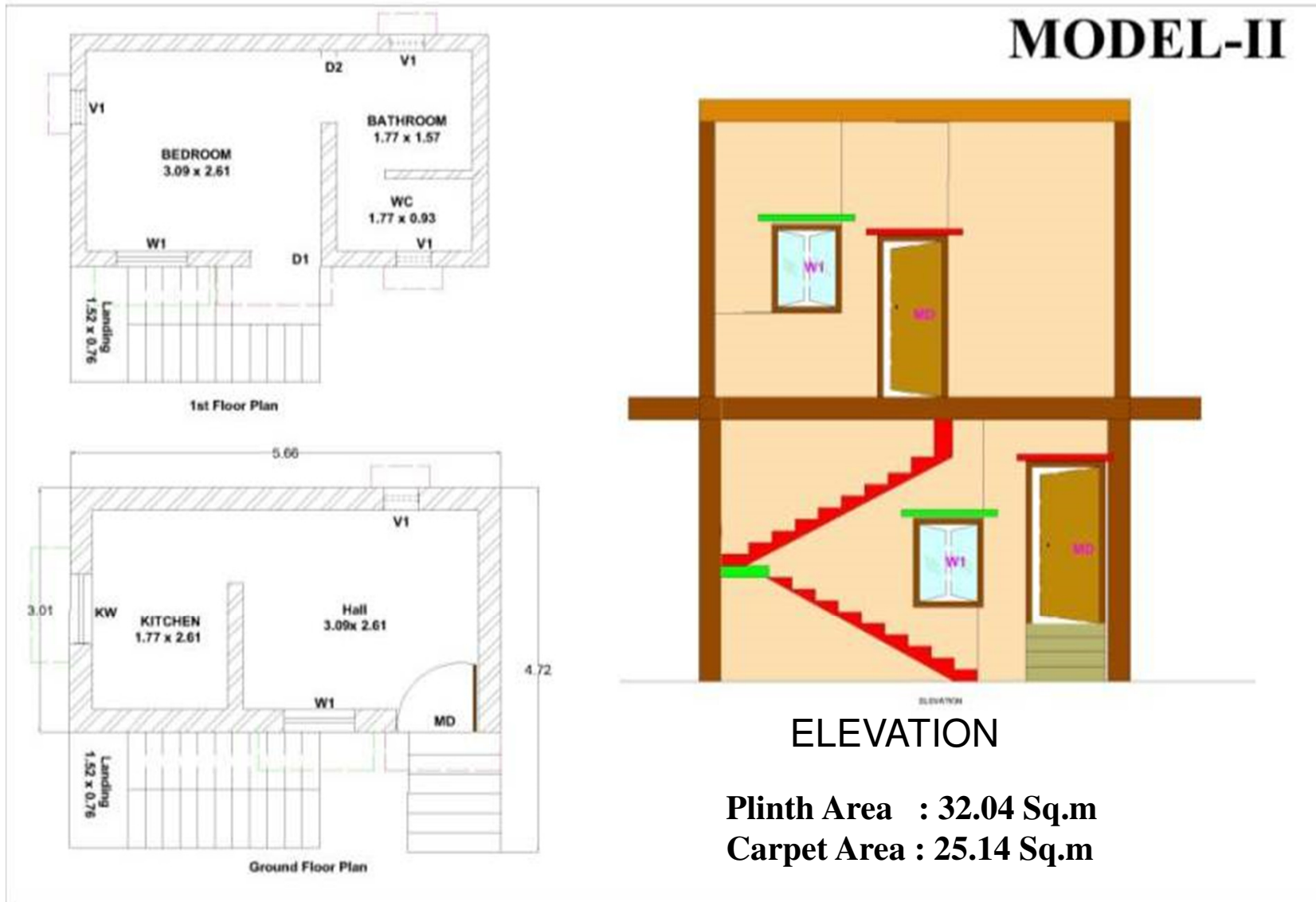

# PROPOSED HOUSE MODEL-II

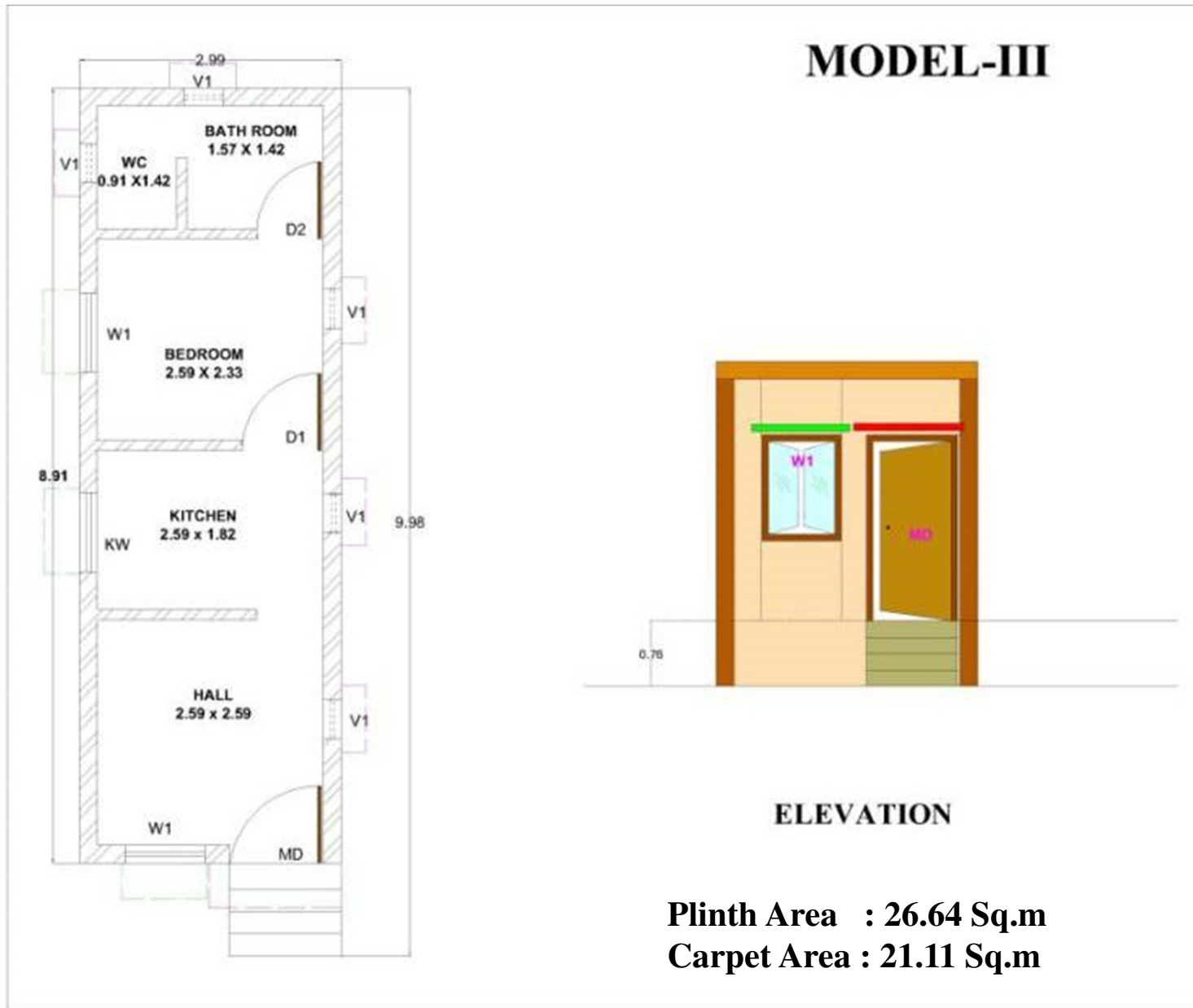

# PROPOSED HOUSE MODEL-III

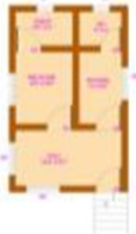

## ESTIMATED COST OF PROPOSED HOUSING MODELS :

| S.No         | Model Name | Model   | Cost (In Lacs.) | No. of Units | Total Cost ( In Lacs) |
|--------------|------------|---|-----------------|--------------|-----------------------|
| 1            | MODEL-I    |    | 3.128           | 30           | 93.84                 |
| 2            | MODEL-II   |   | 3.478           | 29           | 100.86                |
| 3            | MODEL-III  |  | 2.738           | 31           | 84.88                 |
| <b>TOTAL</b> |            |   |                 | <b>90</b>    | <b>279.58</b>         |

# ABSTRACT OF PROJECT COST

| S.No               | Project Component                             | Qty/No    | Unit Cost(in Lakhs) | Amount(in Lakhs) |
|--------------------|---|-----------|---------------------|------------------|
| 1                  | 2   | 3         | 4                   | 5                |
| <b>I</b>           | <b>Housing Components</b>                     |           |                     |                  |
| a                  | Housing                                       |           |                     |                  |
|                    | Type-I  | 30        | 3.128               | 93.84            |
|                    | Type-II(G+1)                                  | 29        | 3.478               | 100.86           |
|                    | Type-III                                      | 31        | 2.738               | 84.88            |
|                    | Sub -Head Total                               | <b>90</b> |                     | <b>279.58</b>    |
| <b>II</b>          | <b>Physical Infrastructure</b>                |           |                     |                  |
| a                  | Roads   |           |                     | 151.84           |
| b                  | Drainage                                      |           |                     | 33.69            |
| b                  | Water Supply                                  |           |                     | 9.14             |
| c                  | Electricity                                   |           |                     | 0.63             |
| d                  | Sewerage(Septic Tanks)                        |           |                     | 18.18            |
|                    | Sub -Head Total                               |           |                     | <b>213.48</b>    |
| <b>III</b>         | <b>Other Items</b>                            |           |                     |                  |
| a                  | DPR Preparation Charges+<br>TPQC Chages @1.5% |           |                     | 7.40             |
| b                  | O & M Charges @4%                             |           |                     | 19.72            |
| c                  | Social Audit @0.5%                            |           |                     | 2.47             |
| d                  | P S& Contagious @ 3%                          |           |                     | 14.79            |
| e                  | Other VAT @5%                                 |           |                     | 16.77            |
| f                  | Others VAT @5%                                |           |                     | 12.81            |
|                    | Sub -Head Total                               |           |                     | <b>73.96</b>     |
| <b>Grand Total</b> |   |           | <b>567.02</b>       |                  |

# FINANCIAL ARRANGEMENT

**DETAILED PROJECT REPORT FOR PROVIDING HOUSING AND INFRASTRUCTURE TO CLUSTER OF JOHARAPURAM HARIJANAWADA C, JOHARAPURAM HARIJANAWADA C-1, JOHARAPURAM HARIJANAWADA C-2 SLUMS IN KURNOOL MUNICIPAL CORPORATION UNDER RAJIV AWAS YOJANA(RAY)**

## SHARING OF FUNDS

| S.No               | Project Component                           | GOI Share (75%) | Go AP Share (15%) | ULB Share (10%) | Beneficiary Share (10%) | Total Amount (100%) |
|--------------------|---|-----------------|-------------------|-----------------|-------------------------|---------------------|
| 1                  | 2   | 3               | 4                 | 5               | 6                       | 7                   |
| I                  | Housing                                     | 196.41          | 53.40             | 0.00            | 29.78                   | 279.58              |
| II                 | Physical Infrastructure                     | 65.47           | 32.02             | 115.99          | 0.00                    | 213.48              |
| III                | Other items                                 |                 |                   |                 |                         |                     |
| a                  | DPR Preparation Charges+ TPQC Charges @1.5% | 0.00            | 3.70              | 3.70            | 0.00                    | 7.40                |
| b                  | O & M Charges @4%                           | 14.79           | 2.96              | 1.97            | 0.00                    | 19.72               |
| c                  | Social Audit @0.5%                          | 0.00            | 0.00              | 2.47            | 0.00                    | 2.47                |
| d                  | P S & Contingencies @ 3%                    | 0.00            | 0.00              | 14.79           | 0.00                    | 14.79               |
| e                  | Others VAT @5%                              | 0.00            | 16.77             | 0.00            | 0.00                    | 16.77               |
| f                  | Others VAT @5%                              | 0.00            | 12.81             | 0.00            | 0.00                    | 12.81               |
| <b>Grand Total</b> |   | <b>276.67</b>   | <b>121.66</b>     | <b>138.92</b>   | <b>29.78</b>            | <b>567.02</b>       |



**THANK YOU**