



प्रधान मंत्री  
आवास योजना-शहरी  
Pradhan Mantri Awas Yojana-Urban

*43<sup>rd</sup> Meeting of the  
Central Sanctioning cum  
Monitoring  
Committee(CSMC)  
under  
Pradhan Mantri Awas  
Yojana - Housing For All*

*25<sup>th</sup> February, 2019*



**Urban Development & Housing Department  
Government of Madhya Pradesh**

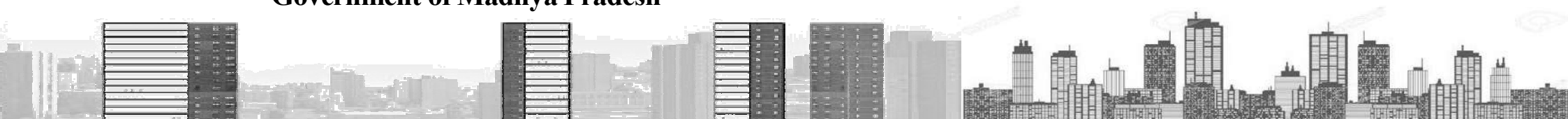

# Madhya Pradesh: Urban Profile

Total Population	7.25 Crore
Total Urban Population	2.01 Crore
Percentage of Urban Population	27.58 %
No. of Urban Local Bodies (ULBs)	378
Municipal Corporations	16
Municipal Councils	98
Nagar Parishads	264

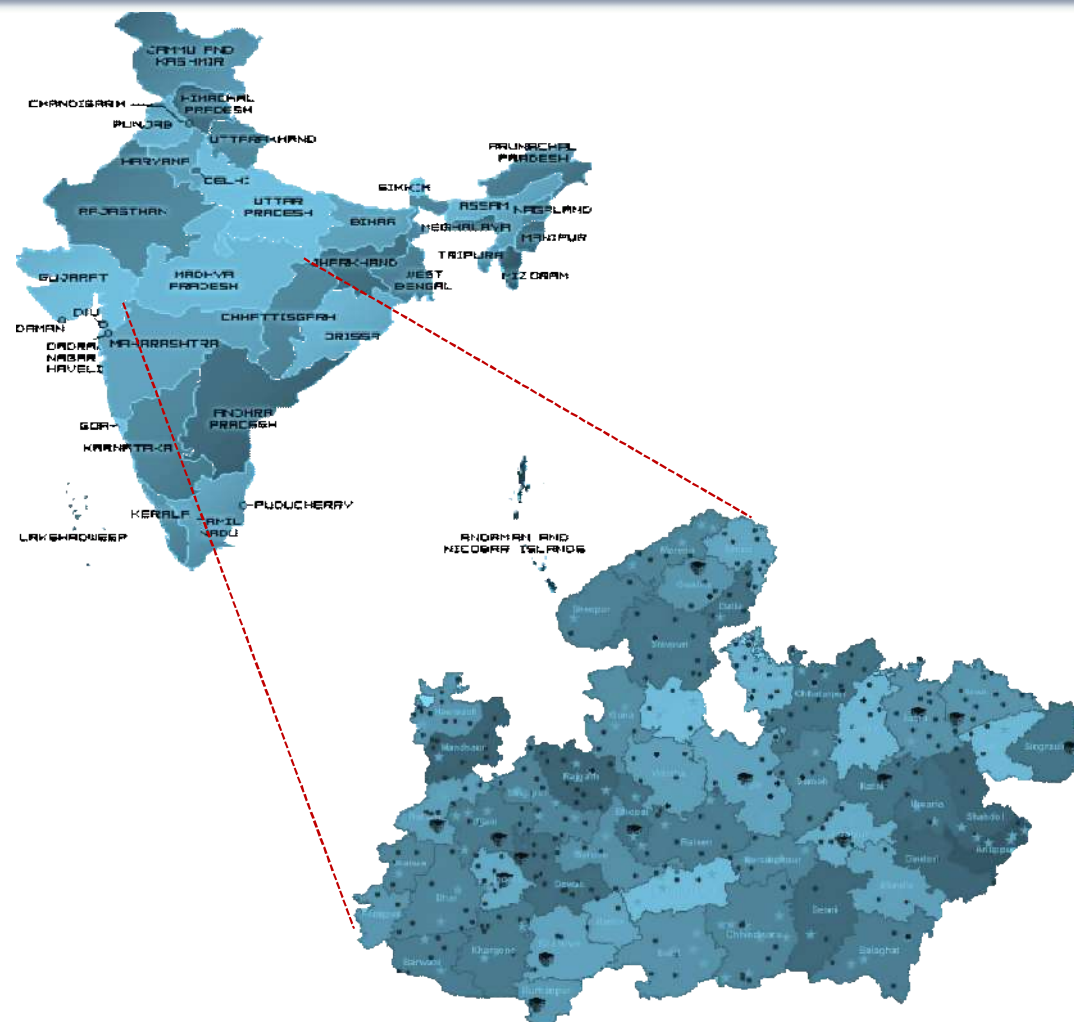

# Housing For All ó Funding Pattern

S. No.	Option	Central Government Initiative	State Government Share	Type of Beneficiary
1	"In-Situ" Slum Redevelopment (ISSR) with participation of private developers using land as a resource	Subsidy of amount of INR 1 lakh	<b>Land will be made available free of cost</b>	EWS
2	Affordable Housing through Credit Linked Subsidy Scheme (CLSS)	Interest Subsidy of upto 6.5/4/3 % on loan upto INR 6/9/12 lakhs for 20 years	-	EWS & LIG / MIG-1 / MIG-2
3	Affordable Housing in Partnership (AHP) with Public & Private sectors	Subsidy of amount of INR 1.5 lakh	<b>Subsidy of amount of INR 1.50 lakh for Slum Dwellers</b>	EWS
4	Subsidy for Beneficiary-Led Individual House Construction (BLC)	Subsidy of amount of INR 1.5 lakh	<b>Subsidy of amount of INR 1 lakh</b>	EWS

# Progress of PMAY(U)

Indicators	Current Status (No.)
▪ Cities Approved	378
▪ Demand Survey Completed	378
▪ Total Demand	11.52 Lakh
▪ Status of Survey Entry	9,66,440 survey data entered by ULBs
▪ Demand received through Common Service Centre and Online Application	4,50,180
▪ Cases accepted/rejected	2,13,262
▪ Whether HFAPoA Submitted	Yes, For all 378 Towns
▪ Whether AIP Submitted	Yes
▪ SLTC/CLTC staffs approved vs. placed	SLTC:10 vs 10 / CLTC: 454 vs 521
▪ Target of DUs in 2018-19	Sanctioning: 2.47 Lakh DUs (2,05,679 EWS approved excluding CLSS. In addition 26,587 under approval in today's meeting of CSMC) Completion: 2.00 Lakh DUs
▪ State Budgetary Provision for PMAY (U) in 2018-19	As per provision of GoI matching budgetary provisions is ensured in state budget

# Interface with MIS

<b>Indicators</b>	<b>Current Status (No.)</b>
▪Projects approved:	1,227
▪Projects entered (7A/B/C/D)	1,212
▪DUs approved under BLC	473,140
▪Beneficiaries attached	3,99,329
▪Beneficiary Attachment Made (%)	84.40%
▪Geo-tagged Points	9,63,961 <i>(No. of Unique Houses Geo-Tagged: 3,13,865)</i>

# Progress of Approved Projects

Verticals	Approved DUs	Tendered	Work Order Issued	Grounded for Construction / In-Progress				Completed
				Foundation / Started	Lintel	Roof	Total	
AHP <i>(EWS Including 8,123 RAY)</i>	2,17,023	1,04,031	1,01,146	51,599	20,248	11,091	82,938	18,208
BLC (N)	4,73,140	-	-	1,11,919	40,924	28,601	1,81,444	1,09,208
ISSR	2,172	960	-	-	-	-	-	-
CLSS <i>(Including LIG/MIG)</i>	21,509	-	-	-	-	-	-	21,509
<b>Total:</b>	<b>7,13,844</b>	<b>1,04,991</b>	<b>1,01,146</b>	<b>1,63,518</b>	<b>61,172</b>	<b>39,692</b>	<b>2,64,382</b>	<b>1,48,925</b>

# Photographs

## Affordable Housing in Partnership (AHP)



## Progress of Approved AHP Projects



Completed DUs in Chhindwara



## Progress of Approved AHP Projects



Completed DUs in Damoh

## Progress of Approved AHP Projects



AHP Project at Sagar

# Progress of Approved AHP Projects

AHP Project at Morena



LIG/MIG DUs of AHP  
Project at Damoh



AHP Project at Chhindwara



AHP Project at Morena

## Progress of Approved AHP Projects



AHP Project at Khargone

# Photographs

## Beneficiary Led Construction (BLC)



# Progress of Approved BLC Projects

Mandsaur



Khurai



Khurai

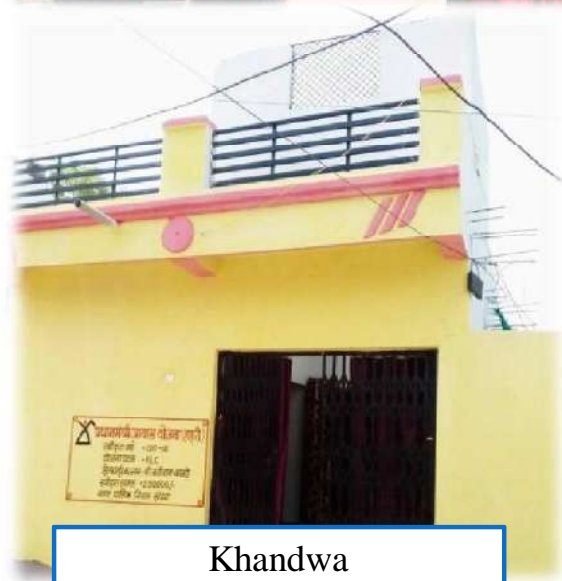

Khandwa



Jaora-Ratlam

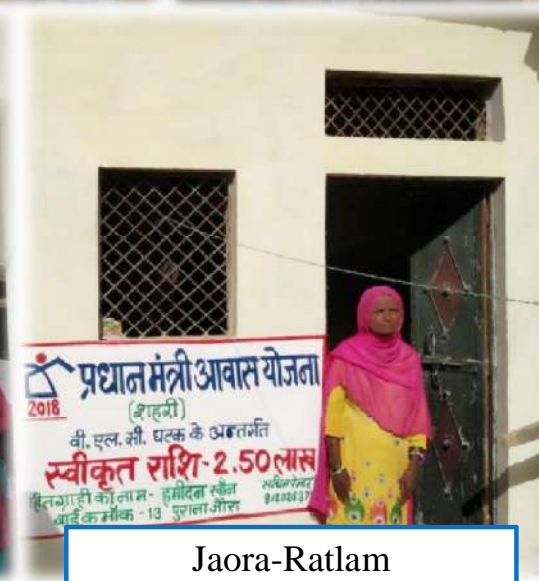

Jaora-Ratlam



Khandwa

# Progress of Approved BLC Projects

Chhatarpur



Shahpur



Shahpur



Shahdol



Sendhwa

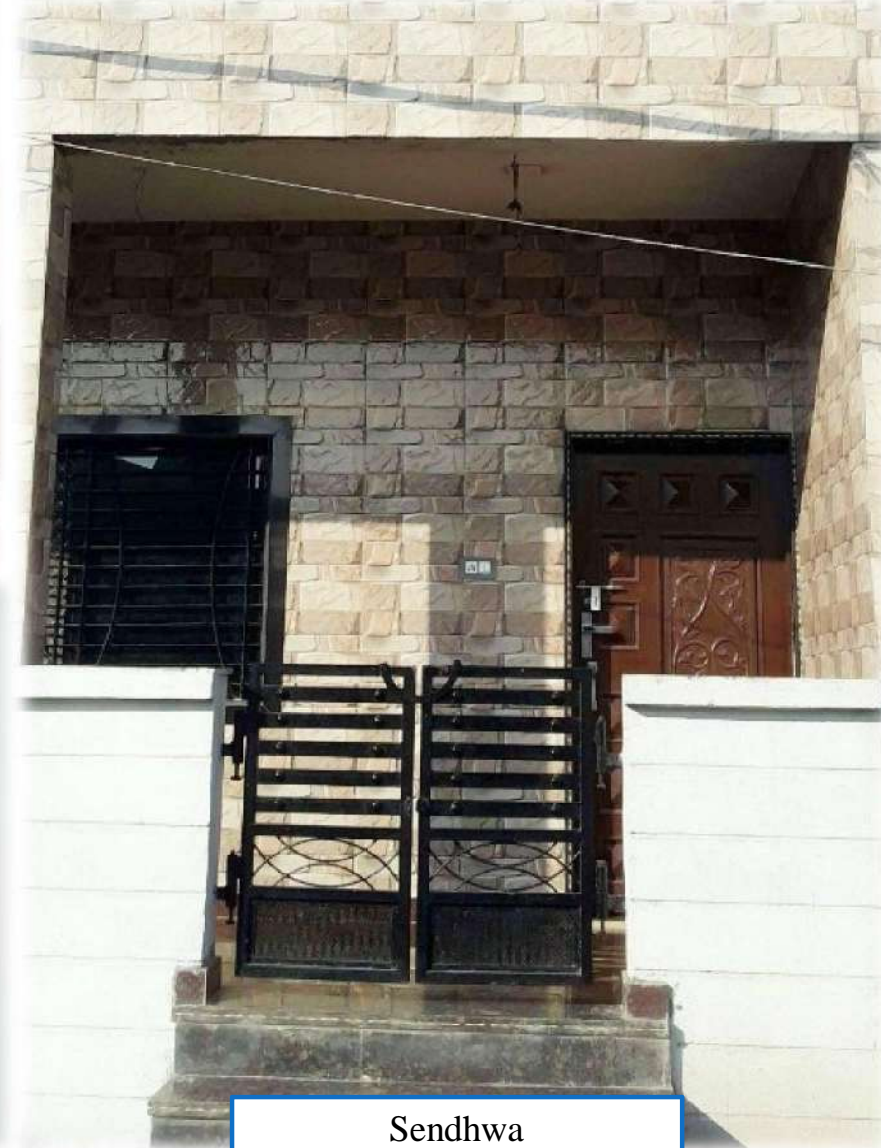

# Progress of Approved BLC Projects

Nasrullaganj



Narsingharh



Rampur-Baghelan



Pandhurna



Mandla



Mandla



Mandla



Mandsaur





# Progress of Approved BLC Projects



Burhanpur



Dewas



Ujjain



Datia



Kakarhati

# Progress of Approved BLC Projects

Shahpur



Sendhwa

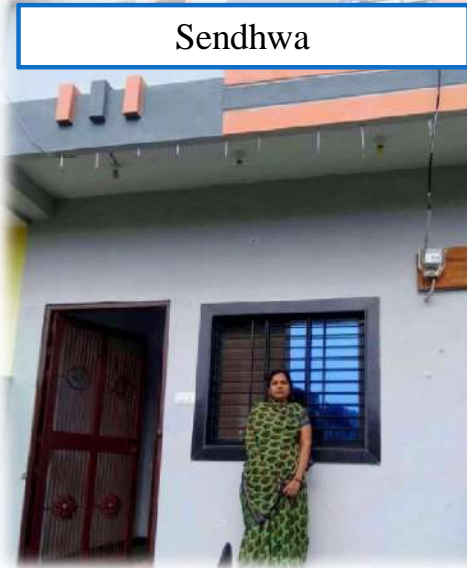

Suwasra



Rewa



Sehore



Tikamgarh-AHP

# Progress of Approved BLC Projects

Gurh



Isagarh



Rehli



Harda



Datia



Hoshangabad



# Progress of Approved BLC Projects



Completed DUs in Alirajpur

# Progress of Approved BLC Projects



Completed BLC DUs in Sendhwa

# Progress of Approved BLC Projects



Multai

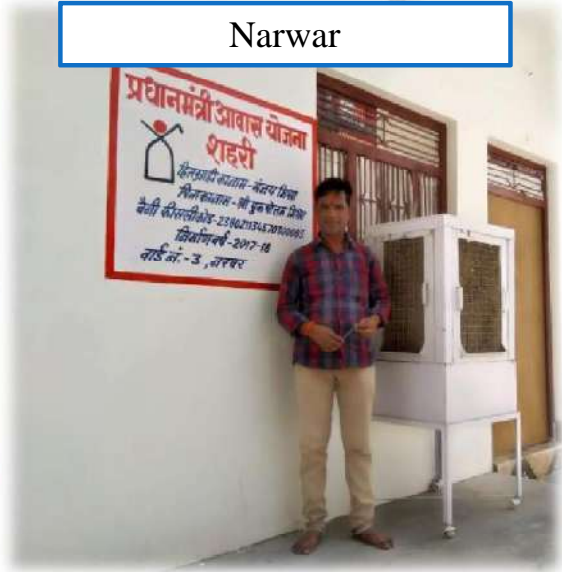

Narwar

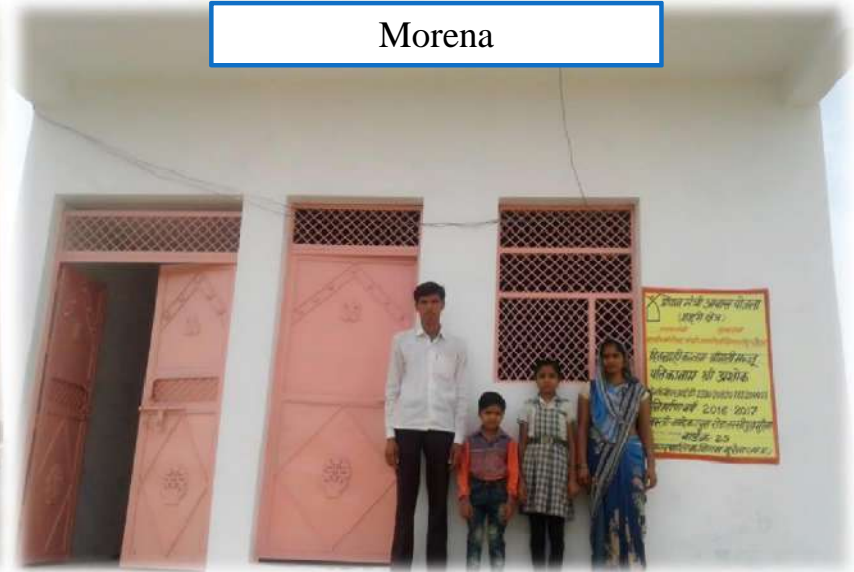

Morena



Narsingharh



Morena

# Progress of Approved BLC Projects



Completed BLC DUs in Ujjain

# Progress of Approved BLC Projects

Mandsaur



Completed BLC DUs in Chhindwara



Hoshangabad





## Progress of Approved BLC Projects



BLC DUs in Barwani

# Progress of Approved BLC Projects

Mandsaur



Completed BLC DUs in Ujjain

# Agenda: 1

## Approval of Detailed Project Reports (DPRs) under BLC Vertical

*Rs. in Crore*

<b>No. of Projects</b>	<b>No. of EWS DUs</b>	<b>Project Cost</b>	<b>Central Share</b>	<b>State Share</b>	<b>ULB Share</b>	<b>EWS Beneficiary Share</b>
47	26,587	1,052.6441	398.805	265.87	2.5121	385.4570

# Project Proposal Brief

(Amount Rs. in Crore)

Verticals	ISSR	AHP	BLC (New)	BLC (E)	Remarks
■ No. of Projects	-	-	47	-	-
■ No. of DUs	-	-	26,587	-	-
■ Project Cost	-	-	1,052.6441	-	-
■ Central Share	-	-	398.805	-	-
■ State Share	-	-	265.87	-	-
■ ULB/ Implementing agency Share	-	-	2.5121	-	-
■ Beneficiary Share	-	-	385.4570	-	-
■ PPP / LIG / MIG / HIG / Commercial	-	-	-	-	-

(Amount Rs. in Lakh)

Verticals	Per Unit Cost	Central Share	State Share	ULB/ Implementing agency Share	Beneficiary Share	Completion Time
■ BLC (N)	3.85	1.50	1.00	For Infrastructure	1.35	12/18 months from the date of work commencement

# Division-Wise Details of DPR under Approval ó BLC

*Amount Rs. In Crore*

S. No.	Name of Division	No. of EWS DUs	Project Cost	Central Share	State Share	ULB Share	EWS Beneficiary Share
1	Bhopal	6,215	239.2582	93.225	62.15	-	83.8832
2	Gwalior	5,441	209.4212	81.615	54.41	-	73.3962
3	Indore	1,569	61.5869	23.535	15.69	-	22.3619
4	Jabalpur	3,781	158.6463	56.715	37.81	0.9215	63.1998
5	Rewa	4,529	174.3453	67.935	45.29	-	61.1203
6	Sagar	972	37.4220	14.580	9.72	-	13.1220
7	Ujjain	4,080	171.9642	61.200	40.80	1.5906	68.3736
<b>Total:</b>		<b>26,587</b>	<b>1,052.6441</b>	<b>398.805</b>	<b>265.87</b>	<b>2.5121</b>	<b>385.4570</b>

# City-Wise Details of DPR under Approval ó BLC (Bhopal Division)

*Rs. in Crore*

S. No.	Name of City	Total No. of DUs	Project Cost	Central Share	State Share	ULB Share	EWS Beneficiary Share	Per DU EWS Share (In Lakh)
1	Bankhedi	691	26.6035	10.365	6.91	-	9.3285	1.35
2	Basoda	1,025	39.4432	15.375	10.25	-	13.8182	1.35
3	Berasia	389	14.9765	5.835	3.89	-	5.2515	1.35
4	Hoshangabad	580	22.3300	8.700	5.80	-	7.8300	1.35
5	Khirkiya	7	0.2695	0.105	0.07	-	0.0945	1.35
6	Kurawar	400	15.4000	6.000	4.00	-	5.4000	1.35
7	Obedullaganj	124	4.7740	1.860	1.24	-	1.6740	1.35
8	Raisen	1,657	63.7945	24.855	16.57	-	22.3695	1.35
9	Seoni-Malwa	46	1.7710	0.690	0.46	-	0.6210	1.35
10	Sohagpur	165	6.3525	2.475	1.65	-	2.2275	1.35
11	Talen	631	24.2935	9.465	6.31	-	8.5185	1.35
12	Chhapiheda	500	19.2500	7.500	5.00	-	6.7500	1.35
<b>Total:</b>		<b>6,215</b>	<b>239.2582</b>	<b>93.225</b>	<b>62.15</b>	-	<b>83.8832</b>	-

# City-Wise Details of DPR under Approval ó BLC (Gwalior Division)

*Rs. in Crore*

S. No.	Name of City	Total No. of DUs	Project Cost	Central Share	State Share	ULB Share	EWS Beneficiary Share	Per DU EWS Share (In Lakh)
1	Bilaua	450	17.3250	6.750	4.50	-	6.0750	1.35
2	Chachaura-Binaganj	105	4.0405	1.575	1.05	-	1.4155	1.35
3	Dabra	1,000	38.4812	15.000	10.00	-	13.4812	1.35
4	Datia	991	38.1348	14.865	9.91	-	13.3598	1.35
5	Kumbhraj	450	17.3250	6.750	4.50	-	6.0750	1.35
6	Pichore	734	28.2590	11.010	7.34	-	9.9090	1.35
7	Raghogarh -Vijaypur	950	36.5571	14.250	9.50	-	12.8071	1.35
8	Seondha	386	14.8611	5.790	3.86	-	5.2111	1.35
9	Sheopur	375	14.4375	5.625	3.75	-	5.0625	1.35
<b>Total:</b>		<b>5,441</b>	<b>209.4212</b>	<b>81.615</b>	<b>54.41</b>	<b>-</b>	<b>73.3962</b>	<b>-</b>

# City-Wise Details of DPR under Approval ó BLC (Indore Division)

*Rs. in Crore*

S. No.	Name of City	Total No. of DUs	Project Cost	Central Share	State Share	ULB Share	EWS Beneficiary Share	Per DU EWS Share (In Lakh)
1	Jhabua	469	18.0477	7.035	4.69	-	6.3227	1.35
2	Pandhana	297	11.4345	4.455	2.97	-	4.0095	1.35
3	Sanawad	803	32.1047	12.045	8.03	-	12.0297	1.50
<b>Total:</b>		<b>1,569</b>	<b>61.5869</b>	<b>23.535</b>	<b>15.69</b>	-	<b>22.3619</b>	-



## City-Wise Details of DPR under Approval ó BLC (Jabalpur Division)

*Rs. in Crore*

S. No.	Name of City	Total No. of DUs	Project Cost	Central Share	State Share	ULB Share	EWS Beneficiary Share	Per DU EWS Share (In Lakh)
1	Bhedaghat	12	0.4620	0.180	0.12	-	0.1620	1.35
2	Chaurai- Khas	33	1.2705	0.495	0.33	-	0.4455	1.35
3	Chhindwara	775	29.8375	11.625	7.75	-	10.4625	1.35
4	Gotegaon	883	33.9955	13.245	8.83	-	11.9205	1.35
5	Katni	2,078	93.0808	31.170	20.78	0.9215	40.2093	1.94
<b>Total:</b>		<b>3,781</b>	<b>158.6463</b>	<b>56.715</b>	<b>37.81</b>	<b>0.9215</b>	<b>63.1998</b>	-

# City-Wise Details of DPR under Approval ó BLC (Rewa Division)

*Rs. in Crore*

S. No.	Name of City	Total No. of DUs	Project Cost	Central Share	State Share	ULB Share	EWS Beneficiary Share	Per DU EWS Share (In Lakh)
1	Amarkantak	12	0.4580	0.180	0.12	-	0.1580	1.32
2	Budhar	373	14.3605	5.595	3.73	-	5.0355	1.35
3	Chakghat	117	4.5045	1.755	1.17	-	1.5795	1.35
4	Dhanpuri	244	9.3894	3.660	2.44	-	3.2894	1.35
5	Gurh	748	28.7980	11.220	7.48	-	10.0980	1.35
6	Kotma	541	20.8285	8.115	5.41	-	7.3035	1.35
7	Majhauri-Sidhi	1,011	38.9235	15.165	10.11	-	13.6485	1.35
8	Mangawan	643	24.7555	9.645	6.43	-	8.6805	1.35
9	Umaria	840	32.3274	12.600	8.40	-	11.3274	1.35
<b>Total:</b>		<b>4,529</b>	<b>174.3453</b>	<b>67.935</b>	<b>45.29</b>	-	<b>61.1203</b>	-

## City-Wise Details of DPR under Approval ó BLC (Sagar Division)

*Rs. in Crore*

S. No.	Name of City	Total No. of DUs	Project Cost	Central Share	State Share	ULB Share	EWS Beneficiary Share	Per DU EWS Share (In Lakh)
1	Bina-Etawa	266	10.2410	3.990	2.66	-	3.5910	1.35
2	Deori	200	7.7000	3.000	2.00	-	2.7000	1.35
3	Garhakota	251	9.6635	3.765	2.51	-	3.3885	1.35
4	Jatara	255	9.8175	3.825	2.55	-	3.4425	1.35
<b>Total:</b>		<b>972</b>	<b>37.4220</b>	<b>14.580</b>	<b>9.72</b>	<b>-</b>	<b>13.1220</b>	<b>-</b>

## City-Wise Details of DPR under Approval ó BLC (Ujjain Division)

*Rs. in Crore*

S. No.	Name of City	Total No. of DUs	Project Cost	Central Share	State Share	ULB Share	EWS Beneficiary Share	Per DU EWS Share (In Lakh)
1	Kanad	323	12.4355	4.845	3.23	-	4.3605	1.35
2	Paankhedi	414	15.9390	6.210	4.14	-	5.5890	1.35
3	Ratlam	2,472	109.9543	37.080	24.72	1.0887	47.0656	1.90
4	Tal	200	7.8019	3.000	2.00	0.5019	2.3000	1.15
5	Hatpipalia	671	25.8335	10.065	6.71	-	9.0585	1.35
<b>Total:</b>		<b>4,080</b>	<b>171.9642</b>	<b>61.200</b>	<b>40.80</b>	<b>1.5906</b>	<b>68.3736</b>	<b>-</b>

## Agenda-2

Proposal of Indore for  
Global Housing Technology Challenge (GHTC)

# GHTC ó Indore

S. No.	Parameters	Details
<b>A.</b>	<b>Applicant Information:</b>	
a)	Name of State / Union Territory	<i>Madhya Pradesh</i>
b)	Name of Representative Agency / Department	<i>Indore Municipal Corporation / Directorate Urban administration &amp; Development, M.P. Bhopal</i>
c)	Name & Designation of Representative Officer along with contact details	<i>D.R. Lodhi Superintendent Engineer Address: 107-109, First Floor Palika Plaza, Indore Mob no: 7440443318 E mail: <a href="mailto:pmayindore@gmail.com">pmayindore@gmail.com</a></i>
<b>B.</b>	<b>Site Information to be filled in/ attached as follows:</b>	
a)	Location of the Site	<i>Site is located 30 Mts wide Master Plan Road, Near Sanghvi Innovative Academy, Kanadia, Taluka Sanyogitaganj, District INDORE</i>
b)	Total area of Site (In Hectares):	<i>4.19 Hec</i>
c)	Indicate maximum Permissible FAR / FSI	<i>1:2</i>

# GHTC ó Indoreí

S. No.	Parameters	Details
d)	Indicate proposed carpet area of one Dwelling Unit in sq m	32.05 Sqm
e)	Indicate distance from site to Town/ City Centre also indicate the same on to the scale Map/(Google Map to be attached)	9.5 km from Railway Station (Annexure I)
f)	Documentary proof of Possession/ Ownership of Land with the Concerned Agency/ Department	Letter of Allotment by District Administration attached (Annexure II)
g)	Is the site connected to Power distribution	a. Yes
h)	Is the site connected with Municipal water supply network?	a. Yes
i)	Is the site connected to Municipal sewerage system?	a. Yes
j)	Is the site connected by Public Transport Facilities?	a. Yes (Annexure III)
k)	Indicate seismic zone of the proposed site	Zone III
l)	Indicate Geo-Climatic Zone of the proposed site	Tropical Savanna Climate (Aw)
m)	Indicate type of soil of the proposed site (Please attach soil test report if available)	0-Rock (Annexure IV)

# GHTC ó Indoreí

S. No.	Parameters	Details
n)	Indicate general topography of the site (Please attach total station survey drawings)	Proposed site Flat land Surrounded by 30 Mt wide road on two sides (Annexure V - Attached)
o)	Indicate present land use of the site as per local Master Plan (Please attach land use plan with site demarcated on it)	Proposed Residential (Annexure VI)
p)	Commitment to facilitate Setting up of factory (for producing building components by way of land provision and other infrastructure support by the state/ UT	Out of 4.19 Hec. of land only 3.00 Hec. of land will be used for construction of proposed units remaining land can be used for setting up of factory.
q)	Attach minutes of meeting of State Level Steering and Monitoring Committee, approving the proposal	Attached



# GHTC ó Indore (Annexure-I ó Distance from City Centre)í

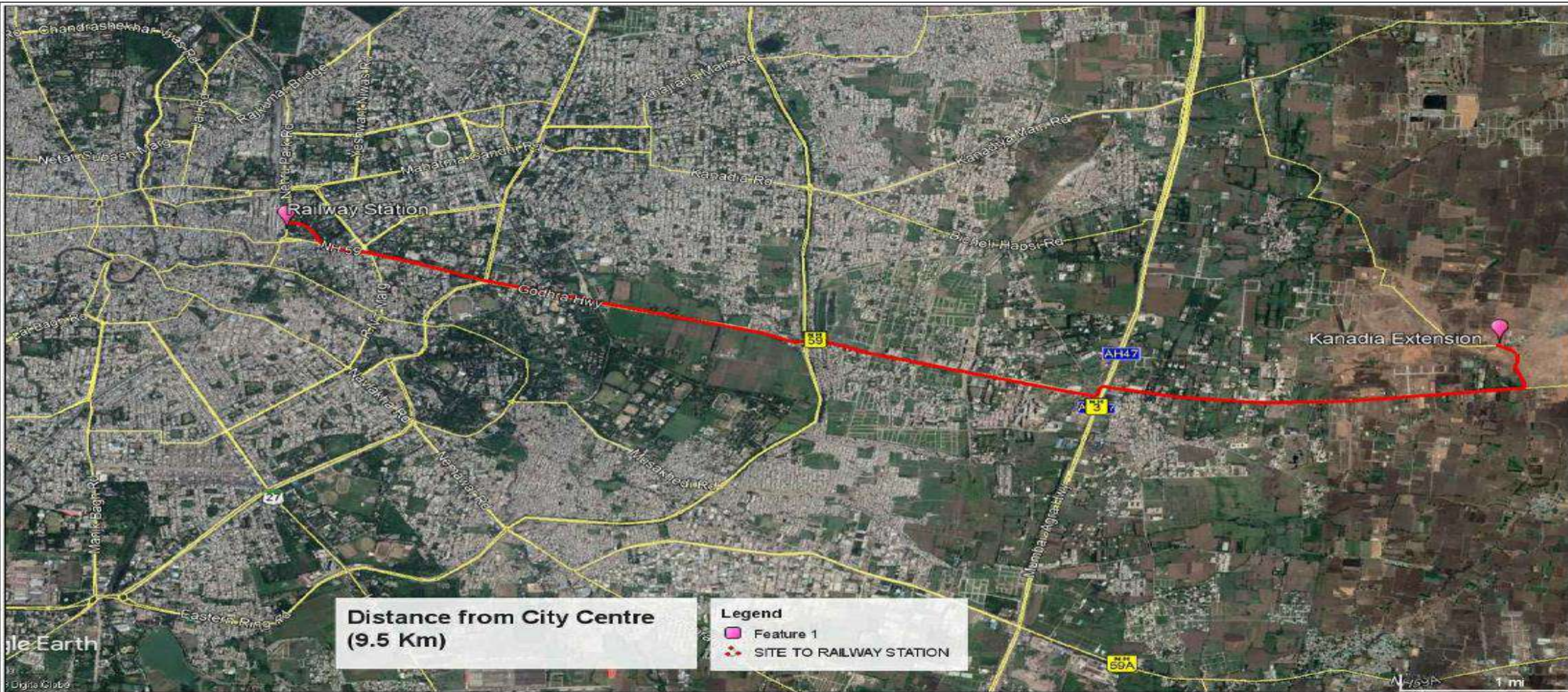

**Distance from City Centre  
(9.5 Km)**

**Legend**  
 ■ Feature 1  
 — SITE TO RAILWAY STATION

<b>SITE ADDRESS:</b>	PMAY SITE , KANADIA EXTENSION
<b>PROJECT:</b>	HOUSING FOR ALL UNDER PRADHAN MANTRI AWAS YOJNA KANADIA EXTENSION , INDORE
<b>CLIENT:</b>	INDORE MUNICIPAL CORPORATION

<b>DRAWING:</b>	DISTANCE FROM CITY CENTRE - 9.5 Km (Annexure I (B-e))		
<b>DATE</b>	-	<b>CHECKED BY</b>	-
<b>SCALE</b>	-	<b>DRAWN BY</b>	-
<b>GRID</b>	-	<b>PROJ. NO</b>	-
		<b>DRG. NO.</b>	

THIS DRAWING AND THE DESIGNS ON WHICH IT IS BASED ARE THE COPYRIGHT AND PROPERTY OF M/s. MEHTA & ASSOCIATES AND THEIR USE IS CONFINED TO THE PROJECT FOR WHICH IT IS PREPARED. NO PART OF THIS DRAWING OR THE DESIGNS THEREON SHALL BE REPRODUCED OR TRANSMITTED IN ANY FORM OR BY ANY MEANS, ELECTRONIC OR MECHANICAL, INCLUDING PHOTOCOPYING, RECORDING, OR BY ANY INFORMATION STORAGE AND RETRIEVAL SYSTEM, WITHOUT THE SPECIFIC WRITTEN PERMISSION OF MEHTA & ASSOCIATES.

**ARCHITECT**

**MEHTA & ASSOCIATES**  
 ARCHITECTS PLANNERS INTERIOR DESIGNERS  
 ENGINEERS AND REGD. VALUERS  
 102, 1st floor, Navneet Plaza, S.G. Old Palasia, Indore-452001  
 Phone : 961134 , 4065064 Fax: (0731) 4065064  
 Email : hndsmehtha.architect@gmail.com

**NORTH**

# GHTC ó Indore (Annexure-II ó Land Allotment)í

उपरोक्तानुसार तहसीलदार एवं अनुविभागीय अधिकारी राजस्व विजय नगर इंदौर के प्रतिवेदन से सहमत होते हुए ग्राम कनाडिया तहसील विजय नगर इंदौर की सर्वे नंबर 885/1/4, 885/5, 885/6, 885/1/3, 878 कुल रकबा 6.660 हेक्टर भूमि भूमि प्रधानमंत्री आवास योजना हेतु नगर नियम को आवास योजना 2022 (स्व के लिये आवास-2022) कियाचयन हेतु इंदौर विकास योजना 2021 अध्याय 6 विकास नियमन की कांडिका 6.3 (6) के तहत बिना प्रब्याजी एवं भू-भाटक के निम्न शर्तों के साथ आबंटित की जाती है :-

- 1- उक्त भूमि का उपयोग हाउसिंग फॉर आल 2022 के प्रयोजन हेतु ही किया जावेगा।
- 2- यदि भविष्य में भूमि का उपयोग उक्त प्रयोजन हेतु नहीं होता है तो भूमि पर निर्मित भवन एवं सम्पत्ति सहित शासन में निहित हो जावेगी तथा आवेदित संस्था को उसका मुआवजा देय नहीं। साथ ही उक्त भूमि पर उपरोक्त प्रयोजनार्थ कार्य 6 माह के अंदर नहीं किया जाता है तो उक्त भूमि पुनः राजस्व विभाग द्वारा ली जा सकेगी एवं आवश्यकता पडने पर किसी अन्य को आबंटित भी की जा सके।
- 3- भूमि के उपयोग या उस पर किसी निर्माण के पूर्व सभी आवश्यक अनुमतियां अनुमोदन एवं अनापत्तियां सम्बंधित स्थानीय संस्थाओं, विभागों ग्राम पंचायत, नगर तथा ग्राम निवेश आदि से ली जाना होगी। मास्टर प्लान व पर्यावरण संरक्षण अधिनियमों का पूर्ण पालन किया जाना होगा।
- 4- शासन के प्रतिनिधि अधिकृत व्यक्ति तथा जिला कलेक्टर या उनके अधिकृत प्रतिनिधियों राजस्व विभाग के अधिकारियों को भूमि के सही उपयोग तथा शर्तों के पालन का निरीक्षण करने के लिये कभी भी भूमि तथा उस पर निर्मित परिसर के निरीक्षण का अधिकार होगा।
- 5- प्रश्नागत भूमि से सम्बंधित कोई वाद न्यायालय में विचाराधीन हो तो ऐसी स्थिति में न्यायालय द्वारा पारित आदेश का पालन संस्था को करना होगा।  
उपरोक्त शर्तों के उल्लंघन की स्थिति में यह आदेश स्वमेव निरस्त माना जावेगा।

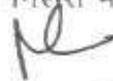
  
कलेक्टर,  
जिला इन्दौर

# GHTC ó Indore (Annexure-III ó Route of Public Transport)í



SITE ADDRESS: PMAJ SITE , KANADIA EXTENSION		DRAWING: SPROPOSED TRUNK TOUTE SR-9 (Annexure III (B-J))			<small>THIS DRAWING AND THE DESIGN ON WHICH IT IS BASED ARE THE COPYRIGHT AND PROPERTY OF M/S. MEHTA &amp; ASSOCIATES AND THEIR USE IS RESTRICTED BY THE LICENSING AGREEMENT NOT TO REPRODUCE OR TO USE FOR ANY OTHER PURPOSE WHOLLY OR IN PART ANY DETAILS THEREIN WITHOUT THE SPECIFIC WRITTEN PERMISSION OF MEHTA AND ASSOCIATES</small>		
PROJECT: HOUSING FOR ALL UNDER PRADHAN MANTRI AWAS YOJNA KANADIA EXTENSION , INDORE	DATE	-	CHECKED BY	-	DRG. NO.	ARCHITECT	
CLIENT: INDORE MUNICIPAL CORPORATION	SCALE	-	DRAWN BY	-		<b>MEHTA &amp; ASSOCIATES</b> ARCHITECTS PLANNERS INTERIOR DESIGNERS ENGINEERS AND REGD. VALUERS 102, 1st floor, Navneet Plaza, S-2, Old Palasia, Indore-482001 Phone : 911124 4065054 Fax: (0731) 4065054 Email : hlandmehta.architect@gmail.com	NORTH 
	GRID	-	PROJ. NO	-			

# GHTC ó Indore (Annexure-IV ó Soil Test Report)í

**INDEX** LAB & CONSULTANTS

B-11, Navlakha Complex, Agrasen Square, Indore (M.P.) 452 001, India

Ph. : +91-731-4080977, Cell : +91-98935-66736, E-mail : index@indexlabindia.com

## Test Report

ILC / TC / 2712/18-19

Format: F-5.10/T  
23<sup>rd</sup> Nov'2018

Report No. : ILC / TC / 2712/18-19  
Contractor Reference : M/s Highway Infrastructure  
Client Reference : Municipal Corporation Indore  
Consultant Reference : Mehta Associates  
Date of Receiving : 20<sup>th</sup> Nov'2018  
Date of Testing : 20<sup>th</sup> Nov'2018  
Period of Testing : 7 Days  
Lab Sample Code : ILC / TS / 2712/18-19  
Project : Construction of Houses and Development of Infrastructure for  
Slum Localities in Indore M.P. Under PMAY at Kanadia Near  
Impetus I.T. Park.  
Sample : Bore No.2  
Letter Reference : Dated 1<sup>st</sup> Nov'2018

# GHTC ó Indore (Annexure-V ó General Topography)í

**SURVEY PLAN FOR  
P.M.A.Y. LAND AT VILLAGE-KANADIYA, DIST - INDORE (M.P.)**



LEGENDS		
ELECTRIC TOWER	□	
TREE	●	
ELECTRIC LINE	—	
6' EDGE	—	
RASTA	—	
FENCING LINE	—	
CD	—	
SITE ADDRESS: P.M.A.Y. SITE, KANADIYA EXTENSION		
PROJECT: HOUSING FOR ALL UNDER PRADHAN MANTRI AWAS YOJNA KANADIYA EXTENSION, INDORE		
CLIENT: INDORE MUNICIPAL CORPORATION		
DRAWING: SURVEY PLAN		
DATE	CHECKED BY	DRE NO.
SCALE	DRAWN BY	
SPIC	PROJECT NO.	

<p>THE ARCHITECTS ASSOCIATION, INDIA IS THE REGISTERED ASSOCIATION OF ARCHITECTS IN INDIA. MEHTA &amp; ASSOCIATES ARCHITECTS AND ENGINEERS IS A MEMBER OF THE ASSOCIATION OF ARCHITECTS OF INDIA (A.A.I.) AND IS REGISTERED WITH THE ARCHITECTS ACT, 1947 AND THE ARCHITECTS ACT, 1950. MEHTA &amp; ASSOCIATES ARCHITECTS AND ENGINEERS IS A MEMBER OF THE ARCHITECTS ACT, 1947 AND THE ARCHITECTS ACT, 1950.</p>	
ARCHITECT	INSTITUTION

<p><b>MEHTA &amp; ASSOCIATES</b> ARCHITECTS PLANNERS INTERIORS DESIGNERS ENGINEERS AND RECC. VALUERS 102, 1st Floor, New Market, Indore, Madhya Pradesh Phone: 2510148588 Fax: 2510485854 Email: info@mehtaandassociates.com</p>	
--	--

# GHTC ó Indore (Annexure-VI Land-Use)í



<b>SITE ADDRESS:</b> PIMAY SITE, KANADIA EXTENSION			
<b>PROJECT:</b> HOUSING FOR ALL UNDER PRADHAN MANTRI AWAAS YOJANA KANADIA EXTENSION, INDORE			
<b>CLIENT:</b> INDORE MUNICIPAL CORPORATION			
<b>DRAWING:</b> SITE BOUNDARY OVERLAY ON LANDUSE - 2021 (ANNEXURE-6)			
<b>DATE</b>	<b>CHECKED BY</b>	<b>MD</b>	<b>DRG. NO.</b>
	<b>DRAWN BY</b>		
<b>SCALE</b>			
<b>GRD.</b>		<b>PROJ. NO.</b>	
<p><small>THIS DRAWING AND THE DESIGN ON IT ARE THE PROPERTY OF MEHTA &amp; ASSOCIATES AND THEIR USE IS CONDITIONAL UPON THE USER'S AGREEMENT NOT TO REPRODUCE OR TO USE FOR ANY OTHER PURPOSE WITHOUT OUR WRITTEN PERMISSION. ALL RIGHTS RESERVED. WRITTEN PERMISSION OF MEHTA &amp; ASSOCIATES IS REQUIRED FOR ANY PART OR ALL THEREOF WITHOUT THE SPECIFIC WRITTEN PERMISSION OF MEHTA &amp; ASSOCIATES.</small></p>			
<b>ARCHITECT</b>			<b>NORTH</b>
<p><b>MEHTA &amp; ASSOCIATES</b>          ARCHITECTS, PLANNERS, INTERIOR DESIGNERS,          ENGINEERS AND VESD. VALUERS          102, 1st Floor, Naraveli Plaza, 802, OMF Plaza, Indore-462001          Phone: 981104 452504 Fax: 0731 452504          Email: <a href="mailto:info@mehtaandassociates@gmail.com">info@mehtaandassociates@gmail.com</a></p>			

# GHTC ó Indore (Area Statement)í

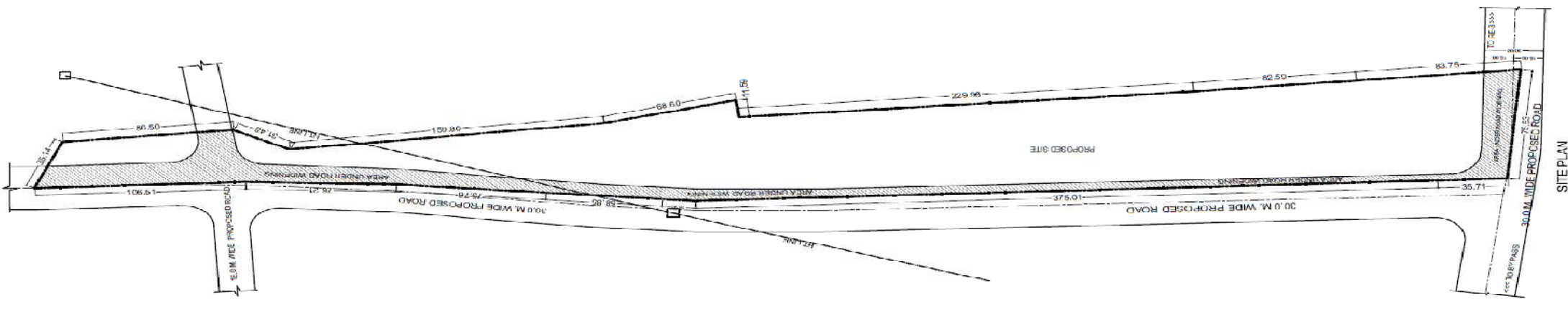

OWNER		AREA 1 HECT.
1	OWN. LAND 385/0	2.428
2	OWN. LAND 371	1.754
<b>TOTAL AREA</b>		<b>4.182 HECT.</b>

AREA STATEMENT	
TOTAL LAND AREA	= 4.182 HECT.
AREA UNDER ROAD/ADJACENT	= 4136.20 SQ. M.
NET PLANNING AREA	= 784.00 SQ. M.
	= 34276.00 SQ. M.

**SITE ADDRESS:** PMAY SITE, KANMADA EXTENSION  
**PROJECT:** HOUSING FOR ALL UNDER PRADHAN MANTRI AWAS YOJNA  
 KANMADA EXTENSION, INDORE  
**CLIENT:** INDORE MUNICIPAL CORPORATION

DRAWING: SITE PLAN	
DATE	CHECKED BY
SCALE	DESIGNED BY
GRID	PROJ. NO.
	DRG. NO.

**ARCHITECT:** MEHTA & ASSOCIATES  
 ARCHITECTS PLANNERS INTERIOR DESIGNERS  
 ENGINEERS AND PESTO JULIERS  
 10, Station Number Road, 471 001 Indore, Madhya Pradesh  
 Phone: 91-791-2531111 Fax: 91-791-2531111  
 Email: info@mehtaandassociates.com

**MEHTA & ASSOCIATES**  
 ARCHITECTS PLANNERS INTERIOR DESIGNERS  
 ENGINEERS AND PESTO JULIERS  
 10, Station Number Road, 471 001 Indore, Madhya Pradesh  
 Phone: 91-791-2531111 Fax: 91-791-2531111  
 Email: info@mehtaandassociates.com

**Thank You...**