

**Presentation of Rajasthan State  
for  
Sanction by  
Central Sanctioning & Monitoring  
Committee Under Housing for All**



**Dated: 26<sup>th</sup> March, 2018**

**Local Self Government Department  
Government of Rajasthan**

**RUDSICO**



**CMJAY- 2015**

# PMAY (U) – Rajasthan

## PMAY (U)

Vertical	No. of Projects	ACA Released (Rs in Cr)	Houses Sanctioned (Nos.)	Houses Grounded (Nos.)	Houses Completed
AHP	43	92.29	26,231	11,656	3696
BLC	01	1.08	180	180	-
ISSR	-	-	-	-	-
<b>Total</b> (44 Projects)		<b>93.37</b>	<b>26,411</b>	<b>11,836</b>	<b>3696</b>

## RAY

Houses Sanctioned	Completed	Under Progress	Non Started	UCs Pending
21,908	12,761	5,880	3,267	Rs 86.33 Cr

## CLSS

Category	Beneficiaries	Loan Subsidy (Rs in Cr)
EWS / LIG	2,791	41.67
MIG	495	9.76
<b>Total</b>	<b>3,286</b>	<b>51.43</b>

**Total Housing Demand: about 06.34 lakh**

Demand Status (incl. CLSS)

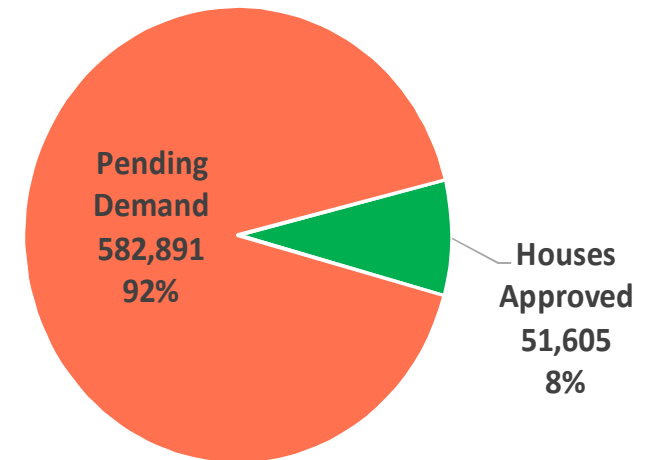

**(PMAY 26,411, RAY 21,908, CLSS 3,286)**

## Progress (HFA PoA & AIP)

Indicators	Current Status
No. of Cities Approved	183
No. of Cities where demand survey completed	157
Timeline for completion of demand survey in remaining cities/towns if any	Aug. 2018
Total demand assessed	3.14 Lakh
No. of HFAPoA & AIP prepared/submitted	32
Time for submission of HFAPoA & AIP for all approved cities/towns	Sep.2018
Total targets of DUs in 2018-19	1,55,000
Budgetary provision of fund in 2018-19	250 Cr.

## List of AHP Projects Submitted for approval

S.N.	Name of Project	EWS units	LIG units	Total units
1.	Affordable Housing Project at Khetri by Municipal Board Khetri, District-JHUNJHUNU	416	224	640
2.	Affordable Housing Project at SPZ Yojna, Bharatpur by UIT Bharatpur.	208	96	304
3.	Affordable Housing Projects at Pannadhaya Nagar, UIT Udaipur.	448	128	576
4.	Affordable Housing Project at Bundi by Municipal Council Bundi	720	384	1104
5.	Affordable Housing Project at Parth Apartment Housing Scheme Deoli Arab, by UIT Kota.	216	80	296
6.	Affordable Hosuing Project at Raipura Housing Scheme, UIT Kota.	288	112	400





## Regarding projects under AHP Vertical proposed by ULBs

S.N.	Name of Project	Total Land Area (In Hect.)	Project Cost (In Lakh)	EWS units	LIG units	Total units
7.	Chhoti Sadri	1.00	998.40	288	0	288
8.	Rawatbhata	4.45	5428.80	752	416	1168
9.	Chhabra	4.00	5186.40	536	516	1052
10.	Baran	2.53	3062.40	416	240	656
11.	Bhinmal	2.81	3480.00	400	320	720
12.	Dausa	1.19	1060.80	272	0	272
13.	Jobner	3.00	3182.40	496	208	704
14.	Kekari	2.50	3096.00	400	256	656
15.	Sarwar	2.25	2649.60	384	192	576
16.	Tijara	1.77	2162.40	296	168	464
17.	Abu Road	2.50	3096.00	400	256	656



## Regarding projects under AHP Vertical proposed by UITs.

S.N.	Name of Project	Total Land Area (in Hect.)	Project Cost (In Lakh)	EWS units	LIG units	Total units
.	Projects By UITs					
18.	Bikaner, UIT Bikaner	3.17	8315.00	608	456	1064
19.	Sawai Madhopur, UIT Sawai Madhopur	2.08	2195.62	368	192	560



## Regarding projects under AHP Vertical proposed by JDA

S.N.	Name of Project	Total Land Area (in Hect.)	Project Cost (In Lakh)	EWS units	LIG units	Total units
20.	Anand Vihar Scheme, GH-5 & GH-6	1.23	1413.00	250	73	323
21	Anand Vihar Scheme, GH-1 & GH-2	1.03	1053.00	270	0	270
22.	Shaurya Nagar Scheme, GH-1 ,GH-2 & GH-3	1.78	2264.000	256	211	467
23.	Shaurya Nagar Scheme, GH-4 & GH-5	1.02	1045.20	268	0	268
24.	Surya Nagar , A-2 to A-6	1.08	1076.40	276	0	276



S.N.	Name of Project	Total Land Area (in Hect.)	Project Cost (In Lakh)	EWS units	LIG units	Total units
25.	Surya Nagar , A-9 to A-14	1.08	1076.40	276	0	276
26.	Abhinav Nagar , GH-1 & GH-2	1.03	1060.80	272	0	272
27.	Abhinav Nagar , GH-3 & GH-4	1.03	1060.80	272	0	272
28.	Kheda Jaganathpura Institute Scheme, GH-1	1.45	1761.00	250	131	381





## Regarding projects under AHP Vertical proposed by RHB

S.N.	Name of Project	Total Land Area (in Hect.)	Project Cost (In Lakh)	EWS units	LIG units	Total units
29.	Pratap Nagar, Jaipur (G+8)	5.00	5974.42	1008	0	1008
30.	Barli, Jodhpur(G+3)	10.00	6080.26	1120	0	1120
31.	Aravali Vihar, Bhiwadi(G+8)	2.3	2508.41	432	0	432
32	Shanjapur, Bhiwadi (G+3)	2.3	5472.22	1008	0	1008
33.	Mahala, Jaipur	4.2	2961.37	528	0	528



S.N.	Name of Project	Total Land Area (in Hect.)	Project Cost (In Lakh)	EWS units	LIG units	Total units
34.	Vatika , Jaipur (G+8)	14.42	7817.47	1440	0	1440
35.	Plot-B, VT Road, Mansarovar, Jaipur (G+8)	0.68	863.56	144	0	144
36.	Sector-16, Mansarovar, Jaipur (G+8)	1.00	863.56	144	0	144
37.	Aravali Marg, J-1, Mansarovar, Jaipur (G+8)	1.5	1727.15	288	0	288
	<b>Total</b>	<b>85.38</b>	<b>140396</b>	<b>16808</b>	<b>4396</b>	<b>21204</b>

### Super Built up area/price

Min 350.00 sq.ft.(EWS) @ 1320/- Rs. 4.62 Lac

Min 500.00 sq. ft.(LIG) @1320/- Rs. 6.60 lac



## Housing For All Plan of Action (HFAPoA) Completed.

S.N.	Name of City	Validated demand				
		ISSR	AHP	CLSS	BLC	Total
1	Bhilwara	0	4716	1862	1688	8266
2	Nathdwara	0	715	0	647	1362
3	Alwar	0	11201	2	3665	14868
4	Pratapgarh	0	1160	27	479	1666
5	Chittorgarh	0	2835	376	1172	4383
6	Pushkar	0	473	22	543	1038
7	Beawer	0	2752	71	1250	4073
8	Bhiwadi	0	149	103	1807	2059
9	Nagaur	0	1376	622	4214	6212
10	Sujangarh	0	640	571	6146	7357
11	Tonk	0	3065	2505	6428	11998
12	Udaipur	0	9397	461	747	10605
13	Sardarshahar	0	671	576	5963	7210
14	Bikaner	0	4470	4712	5436	14618
15	Makrana	0	2716	2029	1043	5788



S.N.	Name of City	Validated demand				
		ISSR	AHP	CLSS	BLC	Total
16	Churu	0	502	3325	382	4209
17	Bharatpur	0	4852	3797	2593	11242
18	Gangapur	0	4615	76	6	4697
19	Hindaun City	0	5866	76	13	5955
20	Bundi	0	9855	129	165	10149
21	Rajsamand	0	1149	323	8	1480
22	Jhalawar & Jhalrapatan	0	2606	1594	33	4233
23	Bhusawar	0	912	0	0	912
24	Deeg	0	1219	0	81	1300
25	Kumher	0	920	0	19	939
26	Kama	426	709	0	0	1135
27	Nagar	0	1282	0	0	1282
28	Nadwai	145	785	30	255	1215
29	Rajakhera	0	1350	0	0	1350
30	Bandikui	0	1095	0	0	1095
31	Lalsot	0	764	0	40	804
32	Dungarpur	304	96	0	2	402
	<b>TOTAL</b>	<b>875</b>	<b>84913</b>	<b>23289</b>	<b>44825</b>	<b>153902</b>



# Project - 1 : Affordable Housing Project at - Khetri, Jhunjhunu.

- Location - Khetri Town
- Implementing Agency - Nagar Palika, Khetri.
- Total Land Area - 2.56 Hac. (Govt. Land)
- No of Units - EWS - 416 units  
LIG - 224 units  
Total - 640 units
- Supper Built up area / price - 325.70 Sqft. (EWS) @ 1200/- Rs. 3.90 Lacs.  
- 500.55 Sqft. (LIG) @ 1200/- Rs. 6.00 Lacs.

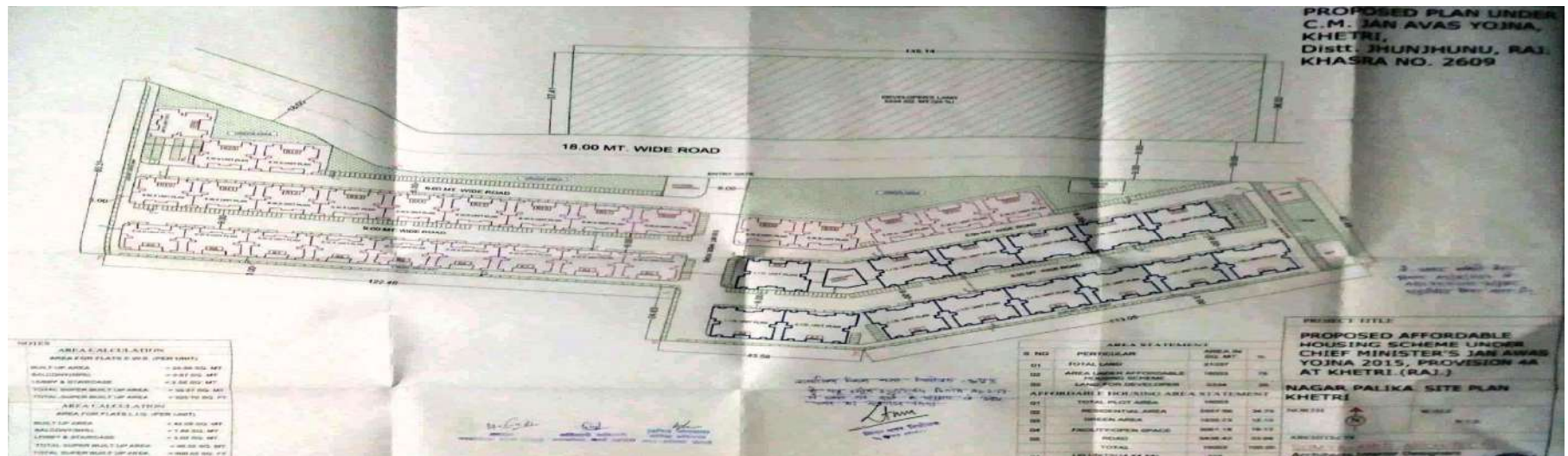



# Project - 2 : Affordable Housing Project at Bharatpur.

- Location - SPZ Yojana, Bharatpur.
- Implementing Agency - UIT Bharatpur.
- Total Land Area - 1.208 Hac. (Govt. Land)
- No of Units - EWS - 208 units  
LIG - 96 units  
Total - 304 units
- Supper Built up area / price - 356.50 Sqft. (EWS) @ 1200/- Rs. 4.27 Lacs.  
- 565.21 Sqft. (LIG) @ 1200/- Rs. 6.78 Lacs.

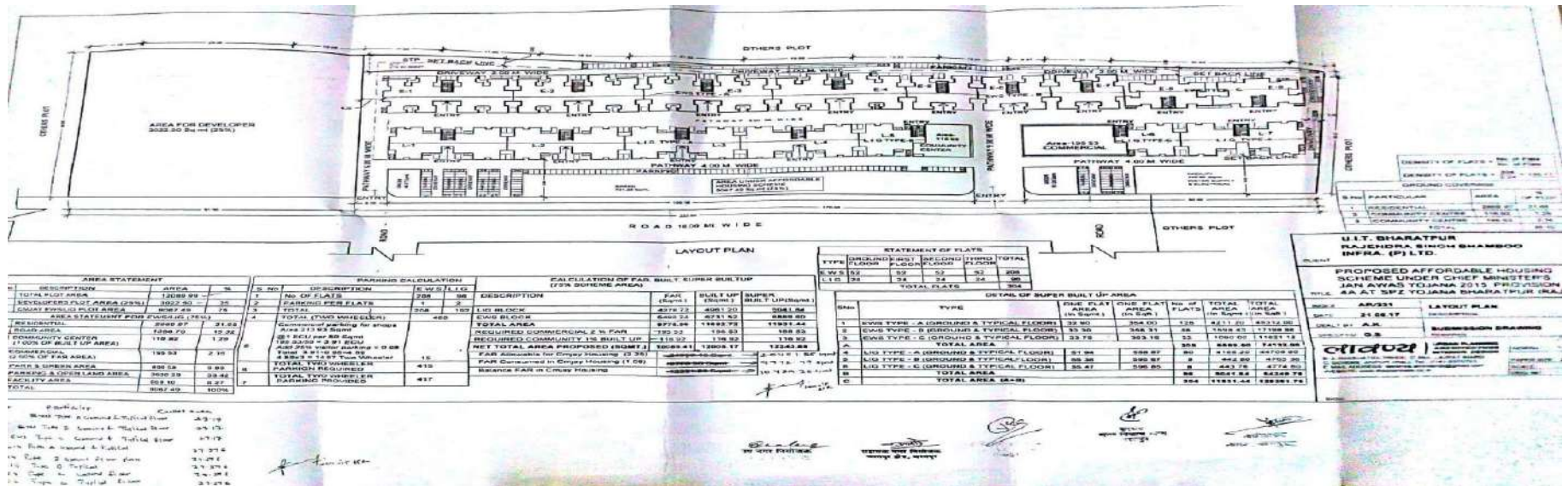



# Project - 3 : Affordable Housing Project at Udaipur.

- ” Location - Pannadhaya Nagar (Udaipur).
- ” Implementing Agency - UIT Udaipur.
- ” Total Land Area - 2.00 Hac. (Govt. Land)
- ” No of Units - EWS - 448 units  
LIG - 128 units  
Total - 576 units
- ” Supper Built up area / price - 350.65 Sqft. (EWS) @ 1200/- Rs. 3.90 Lacs.  
- 518.09 Sqft. (LIG) @ 1200/- Rs. 6.21 Lacs.

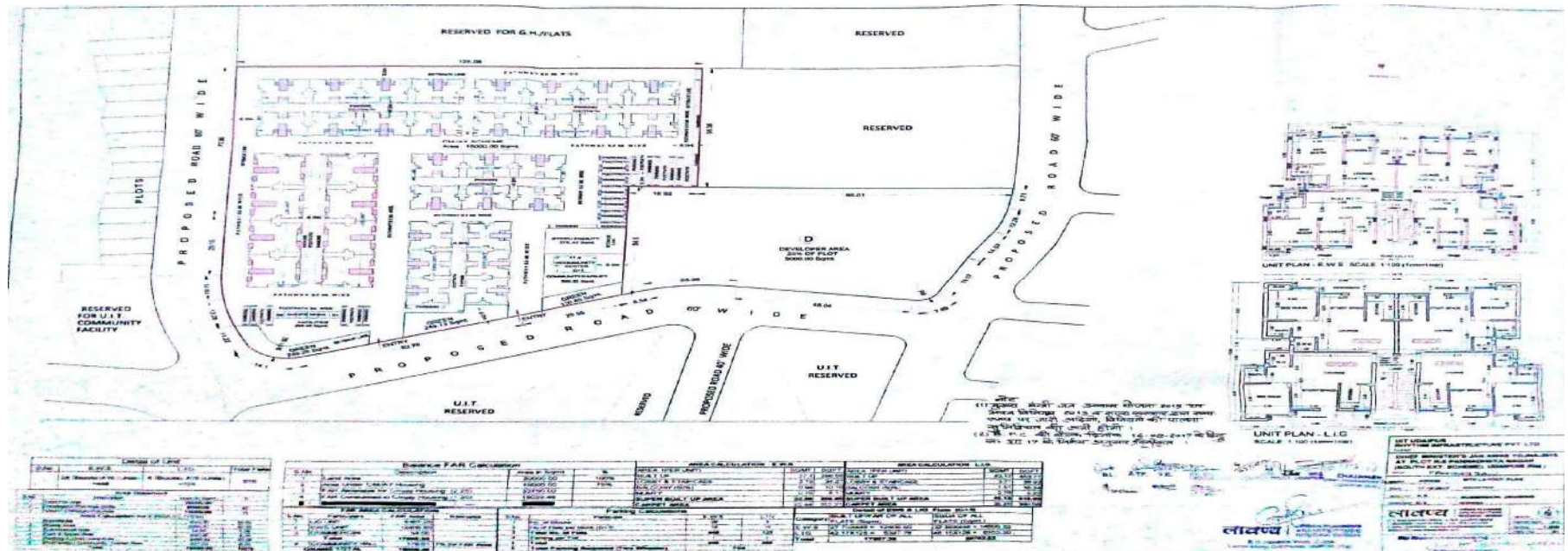



# Project - 4 : Affordable Housing Project at Bundi.

- Location - Bundi.
- Implementing Agency - Nagar Parishad Bundi.
- Total Land Area - 4.23 Hac. (Govt. Land)
- No of Units - EWS - 720 units  
LIG - 384 units  
Total - 1104 units
- Supper Built up area / price - 346.00 Sqft. (EWS) @ 1200/- Rs. 4.15 Lacs.  
- 545.00 Sqft. (LIG) @ 1200/- Rs. 6.54 Lacs.

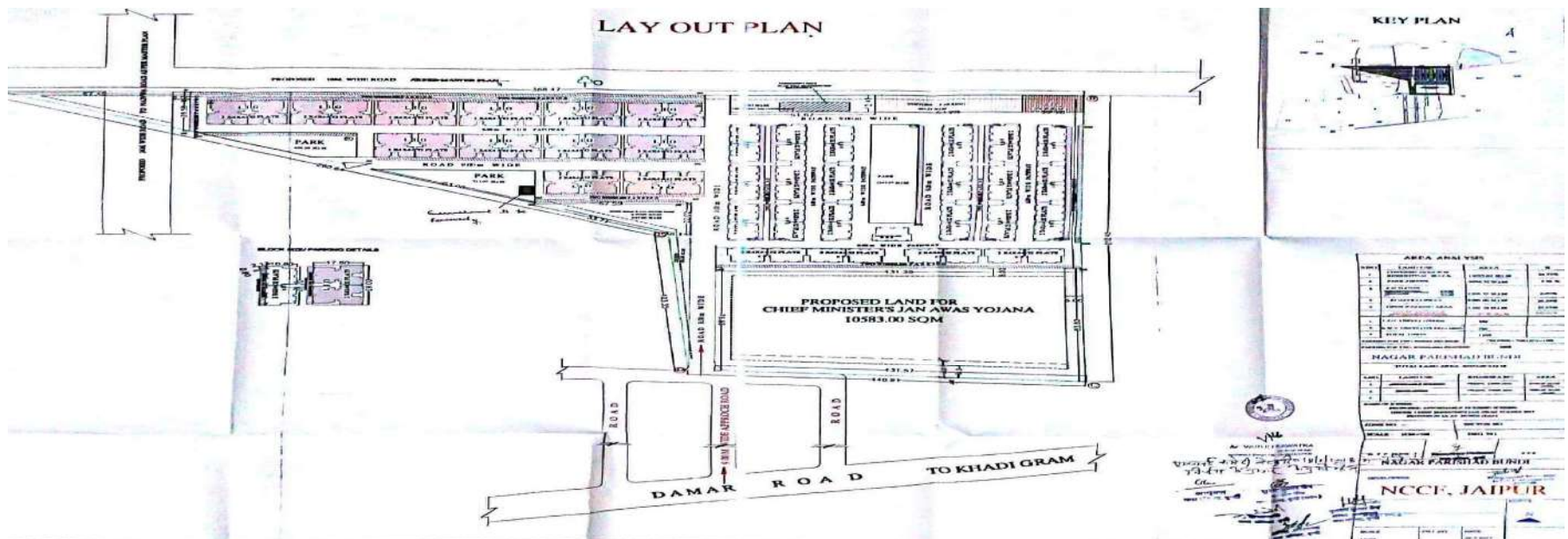





# Project - 5: Affordable Housing Project at Deoli Arab, Kota.

- “ Location – Deoli, Arab, (Kota).
- “ Implementing Agency – UIT Kota.
- “ Total Land Area – 2.04 Hac. (Govt. Land)
- “ No of Units – EWS – 216 units  
LIG – 80 units  
Total – 296 units
- “ Supper Built up area / price – 346.45 Sqft. (EWS) @ 1200/- Rs. 4.15 Lacs.  
– 510.83 Sqft. (LIG) @ 1200/- Rs. 6.12 Lacs.





# Project - 6 : Affordable Housing Project at Kota.

- " Location - Raipura Housing Scheme, (Kota).
- " Implementing Agency - UIT Kota.
- " Total Land Area - 1.44 Hac. (Govt. Land)
- " No of Units - EWS - 288 units  
 LIG - 122 units  
 Total - 400 units
- " Supper Built up area / price - 348.05 Sqft. (EWS) @ 1200/- Rs. 4.17 Lacs.  
 - 509.22 Sqft. (LIG) @ 1200/- Rs. 6.11 Lacs.

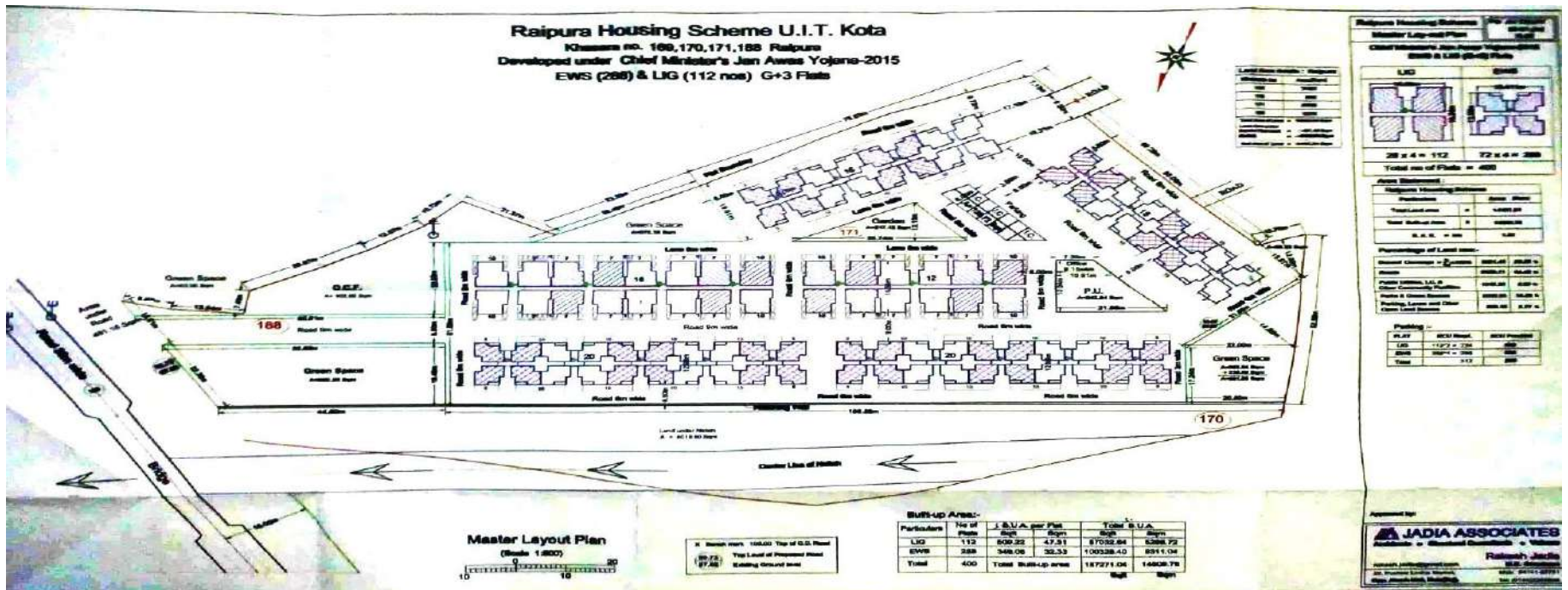

# Project - 7 : Affordable Housing Project at Chhoti Sadri

- “ Location - Chhoti Sadari (Pratapgarh)
- “ Implementing Agency - Nagar Palika Chhoti sadari
- “ Total Land Area - 1.00 Hac. (Govt. Land)
- “ No of Units - EWS - 288 units  
     LIG - 0 units  
     Total - 288 units
- “ Supper Built up area / price - 325.00 Sqft. (EWS) @ 1320/- Rs. 4.29 Lacs.

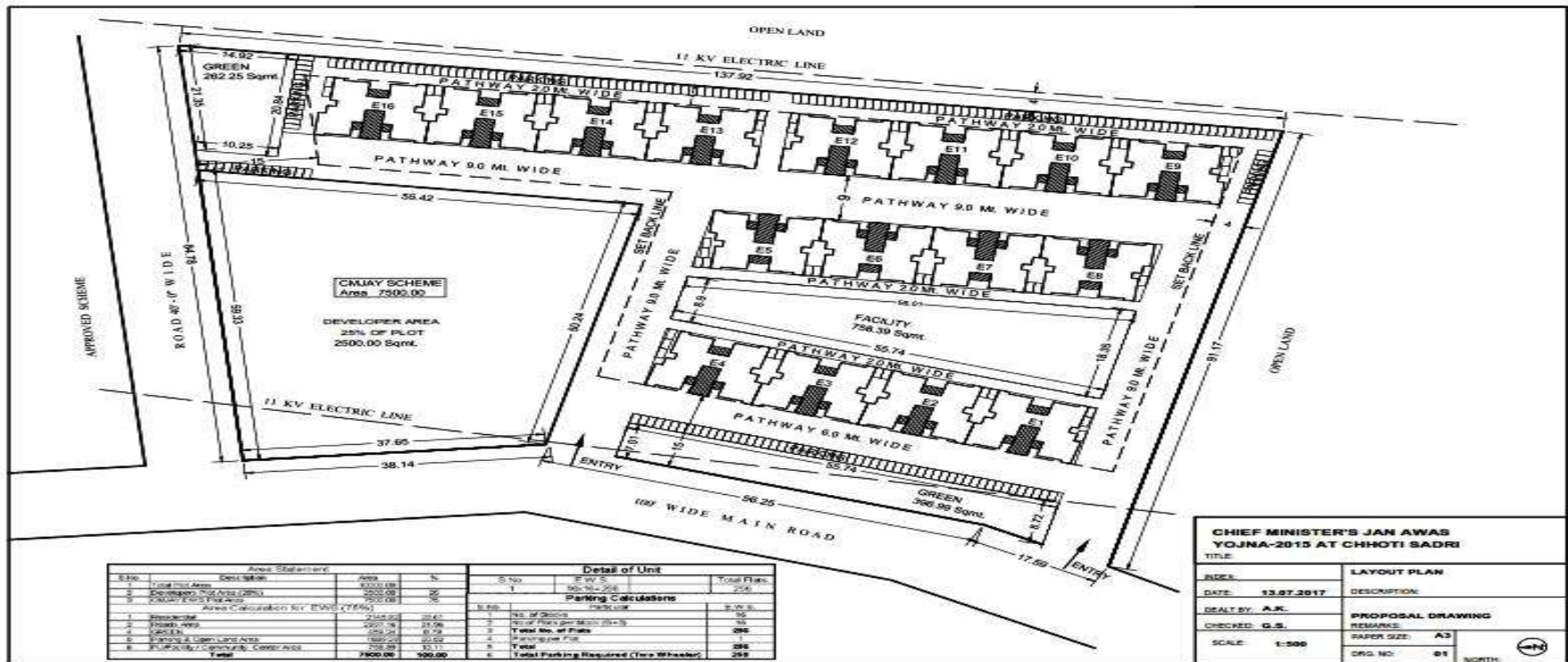

# Project - 8 : Affordable Housing Project at Rawatbhata

- “ Location - Rawatbhata (Chittorgarh)
- “ Implementing Agency - Nagar Palika Rawatbhata
- “ Total Land Area - 4.23 Hac. (Govt. Land)
- “ No of Units - EWS - 752 units  
LIG - 416 units  
Total - 1168 units
- “ Supper Built up area / price - 325.00 Sqft. (EWS) @ 1320/- Rs. 4.29 Lacs.  
- 500.00 Sqft. (LIG) @ 1320/- Rs. 6.60 Lacs.

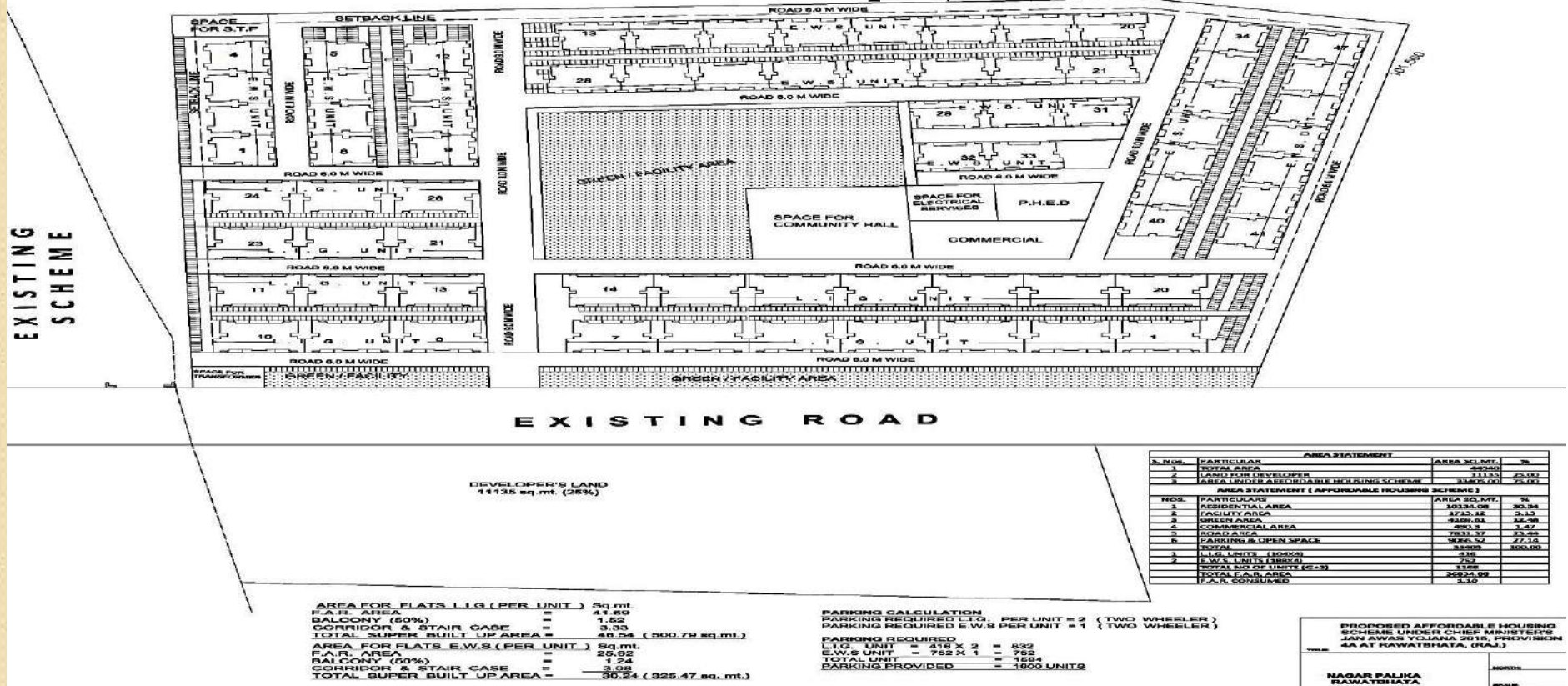



# Project - 10 : Affordable Housing Project at Baran

- “ Location - Baran
- “ Implementing Agency - Nagar Palika Baran
- “ Total Land Area - 2.53 Hac. (Govt. Land)
- “ No of Units - EWS - 416 units  
 LIG - 240 units  
 Total - 656 units
- “ Supper Built up area / price - 325.00 Sqft. (EWS) @ 1320/- Rs. 4.29 Lacs.  
 - 500.00 Sqft. (LIG) @ 1320/- Rs. 6.60 Lacs.

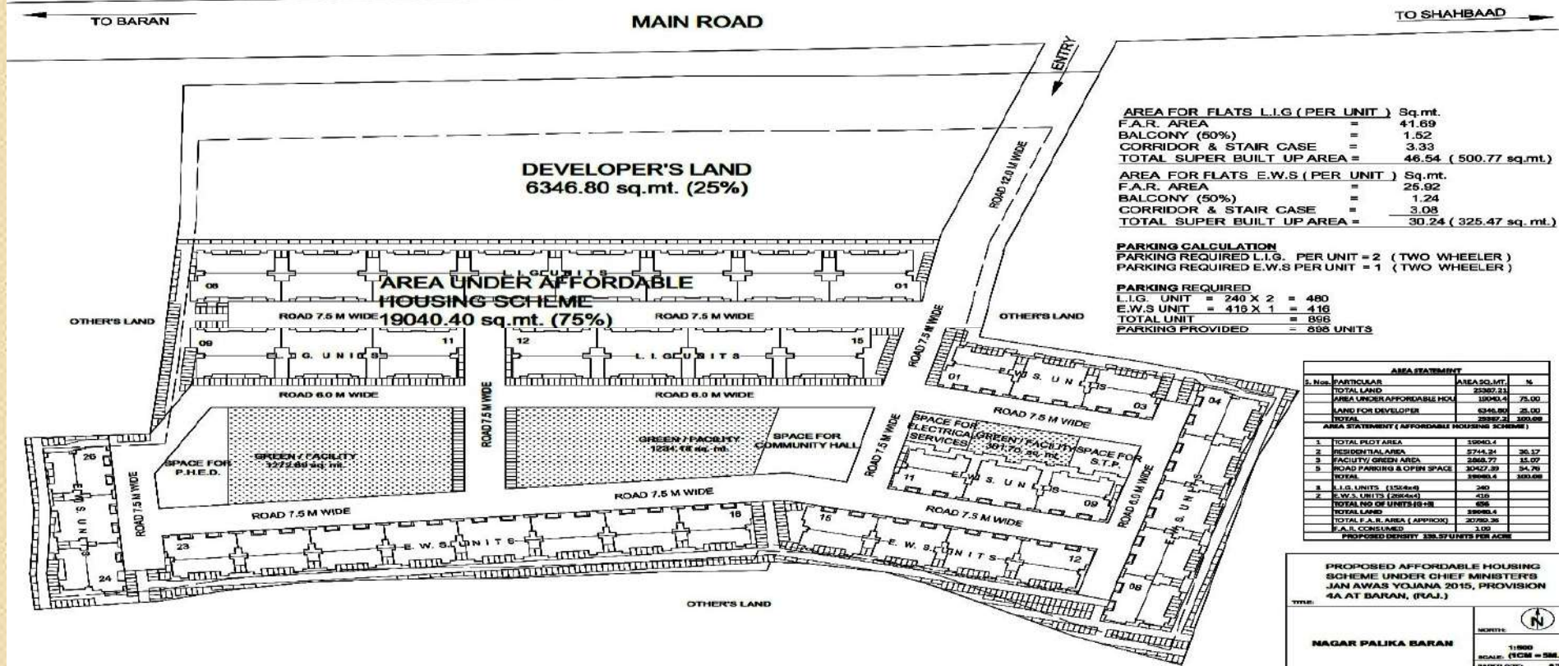

# Project - 11 : Affordable Housing Project at Bhinmal

- “ Location - Bhinmal (Jalor)
- “ Implementing Agency - Nagar Palika Bhinmal
- “ Total Land Area - 2.81 Hac. (Govt. Land)
- “ No of Units - EWS - 400 units  
LIG - 320 units  
Total - 720 units
- “ Supper Built up area / price - 325.00 Sqft. (EWS) @ 1320/- Rs. 4.29 Lacs.  
- 500.00 Sqft. (LIG) @ 1320/- Rs. 6.60 Lacs.

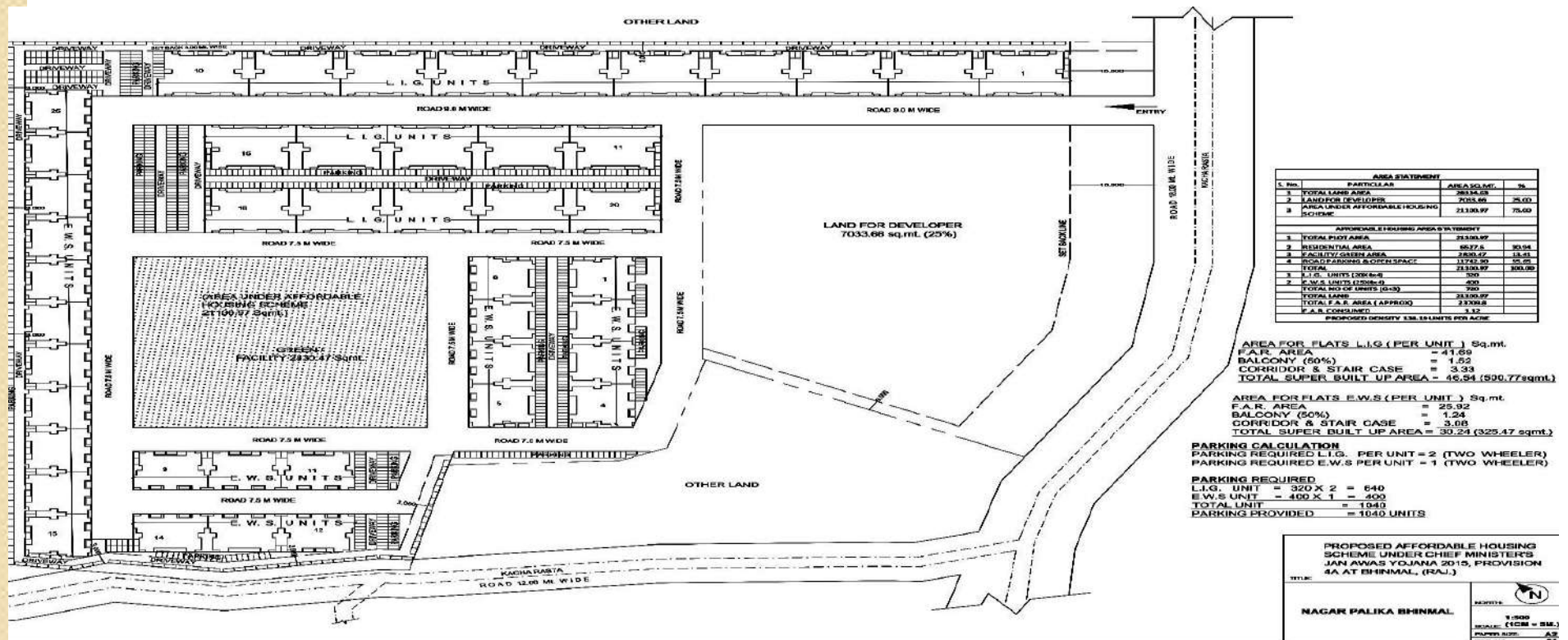

# Project - 12 : Affordable Housing Project at Dausa

- “ Location - Dausa
- “ Implementing Agency - Nagar Parishad Dausa
- “ Total Land Area - 1.19 Hac. (Govt. Land)
- “ No of Units - EWS - 272 units  
 LIG - 0 units  
 Total - 272 units
- “ Supper Built up area / price - 325.00 Sqft. (EWS) @ 1320/- Rs. 4.29 Lacs.  
 - 500.00 Sqft. (LIG) @ 1320/- Rs. 6.60 Lacs.

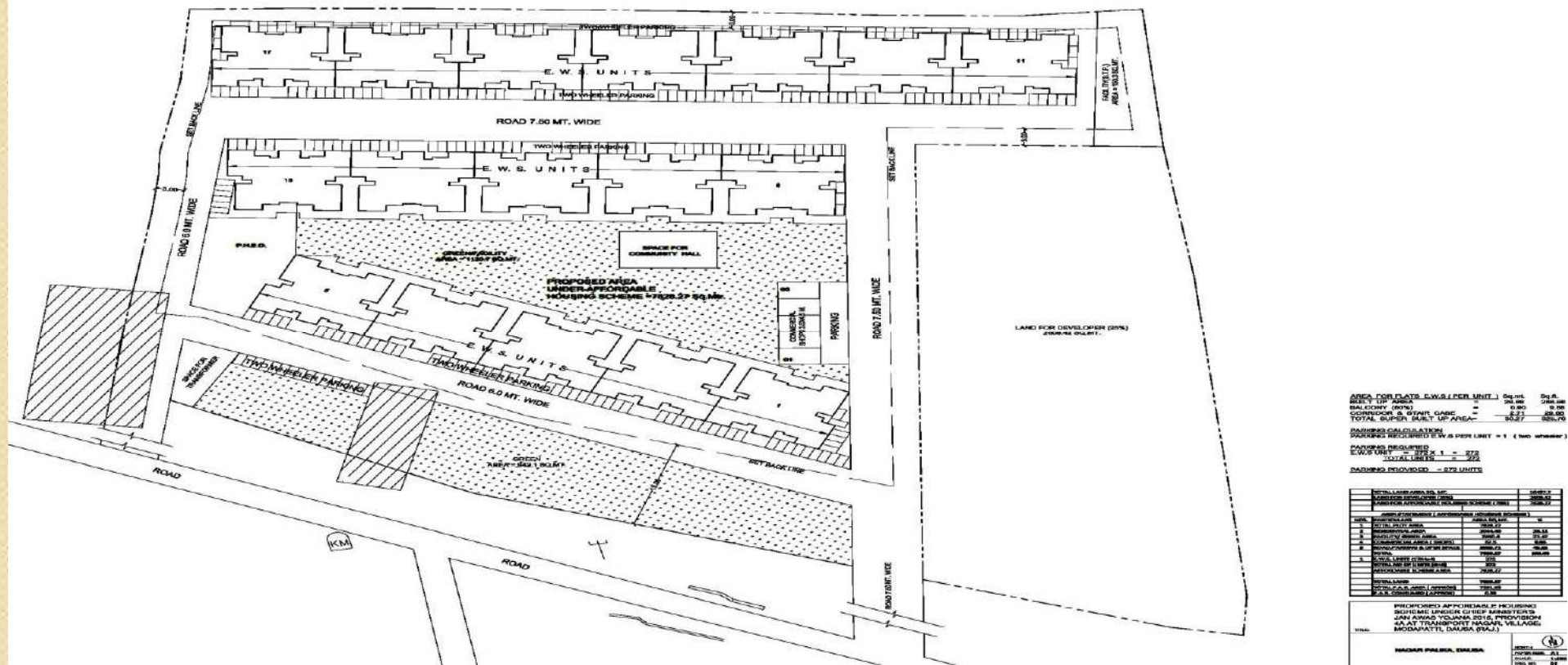



# Project - 13 : Affordable Housing Project at Jobner

- “ Location - Jobner (Jaipur)
- “ Implementing Agency - Nagar Palika Jobner
- “ Total Land Area - 3.00 Hac. (Govt. Land)
- “ No of Units - EWS - 496 units  
                   LIG - 208 units  
                   Total - 704 units
- “ Supper Built up area / price - 325.00 Sqft. (EWS) @ 1320/- Rs. 4.29 Lacs.  
   - 500.00 Sqft. (LIG) @ 1320/- Rs. 6.60 Lacs.

PROPOSED AFFORDABLE AT JOBNER, JAIPUR



GENERAL INFORMATION		TOTAL AREA		TOTAL COST		TOTAL UNIT	
Sl. No.	Description	Area (Sq. Hec.)	Area (Sq. Ft.)	Cost (Rs. Lacs)	Unit Type	Quantity	Total
1	Plot Area	3.00	84600				
2	Forest Department Office	0.7571	21000				
3	Open Space						
4	Other						
TOTAL		3.00	84600				
TOTAL UNIT							
EWS							
LIG							
TOTAL							

# Project - 14 : Affordable Housing Project at Kekari

- “ Location - Kekari (Ajmer)
- “ Implementing Agency - Nagar Palika Kekari
- “ Total Land Area - 2.50 Hac. (Govt. Land)
- “ No of Units - EWS - 400 units  
 LIG - 256 units  
 Total - 656 units
- “ Supper Built up area / price - 325.00 Sqft. (EWS) @ 1320/- Rs. 4.29 Lacs.  
 - 500.00 Sqft. (LIG) @ 1320/- Rs. 6.60 Lacs.

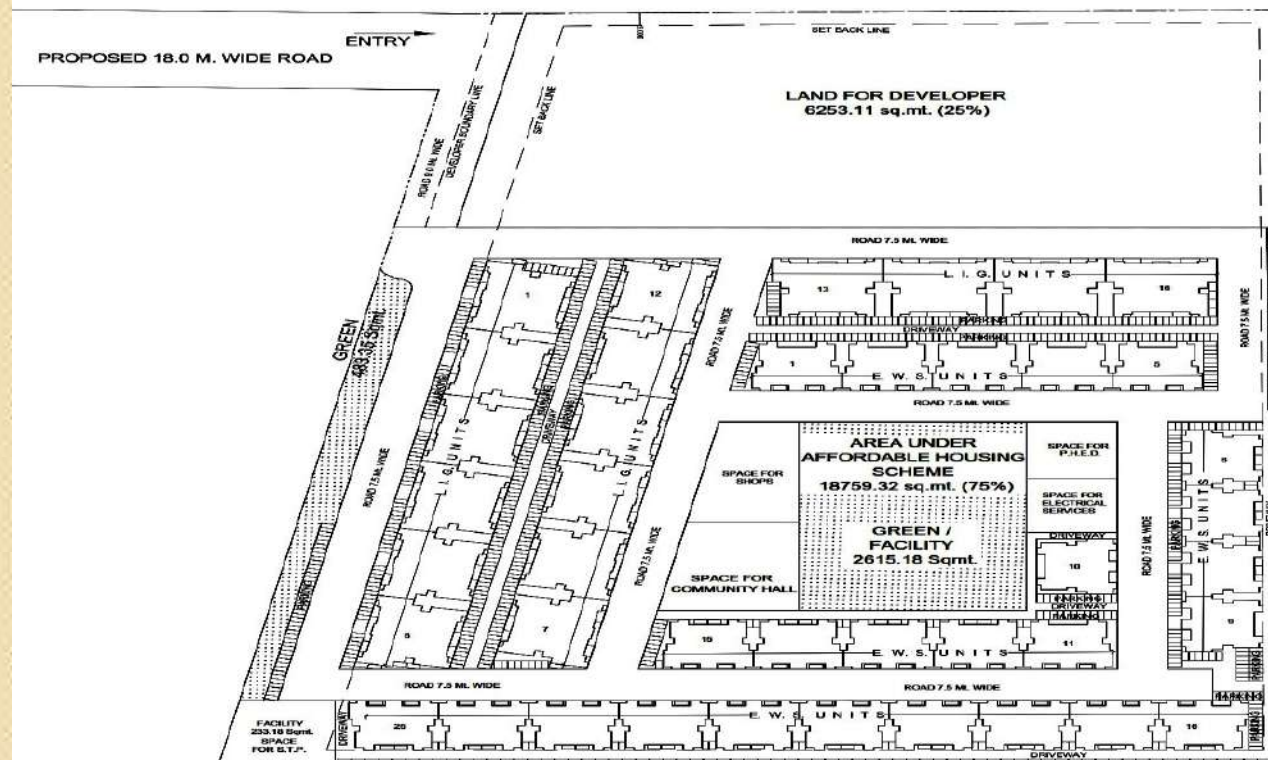

AREA FOR FLATS L.I.G. (PER UNIT)		Sq.mt.
F.A.R. AREA	=	41.08
BALCONY (50%)	=	1.52
CORRIDOR & STAIR CASE	=	3.33
TOTAL SUPER BUILT UP AREA	=	46.54 ( 500.77 sq.mt.)

AREA FOR FLATS E.W.S. (PER UNIT)		Sq.mt.
F.A.R. AREA	=	26.92
BALCONY (50%)	=	1.24
CORRIDOR & STAIR CASE	=	3.08
TOTAL SUPER BUILT UP AREA	=	30.24 ( 325.47 sq.mt.)

**PARKING CALCULATION**  
 PARKING REQUIRED L.I.G. PER UNIT - 2 ( TWO WHEELER )  
 PARKING REQUIRED E.W.S PER UNIT = 1 ( TWO WHEELER )

**PARKING REQUIRED**  
 L.I.G. UNIT - 256 X 2 = 512  
 E.W.S UNIT - 400 X 1 = 400  
 TOTAL UNIT = 912  
 PARKING PROVIDED = 912 UNITS

AREA STATEMENT			
S. No.	PARTICULAR	AREA SQ.MT.	%
1	TOTAL LAND AREA	25012.42	
2	LAND FOR DEVELOPER	6253.11	25.00
3	AREA UNDER AFFORDABLE HOUSING SCHEME	18759.32	75.00
AFFORDABLE HOUSING AREA STATEMENT			
1	TOTAL PLOT AREA	18759.32	
2	RESIDENTIAL AREA	5807.28	30.96
3	FACILITY/ GREEN AREA	3331.71	17.76
4	ROAD AREA	5292.61	28.21
5	PARKING & OPEN SPACE	4327.715	23.07
TOTAL		18759.32	100.00
1	L.I.S. UNITS (10X4x4)	256	
2	E.W.S. UNITS (25X4x4)	400	
TOTAL NO OF UNITS (G+3)		656	
TOTAL LAND		18759.32	
TOTAL F.A.R. AREA ( APPROX )		21041.64	
F.A.R. CONSUMED		1.12	
PROPOSED DENSITY 141.68 UNITS PER ACRE			

# Project - 15 : Affordable Housing Project at Sarwar

- “ Location - Sawar (Ajmer)
- “ Implementing Agency - Nagar Palika Sarwar
- “ Total Land Area - 2.25 Hac. (Govt. Land)
- “ No of Units - EWS - 384 units  
                   LIG - 192 units  
                   Total - 576 units
- “ Supper Built up area / price - 325.00 Sqft. (EWS) @ 1320/- Rs. 4.29 Lacs.  
   - 500.00 Sqft. (LIG) @ 1320/- Rs. 6.60 Lacs.

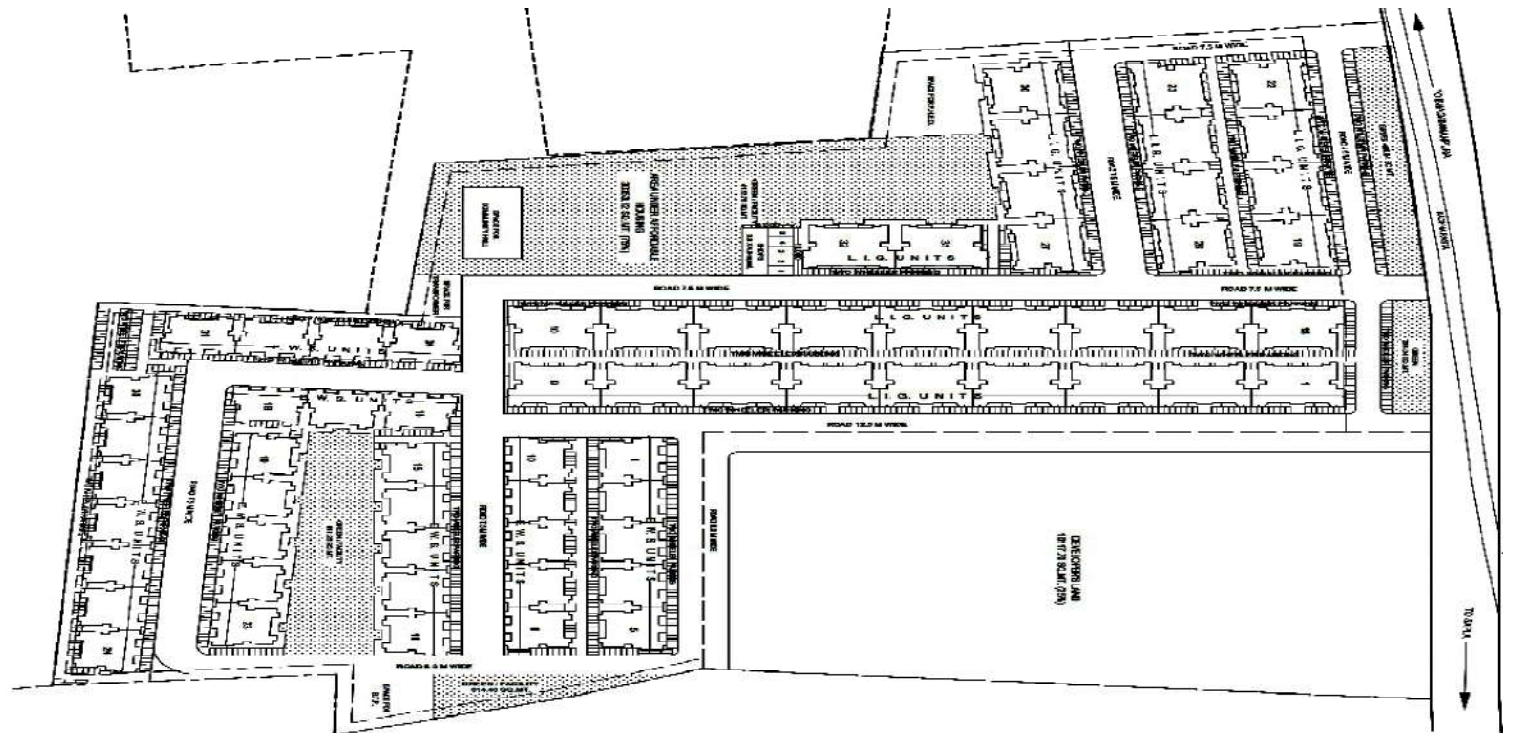

AREA OF UNIT, L.A. (sq. mtr) 10.00  
 E.A. (sq. mtr) 1.50  
 B.A. (sq. mtr) 1.50  
 O.C. (sq. mtr) 1.50  
 D.W. (sq. mtr) 1.50

AREA OF UNIT, L.A. (sq. mtr) 10.00  
 E.A. (sq. mtr) 1.50  
 B.A. (sq. mtr) 1.50  
 O.C. (sq. mtr) 1.50  
 D.W. (sq. mtr) 1.50

AREA OF UNIT, L.A. (sq. mtr) 10.00  
 E.A. (sq. mtr) 1.50  
 B.A. (sq. mtr) 1.50  
 O.C. (sq. mtr) 1.50  
 D.W. (sq. mtr) 1.50

AREA OF UNIT, L.A. (sq. mtr) 10.00  
 E.A. (sq. mtr) 1.50  
 B.A. (sq. mtr) 1.50  
 O.C. (sq. mtr) 1.50  
 D.W. (sq. mtr) 1.50

Sl. No.	Particular	Quantity	Unit
1	Area of Unit	10.00	Sq. mtr
2	Area of Plot	10.00	Sq. mtr
3	Area of Common Area	1.50	Sq. mtr
4	Area of Overhead Tank	1.50	Sq. mtr
5	Area of Drainage	1.50	Sq. mtr
6	Area of Water Supply	1.50	Sq. mtr
7	Area of Sewerage	1.50	Sq. mtr
8	Area of Road	1.50	Sq. mtr
9	Area of Boundary Wall	1.50	Sq. mtr
10	Area of Gate	1.50	Sq. mtr
11	Area of Landscaping	1.50	Sq. mtr
12	Area of Electrical	1.50	Sq. mtr
13	Area of Fire Fighting	1.50	Sq. mtr
14	Area of Security	1.50	Sq. mtr
15	Area of Other	1.50	Sq. mtr
16	Total	10.00	Sq. mtr

PROPOSED AFFORDABLE HOUSING  
 SCHEME UNDER CHEER MINISTERS  
 ANAYAS POLICY AND PROVISION  
 4A IN SARWAR (P.U.)

PROJECT APPROVED BY  
 SARWAR PALIKA SARWAR

DATE: 22/01/2024  
 SCALE: 1:500

# Project - 16 : Affordable Housing Project at Tizara

- “ Location - Tizara (Alwar)
- “ Implementing Agency - Nagar Palika Tizara
- “ Total Land Area - 1.77 Hac. (Govt. Land)
- “ No of Units - EWS - 295 units  
                   LIG - 168 units  
                   Total - 464 units
- “ Supper Built up area / price - 325.00 Sqft. (EWS) @ 1320/- Rs. 4.29 Lacs.  
   - 500.00 Sqft. (LIG) @ 1320/- Rs. 6.60 Lacs.

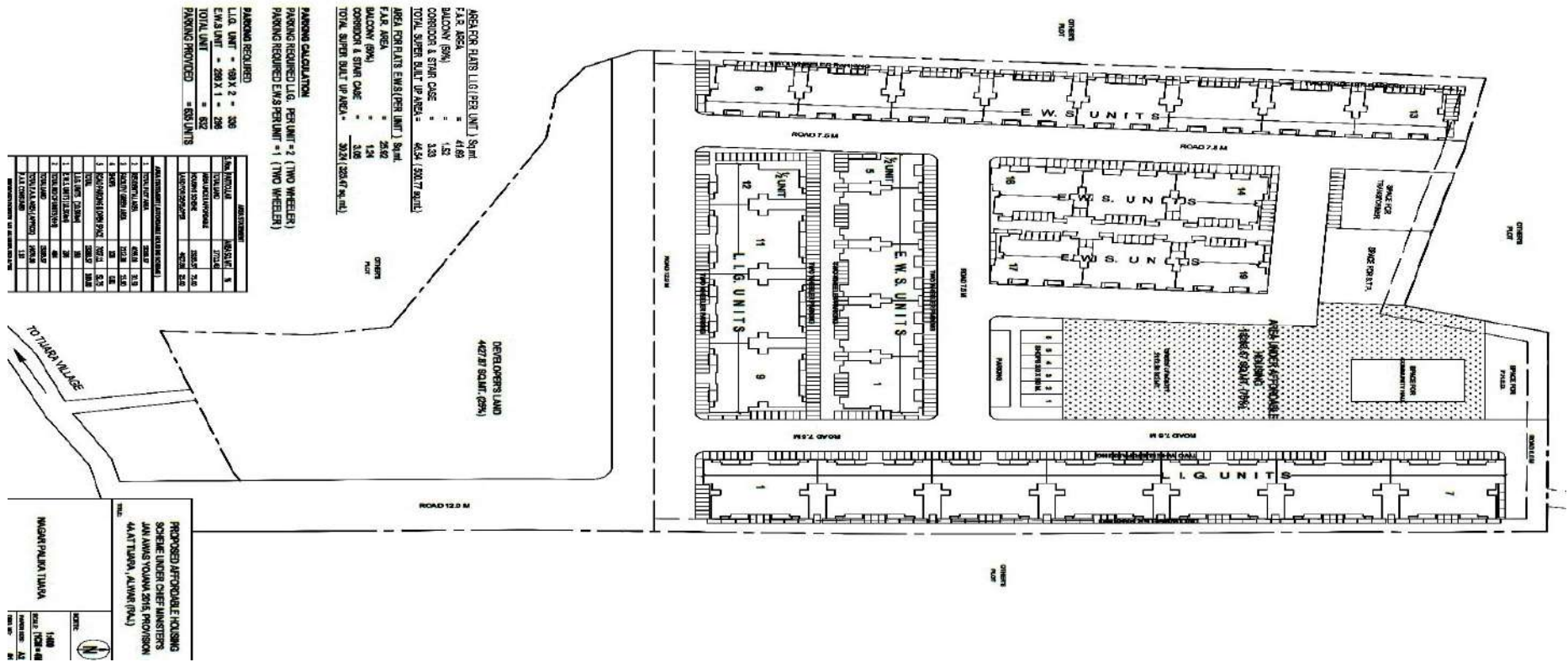

# Project - 17 : Affordable Housing Project at Abu Road

- “ Location - Abu Road (Sirohi)
- “ Implementing Agency - Nagar Palika Abu road
- “ Total Land Area - 2.50 Hac. (Govt. Land)
- “ No of Units - EWS - 400 units  
 LIG - 256 units  
 Total - 656 units
- “ Supper Built up area / price - 325.00 Sqft. (EWS) @ 1320/- Rs. 4.29 Lacs.  
 - 500.00 Sqft. (LIG) @ 1320/- Rs. 6.60 Lacs.

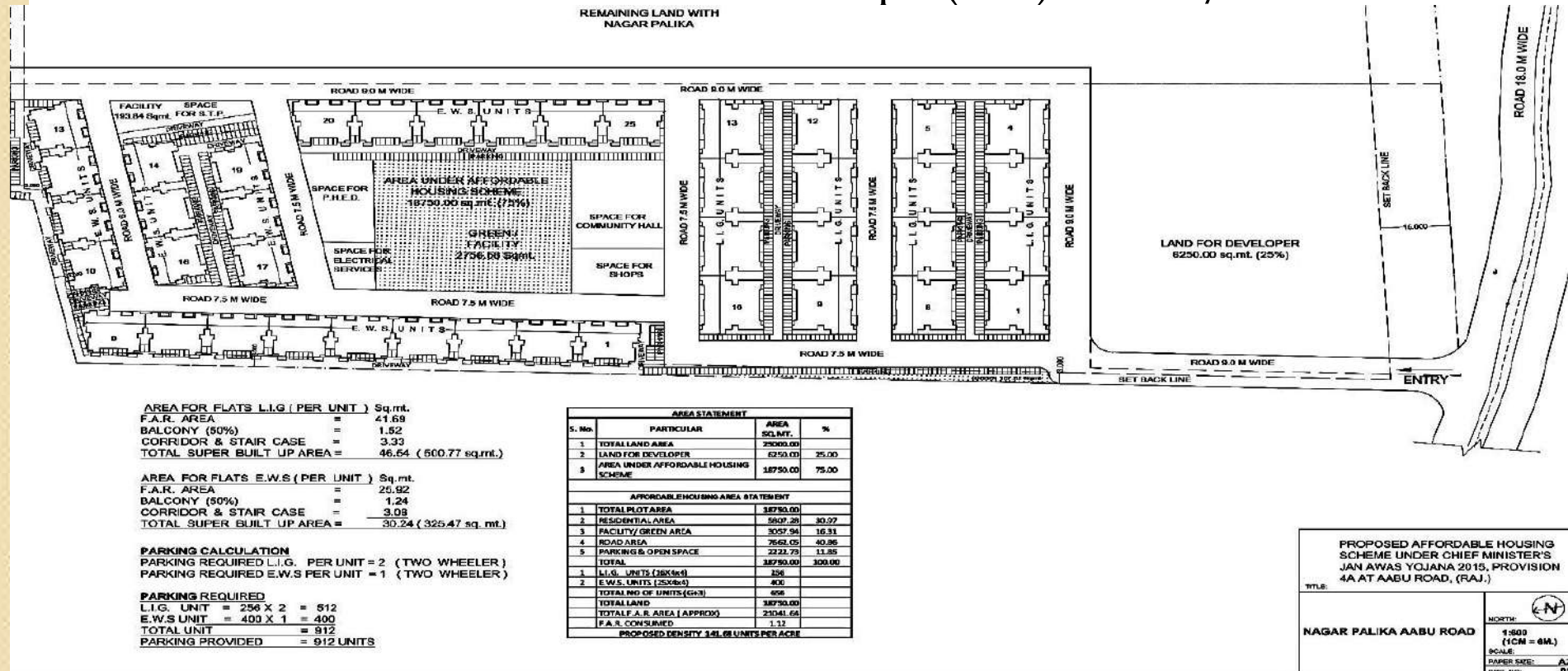

# Project - 18 : Affordable Housing Project at Bikaner

- " Location - Bikaner
- " Implementing Agency - Urban Improvement Trust (UIT)
- " Total Land Area - 3.17 Hac. (Govt. Land)
- " No of Units - EWS - 524 units  
LIG - 524 units  
Total - 1180 units
- " Supper Built up area / price - 350.00 Sqft. (EWS) @ 1320/- Rs. 4.62 Lacs.  
- 500.00 Sqft. (LIG) @ 1320/- Rs. 6.60 Lacs.

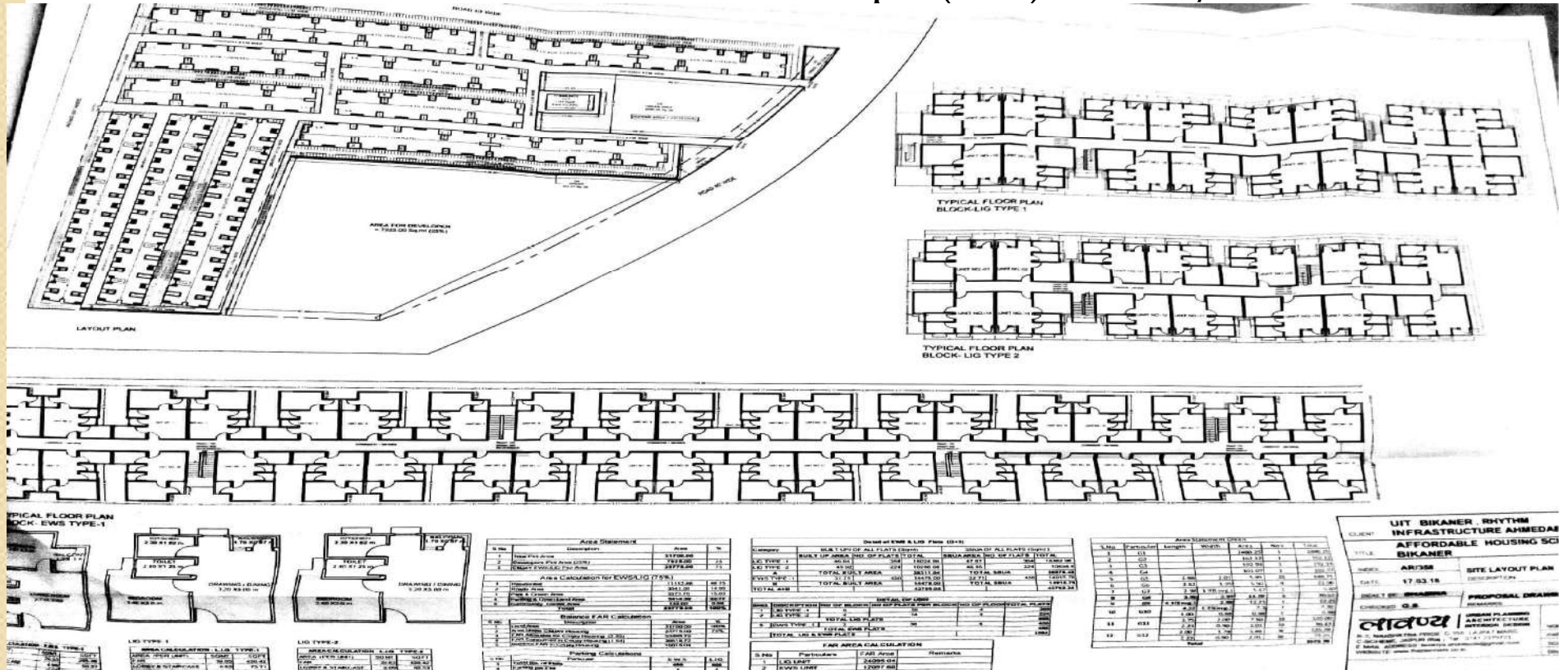

# Project - 19 : Affordable Housing Project at Sawaimadhapur

- Location - Sawaimadhapur
- Implementing Agency - Urban Improvement Trust (UIT)
- Total Land Area - 2.08 Hac. (Govt. Land)
- No of Units - EWS - 368 units  
LIG - 192 units  
Total - 560 units
- Supper Built up area / price - 350.00 Sqft. (EWS) @ 1320/- Rs. 4.62 Lacs.  
- 500.00 Sqft. (LIG) @ 1320/- Rs. 6.60 Lacs.

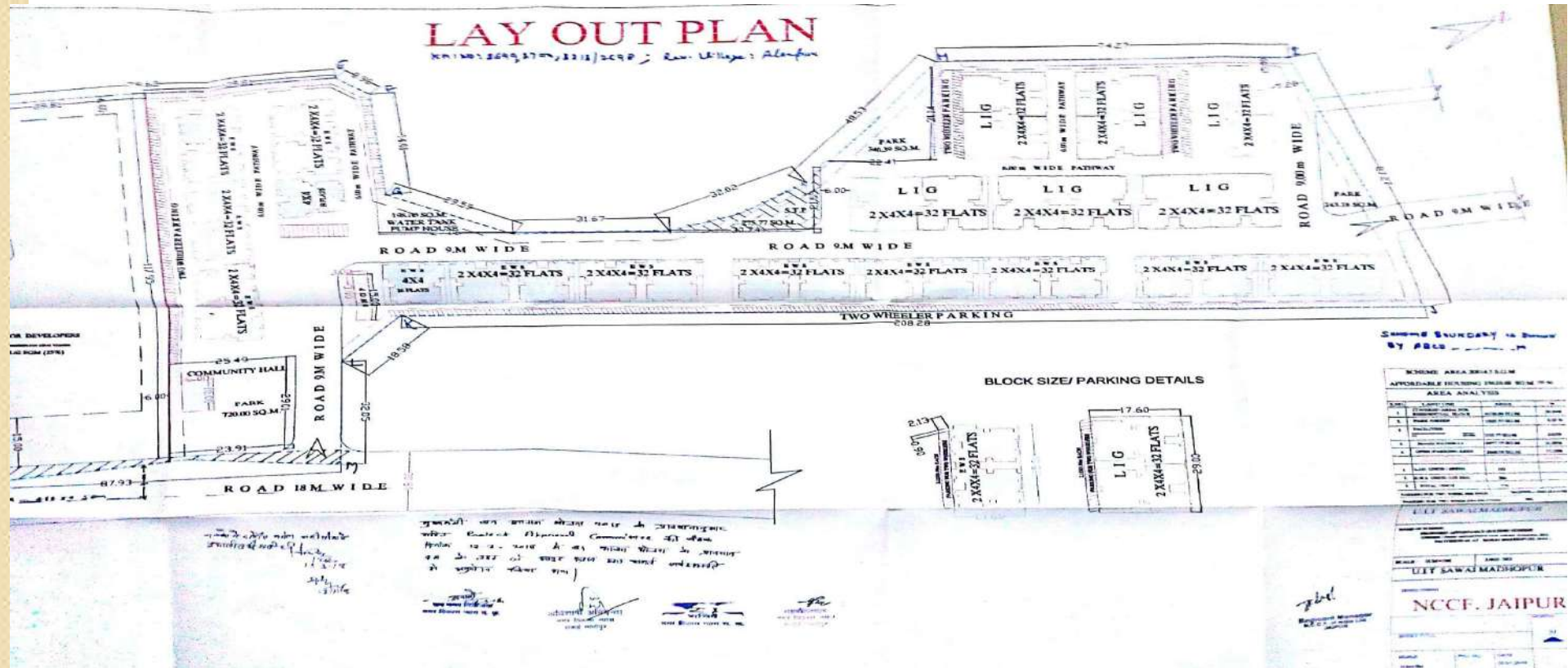

# Project – 20 : Affordable Housing Project by JDA Jaipur

- “ Location – Plot No. GH-5 & GH-6 Anand Vihar, Jaipur
- “ Implementing Agency – Jaipur Development Authority (JDA)
- “ Total Land Area – 1.23 Hac. (Govt. Land)
- “ No of Units – EWS – 250 units  
LIG – 73 units  
Total – 323 units
- “ Supper Built up area / price – 350.00 Sqft. (EWS) @ 1320/- Rs. 4.62 Lacs.  
- 500.00 Sqft. (LIG) @ 1320/- Rs. 6.60 Lacs.

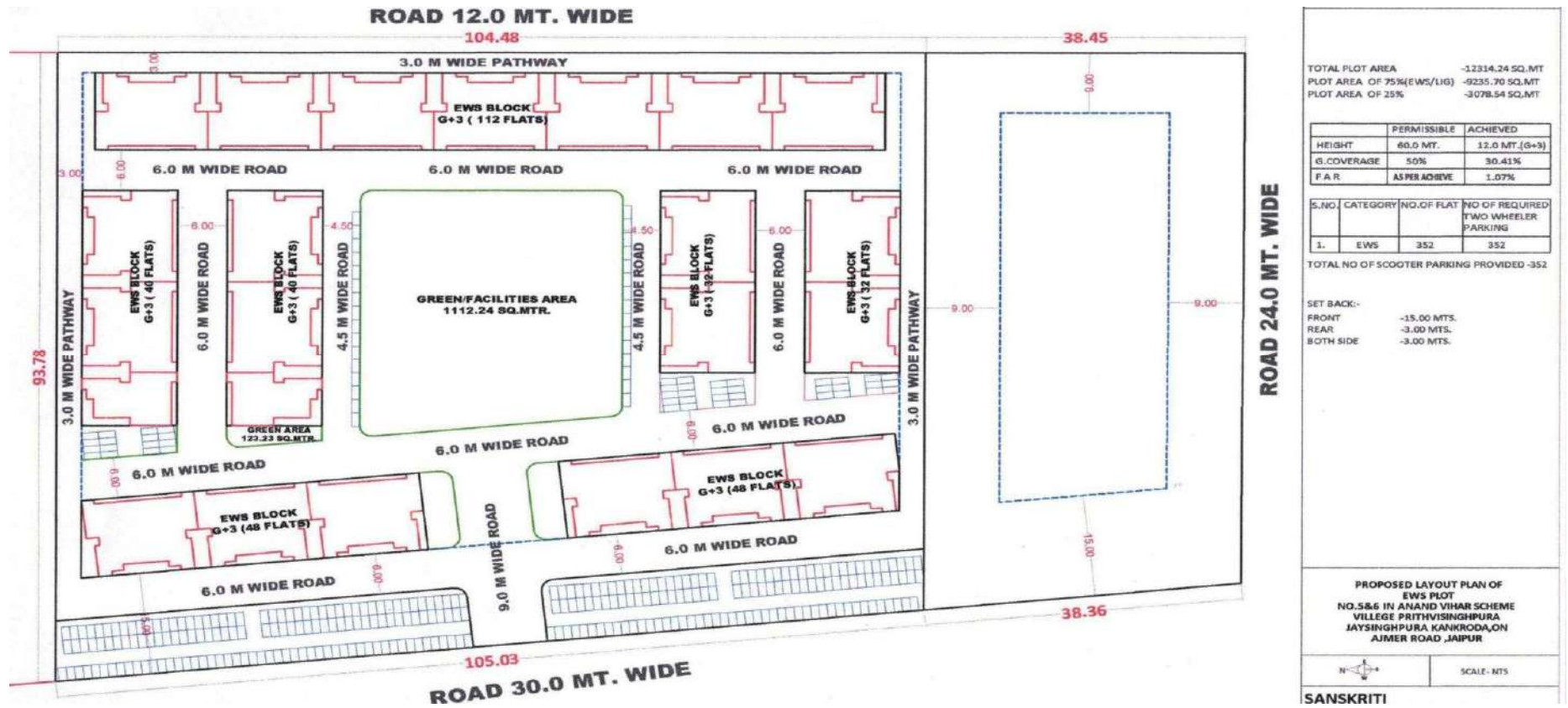



## Project – 21 : Affordable Housing Project by JDA Jaipur

- ” Location – Plot No. GH-1 & GH-2 Anand Vihar, Jaipur
- ” Implementing Agency – Jaipur Development Authority (JDA)
- ” Total Land Area – 1.03 Hac. (Govt. Land)
- ” No of Units – EWS – 270 units  
LIG – 0 units  
Total – 270 units
- ” Supper Built up area / price – 350.00 Sqft. (EWS) @ 1320/- Rs. 4.62 Lacs.  
- 500.00 Sqft. (LIG) @ 1320/- Rs. 6.60 Lacs.

# Project - 22 : Affordable Housing Project by JDA Jaipur

- “ Location - Plot No. GH-1,2,3 Shaurya Nagar, Jaipur
- “ Implementing Agency - Jaipur Development Authority (JDA)
- “ Total Land Area - 1.78 Hac. (Govt. Land)
- “ No of Units - EWS - 256 units  
LIG - 211 units  
Total - 467 units
- “ Supper Built up area / price - 350.00 Sqft. (EWS) @ 1320/- Rs. 4.62 Lacs.  
- 500.00 Sqft. (LIG) @ 1320/- Rs. 6.60 Lacs.

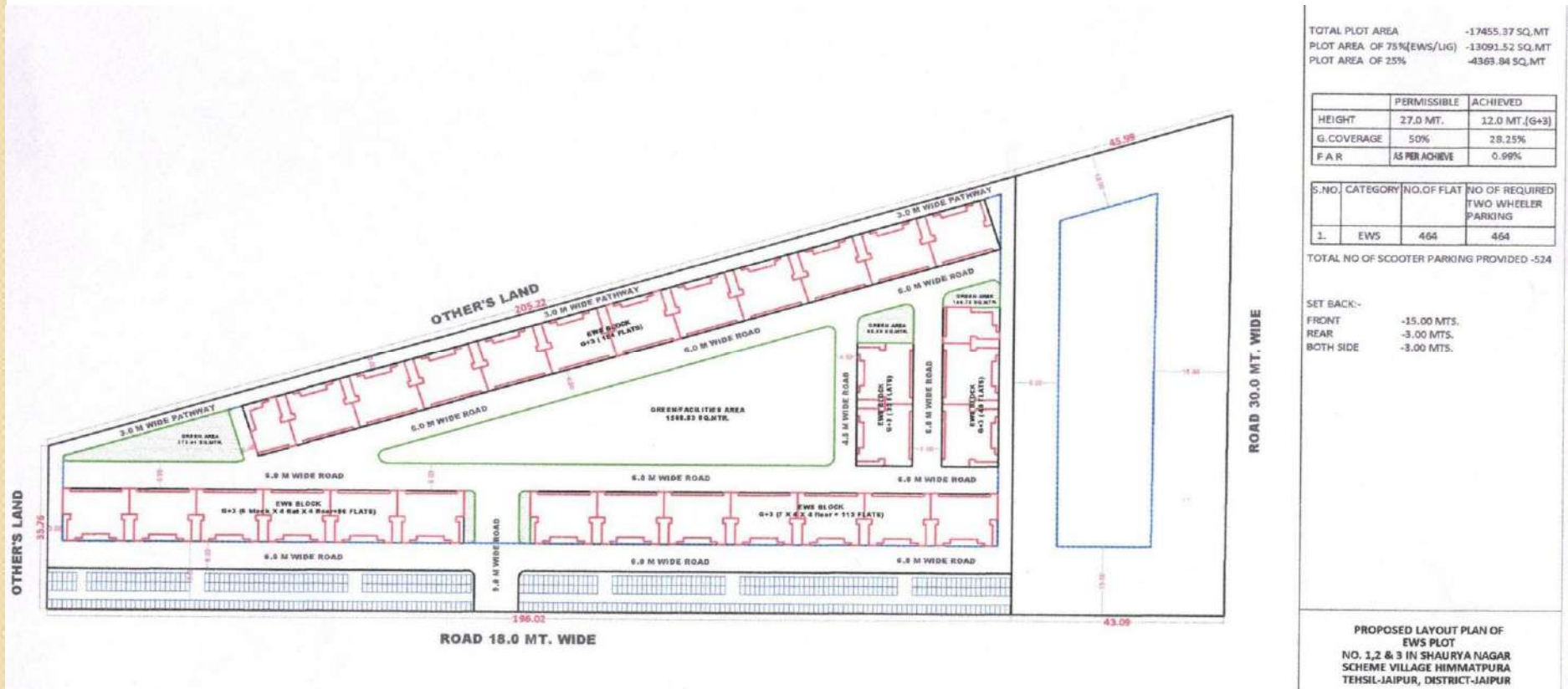

# Project – 23 : Affordable Housing Project by JDA Jaipur

- “ Location – Plot No. GH-4 & GH-5 Shaurya Nagar, Jaipur
- “ Implementing Agency – Jaipur Development Authority (JDA)
- “ Total Land Area – 1.02 Hac. (Govt. Land)
- “ No of Units – EWS – 268 units  
                           LIG – 0 units  
                           Total – 268 units
- “ Supper Built up area / price – 350.00 Sqft. (EWS) @ 1320/- Rs. 4.62 Lacs.  
   - 500.00 Sqft. (LIG) @ 1320/- Rs. 6.60 Lacs.

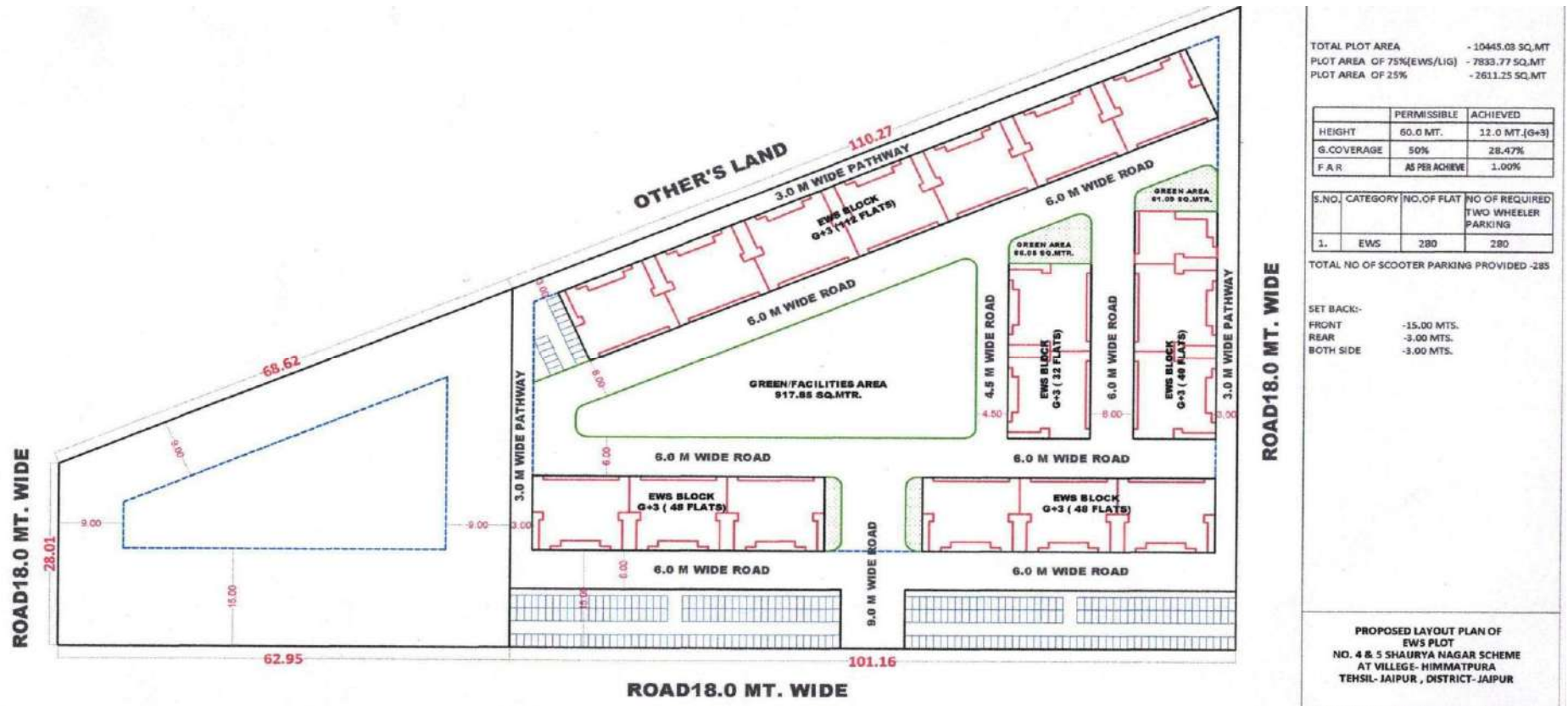

# Project – 24 : Affordable Housing Project by JDA Jaipur

- “ Location – Plot No. A2 to A6 Surya Nagar, Jaipur
- “ Implementing Agency – Jaipur Development Authority (JDA)
- “ Total Land Area – 1.08 Hac. (Govt. Land)
- “ No of Units – EWS – 276 units
  - LIG – 0 units
  - Total – 276 units
- “ Supper Built up area / price – 350.00 Sqft. (EWS) @ 1320/- Rs. 4.62 Lacs.  
 - 500.00 Sqft. (LIG) @ 1320/- Rs. 6.60 Lacs.

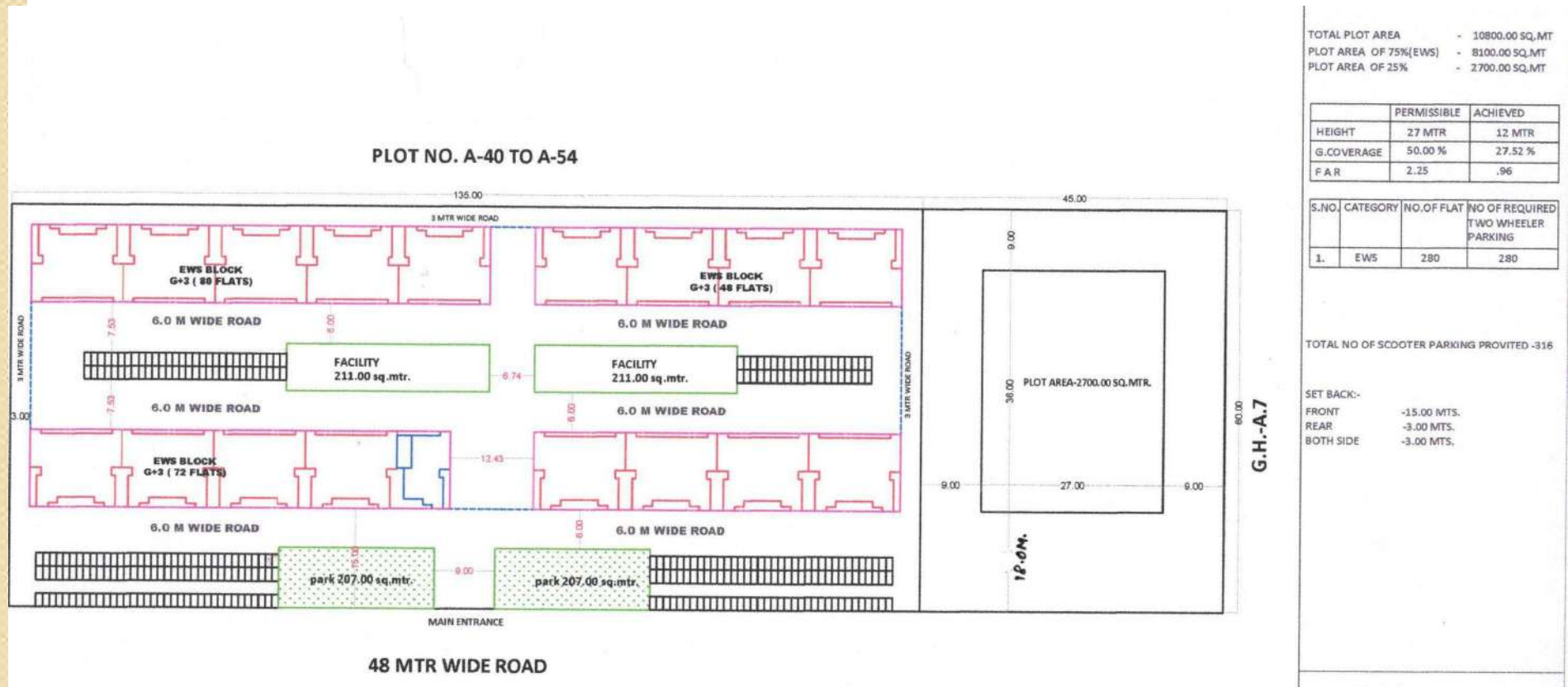

# Project – 25 : Affordable Housing Project by JDA Jaipur

- Location – Plot No. A9 to A14 Surya Nagar, Jaipur
- Implementing Agency – Jaipur Development Authority (JDA)
- Total Land Area – 1.08 Hac. (Govt. Land)
- No of Units – EWS – 276 units  
LIG – 0 units  
Total – 276 units
- Supper Built up area / price – 350.00 Sqft. (EWS) @ 1320/- Rs. 4.62 Lacs.  
- 500.00 Sqft. (LIG) @ 1320/- Rs. 6.60 Lacs.

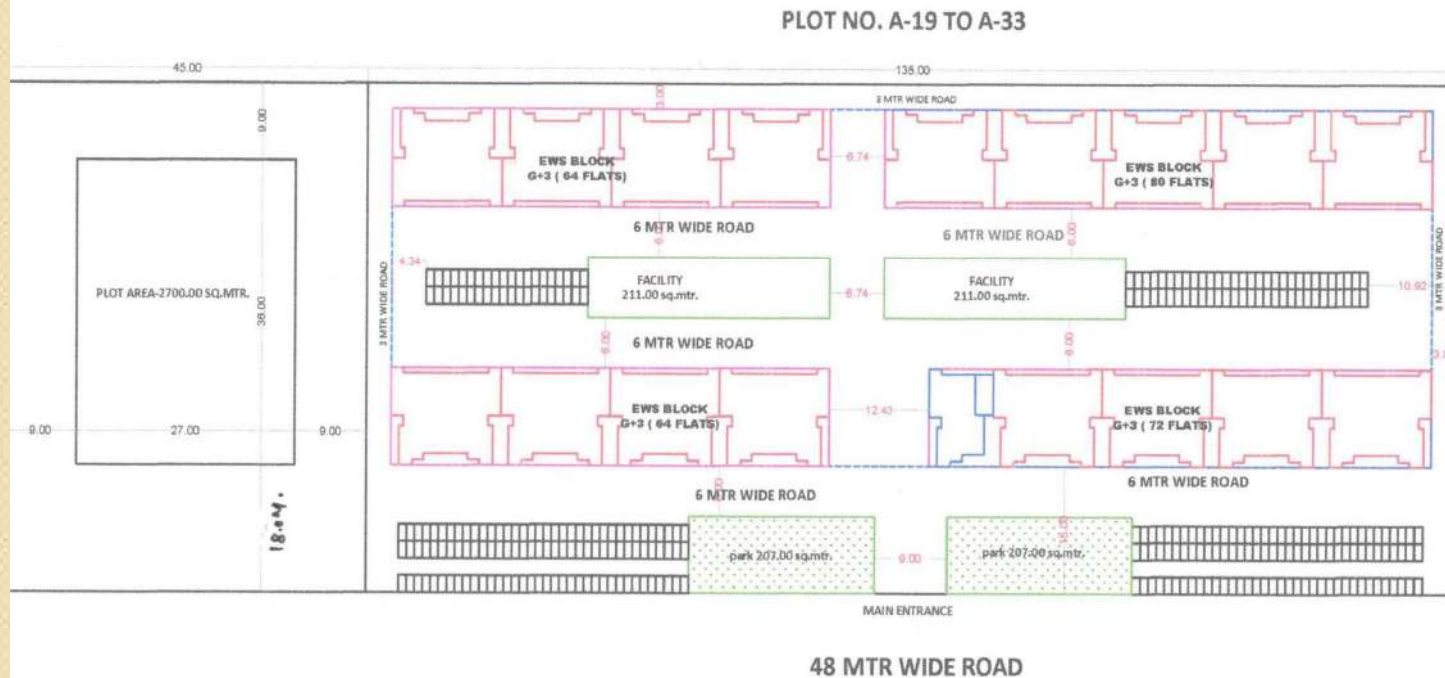

TOTAL PLOT AREA	- 10800.00 SQ.MT
PLOT AREA OF 75%(EWS)	- 8100.00 SQ.MT
PLOT AREA OF 25%	- 2700.00 SQ.MT

	PERMISSIBLE	ACHIEVED
HEIGHT	27 MTR	12 MTR
G.COVERAGE	50.00 %	27.52 %
F A R	2.25	.96

S.NO.	CATEGORY	NO.OF FLAT	NO OF REQUIRED TWO WHEELER PARKING
1.	EWS	280	280

TOTAL NO OF SCOOTER PARKING PROVIDED -316

SET BACK-	
FRONT	-15.00 MTS.
REAR	-3.00 MTS.
BOTH SIDE	-3.00 MTS.

**G.H.-A.14**

# Project - 26 : Affordable Housing Project by JDA Jaipur

- " Location - Plot No. GH-1 & 2 Abhinav Vihar Ext., Jaipur
- " Implementing Agency - Jaipur Development Authority (JDA)
- " Total Land Area - 1.03 Hac. (Govt. Land)
- " No of Units - EWS - 272 units  
 LIG - 0 units  
 Total - 272 units
- " Supper Built up area / price - 350.00 Sqft. (EWS) @ 1320/- Rs. 4.62 Lacs.  
 - 500.00 Sqft. (LIG) @ 1320/- Rs. 6.60 Lacs.

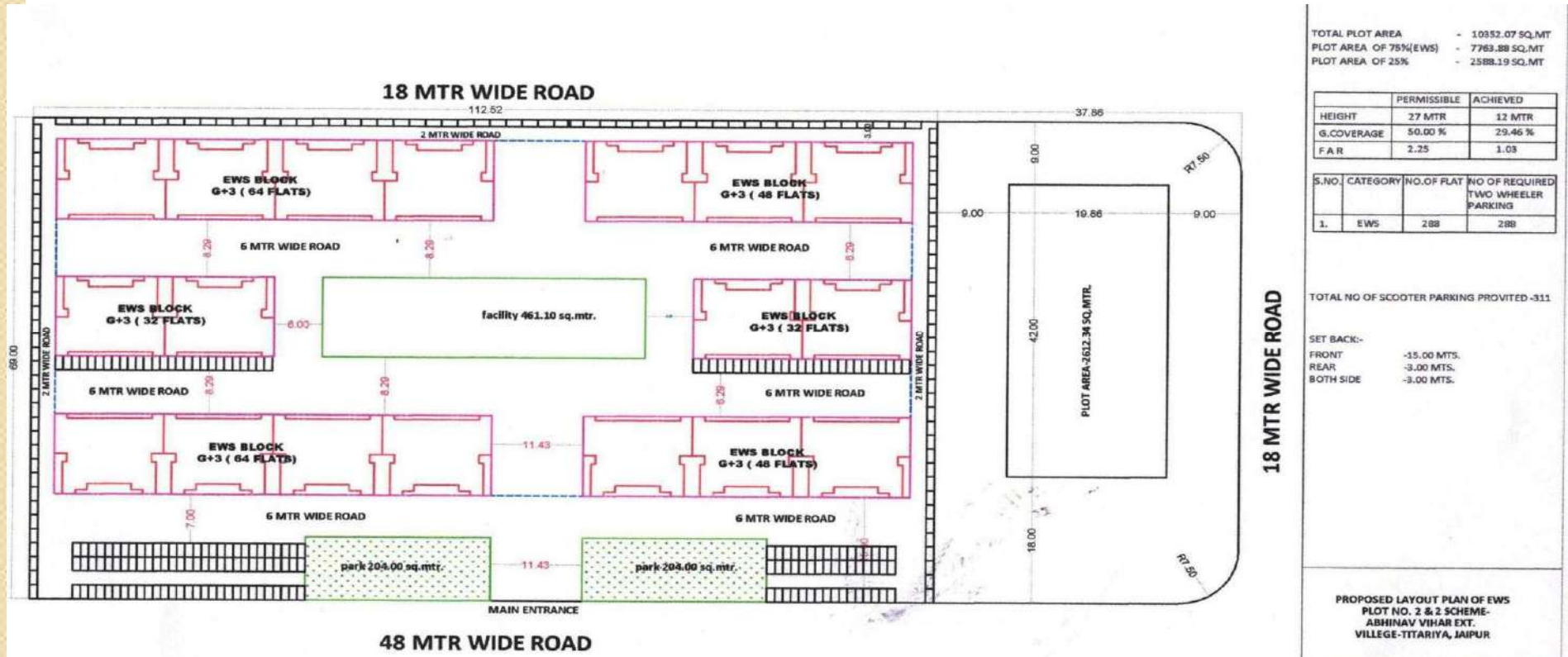

# Project – 27 : Affordable Housing Project by JDA Jaipur

- “ Location – Plot No. GH-3 to 4 Abhinav Vihar Ext., Jaipur
- “ Implementing Agency – Jaipur Development Authority (JDA)
- “ Total Land Area – 1.03 Hac. (Govt. Land)
- “ No of Units – EWS – 272 units
  - LIG – 0 units
  - Total – 272 units
- “ Supper Built up area / price – 350.00 Sqft. (EWS) @ 1320/- Rs. 4.62 Lacs.  
 - 500.00 Sqft. (LIG) @ 1320/- Rs. 6.60 Lacs.

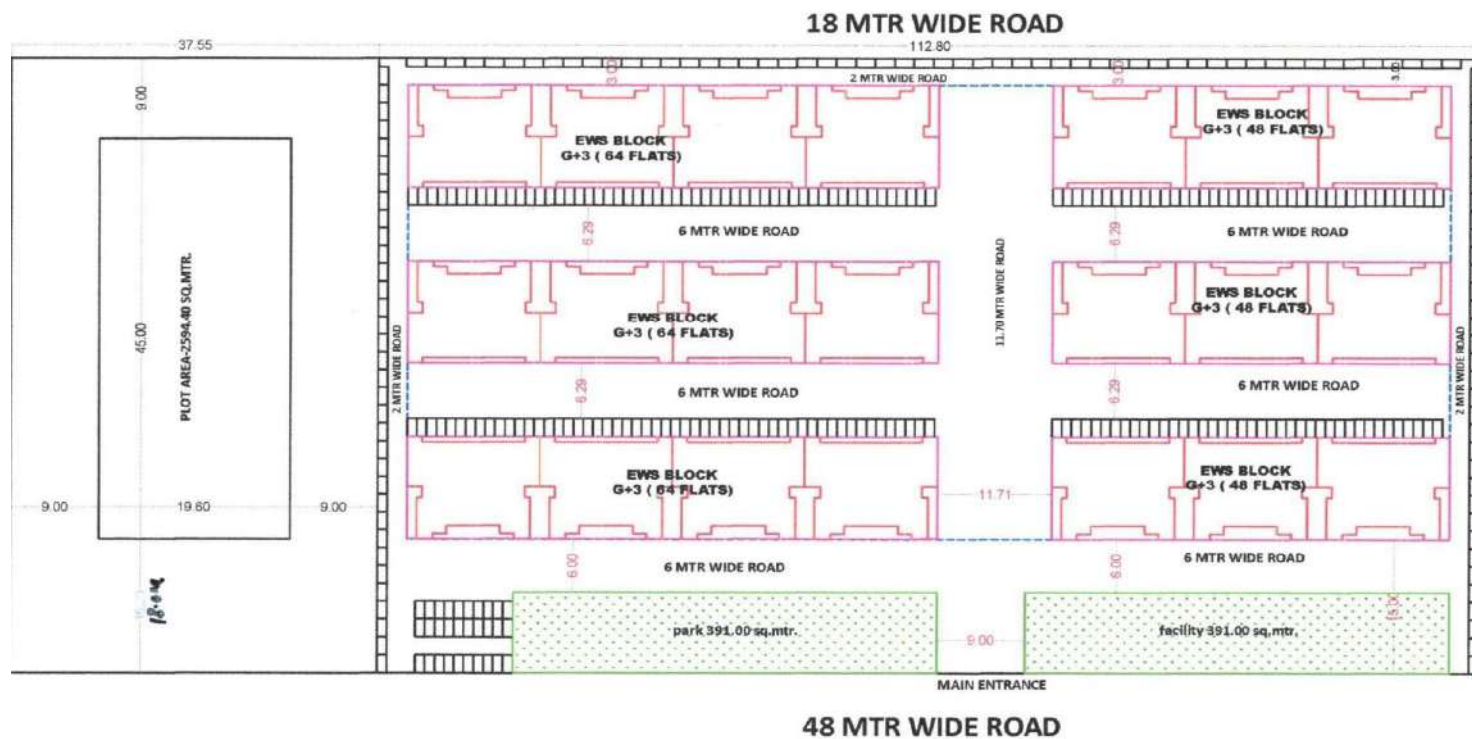

TOTAL PLOT AREA - 10377.6 SQ.MT  
 PLOT AREA OF 75%(EWS) - 7783.20 SQ.MT  
 PLOT AREA OF 25% - 2594.40 SQ.MT

	PERMISSIBLE	ACHIEVED
HEIGHT	27 MTR	12 MTR
G.COVERAGE	50.00 %	34.28 %
F.A.R	2.25	1.20

S.NO.	CATEGORY	NO.OF FLAT	NO OF REQUIRED TWO WHEELER PARKING
1.	EWS	336	336

TOTAL NO OF SCOOTER PARKING PROVIDED -340

SET BACK:-  
 FRONT -15.00 MTS.  
 REAR -3.00 MTS.  
 BOTH SIDE -3.00 MTS.

PROPOSED LAYOUT PLAN OF EWS  
 PLOT NO. 3 TO 4  
 IN ABHINAV VIHAR EXT.  
 VILLEGE-TITARIYA, JAIPUR

G.H.-2





# Project - 29 : Affordable Housing Project by RHB.

- “ Location - Pratap Nagar, Jaipur
- “ Implementing Agency - Rajasthan Housing Board (RHB)
- “ Total Land Area - 5.00 Hac. (Govt. Land)
- “ No of Units - EWS - 1008 units  
LIG - 0 units  
Total - 1008 units
- “ Supper Built up area / price - 350.00 Sqft. (EWS) @ 1320/- Rs. 4.62 Lacs.  
- 500.00 Sqft. (LIG) @ 1320/- Rs. 6.60 Lacs.

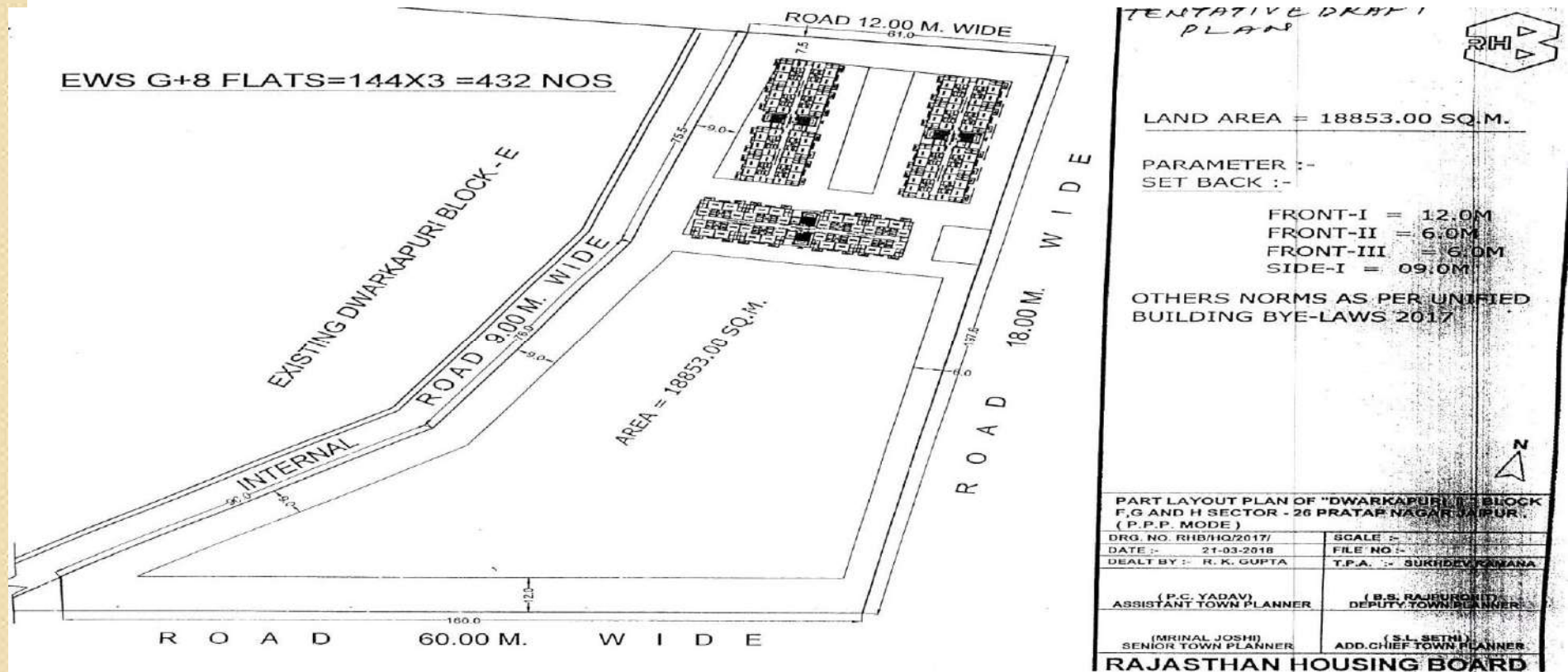

# Project - 30 : Affordable Housing Project by RHB.

- “ Location - Barli, Jodhpur.
- “ Implementing Agency - Rajasthan Housing Board (RHB)
- “ Total Land Area - 10.00 Hac. (Govt. Land)
- “ No of Units - EWS - 1120 units  
LIG - 0 units  
Total - 1120 units
- “ Supper Built up area / price - 350.00 Sqft. (EWS) @ 1320/- Rs. 4.62 Lacs.  
- 500.00 Sqft. (LIG) @ 1320/- Rs. 6.60 Lacs.

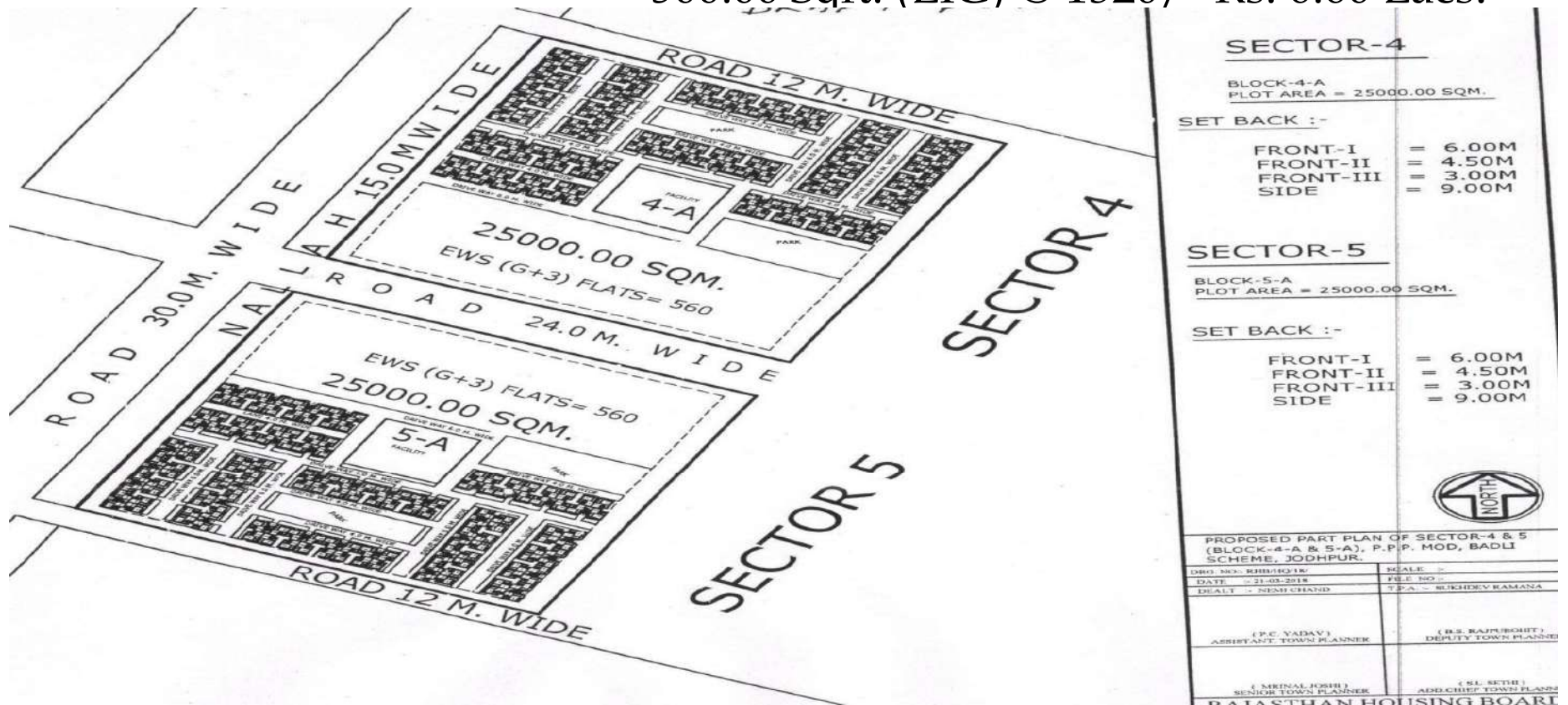

SECTOR-4	
BLOCK-4-A PLOT AREA = 25000.00 SQM.	
SET BACK :-	
FRONT-I	= 6.00M
FRONT-II	= 4.50M
FRONT-III	= 3.00M
SIDE	= 9.00M
SECTOR-5	
BLOCK-5-A PLOT AREA = 25000.00 SQM.	
SET BACK :-	
FRONT-I	= 6.00M
FRONT-II	= 4.50M
FRONT-III	= 3.00M
SIDE	= 9.00M
	
PROPOSED PART PLAN OF SECTOR-4 & 5 (BLOCK-4-A & 5-A), P.P.P. MOD, BADLI SCHEME, JODHPUR.	
DRG NO. RHB/10/12	SCALE :-
DATE - 21-03-2018	FILE NO. :-
DEALT - NEEL CHAND	T.P.A. - SURJDEV RAMANA
(P.C. YADAV) ASSISTANT TOWN PLANNER	(B.S. RAJPUROHIT) DEPUTY TOWN PLANNER
(M. NARAIN JOSHI) SENIOR TOWN PLANNER	(S.L. SETHI) ADD. CHIEF TOWN PLANNER
RAJASTHAN HOUSING BOARD	

# Project - 31 : Affordable Housing Project by RHB

- “ Location – Aravali Vihar, Bhiwadi (Alwar).
- “ Implementing Agency – Rajasthan Housing Board (RHB)
- “ Total Land Area – 2.30 Hac. (Govt. Land)
- “ No of Units – EWS – 432 units  
                           LIG – 0 units  
                           Total – 432 units
- “ Supper Built up area / price – 350.00 Sqft. (EWS) @ 1320/- Rs. 4.62 Lacs.  
   - 500.00 Sqft. (LIG) @ 1320/- Rs. 6.60 Lacs

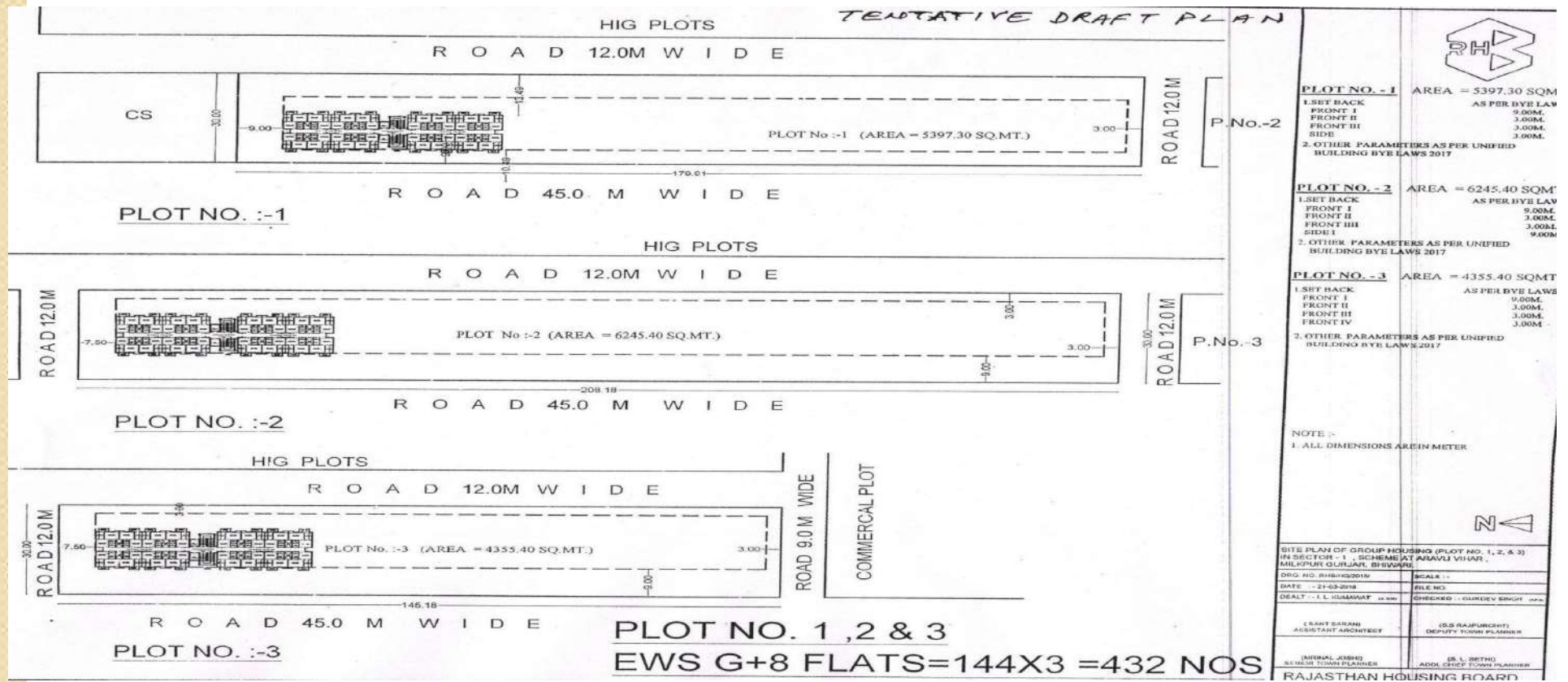

# Project - 32 : Affordable Housing Project by RHB

- ” Location - Shahjahapur, Bhiwadi (Alwar).
- ” Implementing Agency - Rajasthan Housing Board (RHB)
- ” Total Land Area - 2.30 Hac. (Govt. Land)
- ” No of Units - EWS - 1008 units  
LIG - 0 units  
Total - 1008 units
- ” Supper Built up area / price - 350.00 Sqft. (EWS) @ 1320/- Rs. 4.62 Lacs.  
- 500.00 Sqft. (LIG) @ 1320/- Rs. 6.60 Lacs.

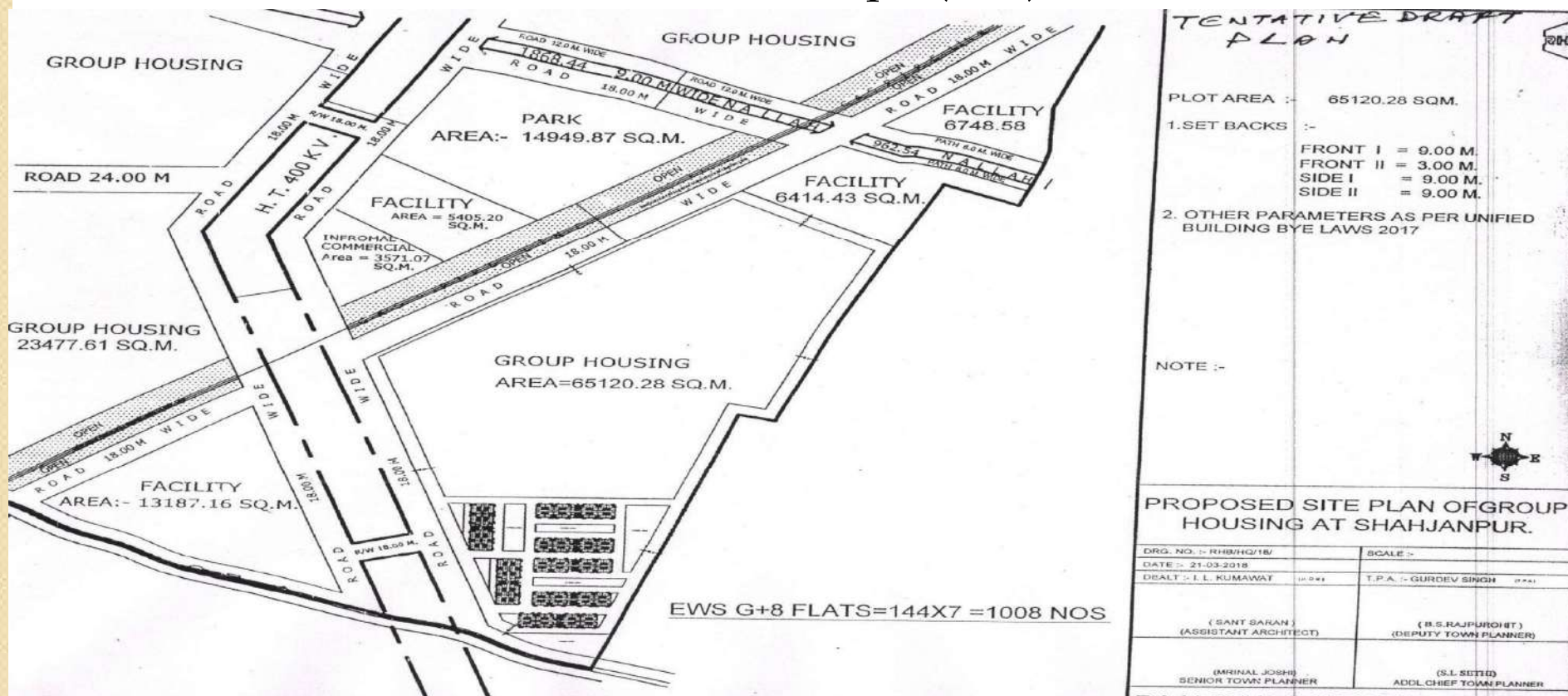

# Project - 33 : Affordable Housing Project by RHB.

- Location - Mahala, Jaipur
- Implementing Agency - Rajasthan Housing Board (RHB)
- Total Land Area - 4.20 Hac. (Govt. Land)
- No of Units - EWS - 528 units  
LIG - 0 units  
Total - 528 units
- Supper Built up area / price - 350.00 Sqft. (EWS) @ 1320/- Rs. 4.62 Lacs.  
- 500.00 Sqft. (LIG) @ 1320/- Rs. 6.60 Lacs.

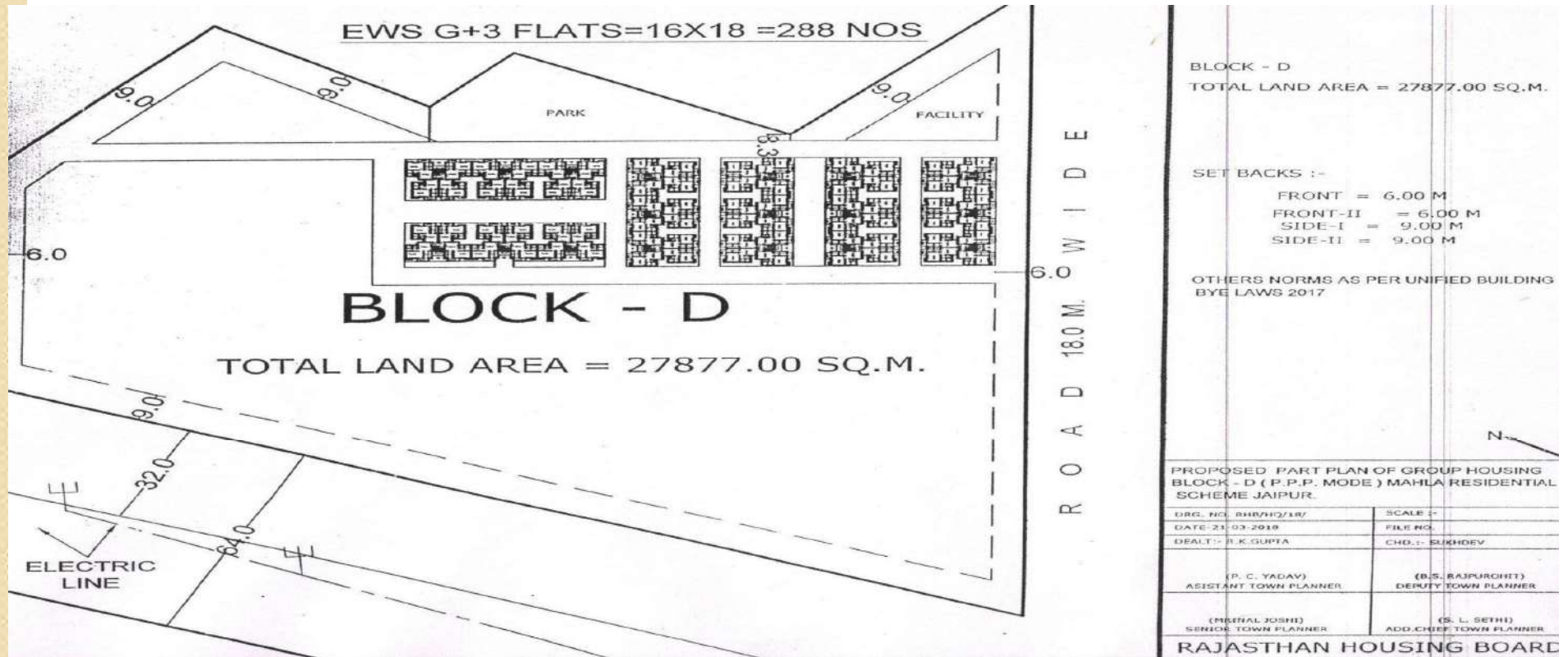

## Project – 34 : Affordable Housing Project by RHB.

” Location – Vatika, Jaipur

” Implementing Agency – Rajasthan Housing Board (RHB)

” Total Land Area – 14.42 Hac. (Govt. Land)

” No of Units – EWS – 1440 units

LIG – 0 units

Total – 1440 units

” Supper Built up area / price – 350.00 Sqft. (EWS) @ 1320/- Rs. 4.62 Lacs.

- 500.00 Sqft. (LIG) @ 1320/- Rs. 6.60 Lacs.

# Project - 35 : Affordable Housing Project by RHB.

- " Location - VT Road Mansarovar, Jaipur
- " Implementing Agency - Rajasthan Housing Board (RHB)
- " Total Land Area - 0.68 Hac. (Govt. Land)
- " No of Units - EWS - 144 units  
LIG - 0 units  
Total - 144 units
- " Supper Built up area / price - 350.00 Sqft. (EWS) @ 1320/- Rs. 4.62 Lacs.  
- 500.00 Sqft. (LIG) @ 1320/- Rs. 6.60 Lacs.

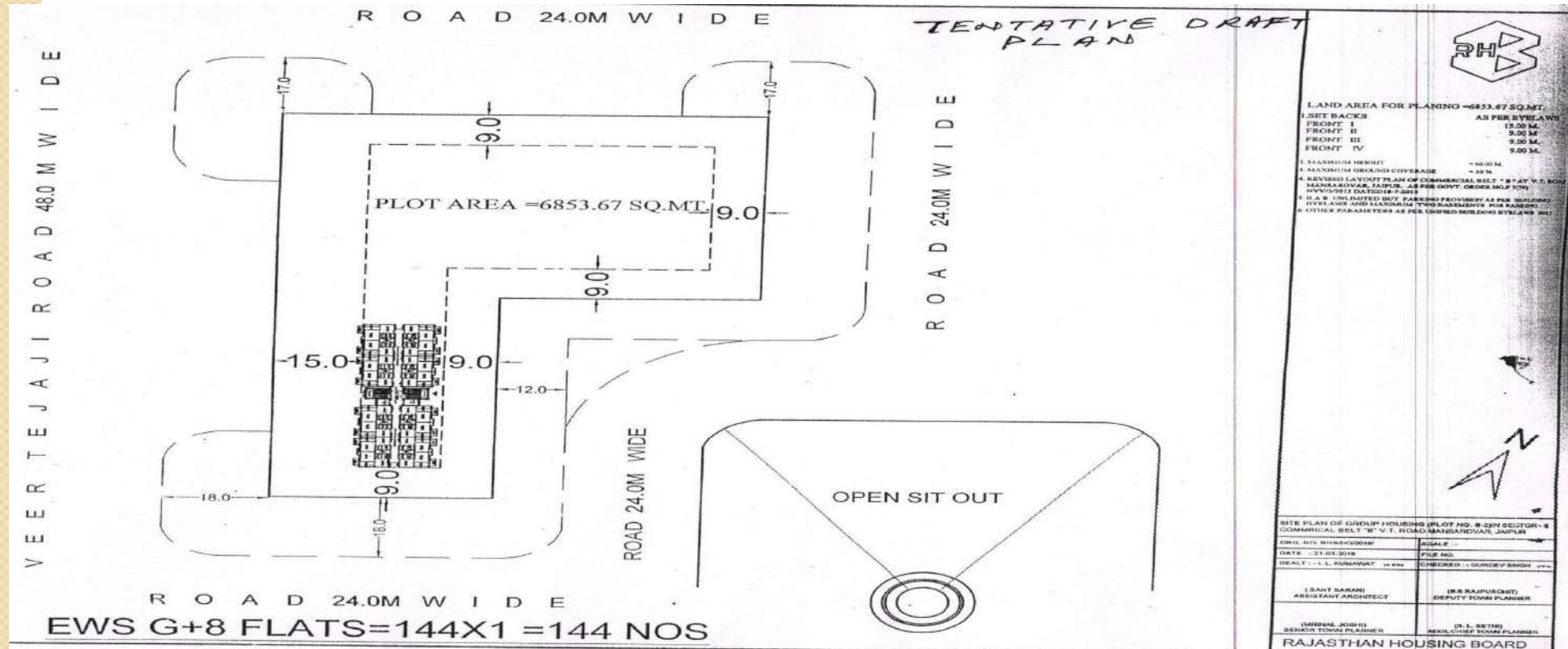

# Project - 36 : Affordable Housing Project by RHB.

- Location - Sector-16, Mansarovar, Jaipur
- Implementing Agency - Rajasthan Housing Board (RHB)
- Total Land Area - 1.00 Hac. (Govt. Land)
- No of Units - EWS - 144 units  
LIG - 0 units  
Total - 144 units
- Supper Built up area / price - 350.00 Sqft. (EWS) @ 1320/- Rs. 4.62 Lacs.  
- 500.00 Sqft. (LIG) @ 1320/- Rs. 6.60 Lacs.

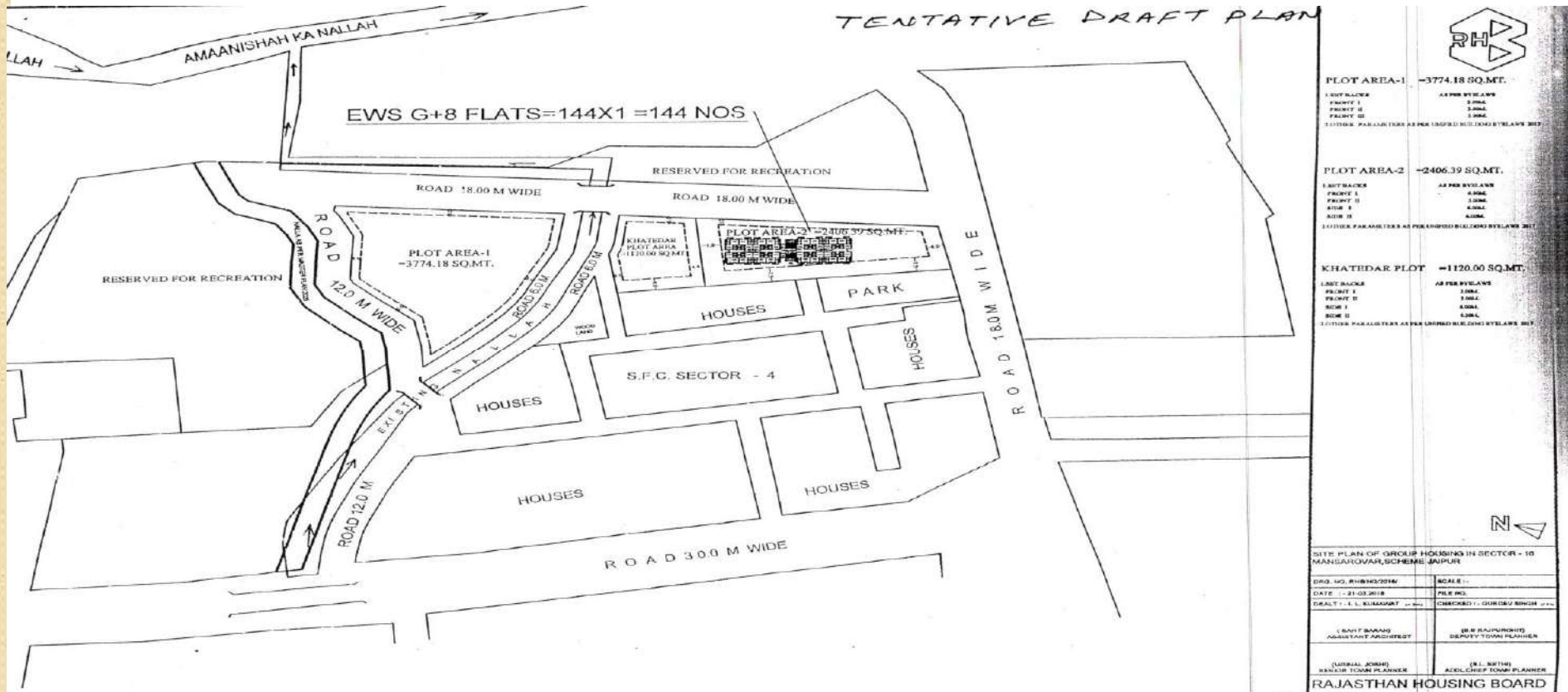



# Project - 37 : Affordable Housing Project by RHB.

- " Location - Aravali Marg, J-1, Mansarovar, Jaipur
- " Implementing Agency - Rajasthan Housing Board (RHB)
- " Total Land Area - 1.50 Hac. (Govt. Land)
- " No of Units - EWS - 288 units  
LIG - 0 units  
Total - 288 units
- " Supper Built up area / price - 350.00 Sqft. (EWS) @ 1320/- Rs. 4.62 Lacs.  
- 500.00 Sqft. (LIG) @ 1320/- Rs. 6.60 Lacs

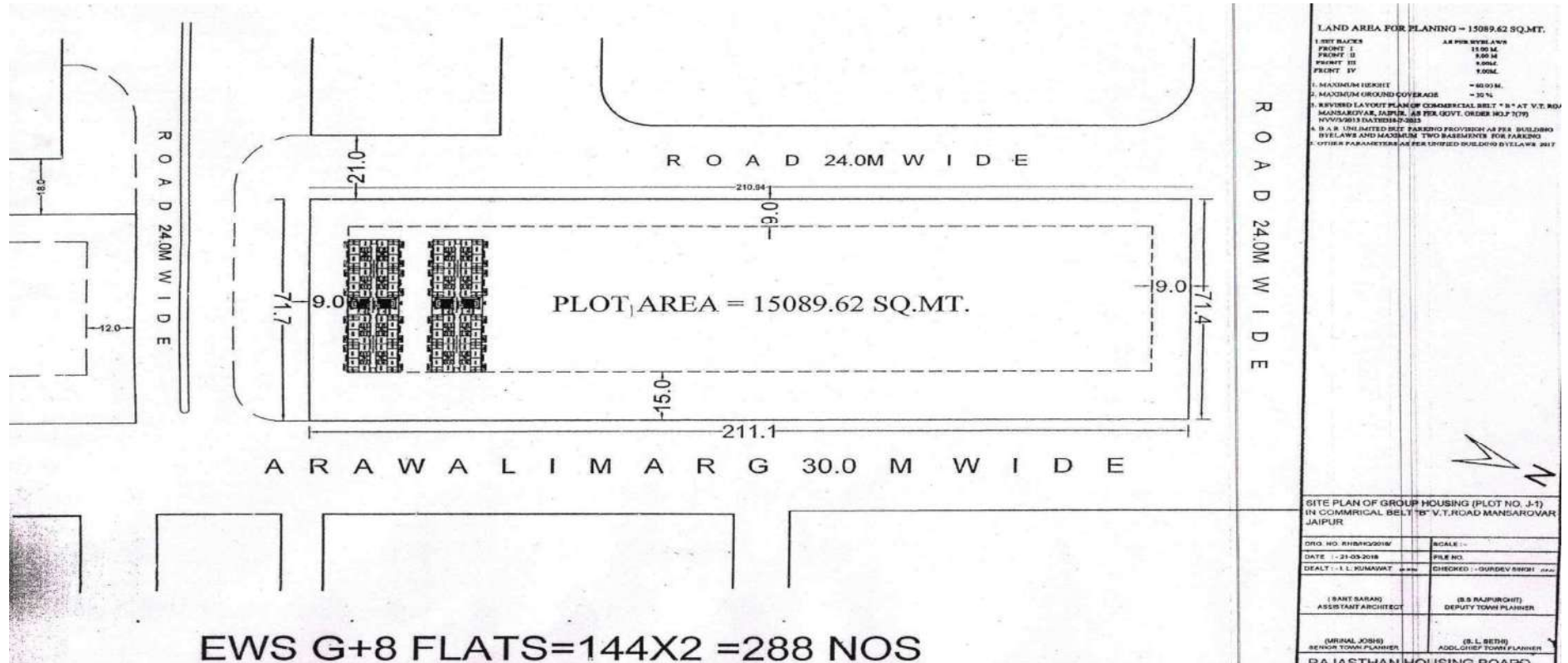

## Projects for Beneficiary Led Construction (BLC) New House

Sr. No.	Name of City	No.of EWS Houses	Total Project Cost	Central Assistance (Rs. 1.5 L)	State Share (Rs. 1.0 L)	Beneficiary Share	ULB Share	1st installment (40%) of Central Assistance
1	Bhilwara	486	2415.42	729.00	0.00	1686.42	0.00	291.60
2	Nathdwara	40	198.80	60.00	0.00	138.80	0.00	24.00
3	Alwar	1273	6326.81	1909.50	0.00	4417.31	0.00	763.80
4	Pratapgarh	73	362.81	109.50	0.00	253.31	0.00	43.80
5	Chittorgarh	1088	5407.36	1632.00	0.00	3775.36	0.00	652.80
6	Nagaur	1679	8344.63	2518.50	0.00	5826.13	0.00	1007.40
7	Sujangarh	1988	9880.36	2982.00	0.00	6898.36	0.00	1192.80
8	Tonk	4395	21843.15	6592.50	0.00	15250.65	0.00	2637.00
9	Udaipur	310	1540.70	465.00	0.00	1075.70	0.00	186.00
10	Sardarshar	1916	9522.52	2874.00	0.00	6648.52	0.00	1149.60
11	Bikaner	1632	8111.04	2448.00	0.00	5663.04	0.00	979.20
12	Makrana	746	3707.62	1119.00	0.00	2588.62	0.00	447.60
13	Churu	218	1108.31	327.00	0.00	781.31	0.00	130.80
14	Bharatpur	431	2142.07	646.50	0.00	1495.57	0.00	258.60
15	Hindaun city	12	59.64	18.00	0.00	41.64	0.00	7.20

## Projects for Beneficiary Led Construction (BLC) New House

Sr. No.	Name of City	No.of EWS Houses	Total Project Cost	Central Assistance (Rs. 1.5 L)	State Share (Rs. 1.0 L)	Beneficiary Share	ULB Share	1st installment (40%) of Central Assistance
16	Bundi	165	820.05	247.50	0.00	572.55	0.00	99.00
17	Rajasmand	8	39.76	12.00	0.00	27.76	0.00	4.80
18	Jhalawar& Jhalarapatan	26	129.22	39.00	0.00	90.22	0.00	15.60
19	Deeg	31	154.07	46.50	0.00	107.57	0.00	18.60
20	Kumher	3	14.91	4.50	0.00	10.41	0.00	1.80
21	Nadwai	69	342.93	103.50	0.00	239.43	0.00	41.40
22	Lalsot	11	54.67	16.50	0.00	38.17	0.00	6.60
23	Dungarpur	2	9.94	3.00	0.00	6.94	0.00	1.20
24	Banswara	192	1451.24	438.00	0.00	1013.24	0.00	175.20
25	Gangapur City	22	73.24	33.00	0.00	40.20	0.00	13.20
26	Chhabra	33	174.53	49.50	0.00	125.03	0.00	19.80
27	Jhalarapatan	7	25.53	10.50	0.00	15.03	0.00	4.20
28	Anta	4	13.03	6.00	0.00	7.03	0.00	2.40
29	Jalore	37	120.25	55.50	0.00	64.75	0.00	22.20
30	Pirawa	9	55.73	13.50	0.00	42.23	0.00	5.40
	<b>Total</b>	<b>16906</b>	<b>84450.3</b>	<b>25516.5</b>	<b>0</b>	<b>58933.8</b>	<b>0</b>	<b>10206.6</b>

## Projects for Beneficiary Led Construction (BLC) Enhancement

Sr. No.	Name of City	No.of EWS Houses	Total Project Cost	Central Assistance (Rs. 1.5 L)	State Share (Rs. 1.0 L)	Beneficiary Share	ULB Share	1st installment (40%) of Central Assistance
1	Nathdwara	136	490.96	204.00	0.00	286.96	0.00	81.60
2	Pushkar	296	747.47	444.00	0.00	303.47	0.00	177.60
3	Beawar	262	643.61	393.00	0.00	250.61	0.00	157.20
4	Bhiwadi	499	1013.95	748.50	0.00	265.45	0.00	299.40
5	Nagaur	2533	6577.72	3799.72	0.00	2778.00	0.00	1519.89
6	Sujangarh	4154	13256.50	6231.00	0.00	7025.50	0.00	2492.40
7	Tonk	2032	5771.76	3048.00	0.00	2723.76	0.00	1219.20
8	Udaipur	437	1370.91	655.50	0.00	715.41	0.00	262.20
9	Sardarshar	4047	13259.72	6070.50	0.00	7189.22	0.00	2428.20
10	Bikaner	3804	11052.64	5706.00	0.00	5346.64	0.00	2282.40
11	Makrana	297	949.07	445.50	0.00	503.57	0.00	178.20
12	Churu	164	549.40	246.00	0.00	303.40	0.00	98.40
13	Bharatpur	2162	5085.94	3243.00	0.00	1842.94	0.00	1297.20
14	Deeg	50	117.00	75.00	0.00	42.00	0.00	30.00
15	Kumher	16	37.44	24.00	0.00	13.44	0.00	9.60
16	Nadwai	183	430.24	274.50	0.00	155.74	0.00	109.80
17	Lalsot	29	67.86	43.50	0.00	24.36	0.00	17.40
	<b>Total</b>	<b>21101</b>	<b>61422.19</b>	<b>31651.72</b>	<b>0.00</b>	<b>29770.47</b>	<b>0.00</b>	<b>12660.69</b>

# Glimpse of AHP Projects under progress

Anganwa, Jodhpur



Balotra (Barmer)

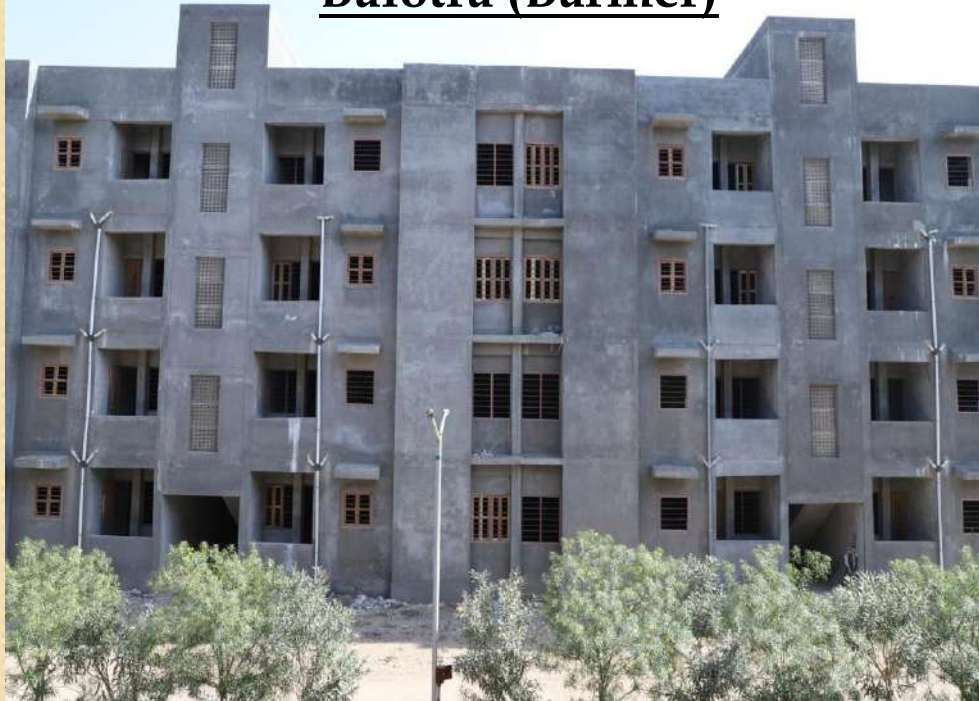

Kishangarh (Ajmer)



Thank  
you!



RUDSICO



CMJAY- 2015